

SKYLINE[®]

ARCHITECTURAL ALUMINIUM

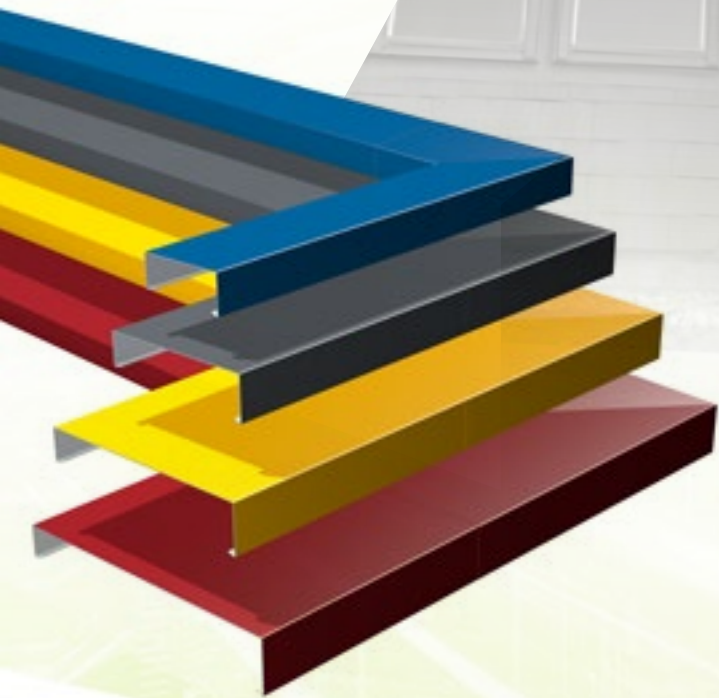

Skyline Sloping Coping

Overview Brochure



Sloping Coping Introduction

Alumasc's Architectural Aluminium brand is synonymous with quality design, innovation and performance. The Skyline Sloping Coping is one of a series of product solutions covering all aspects of the building roofline and facade.

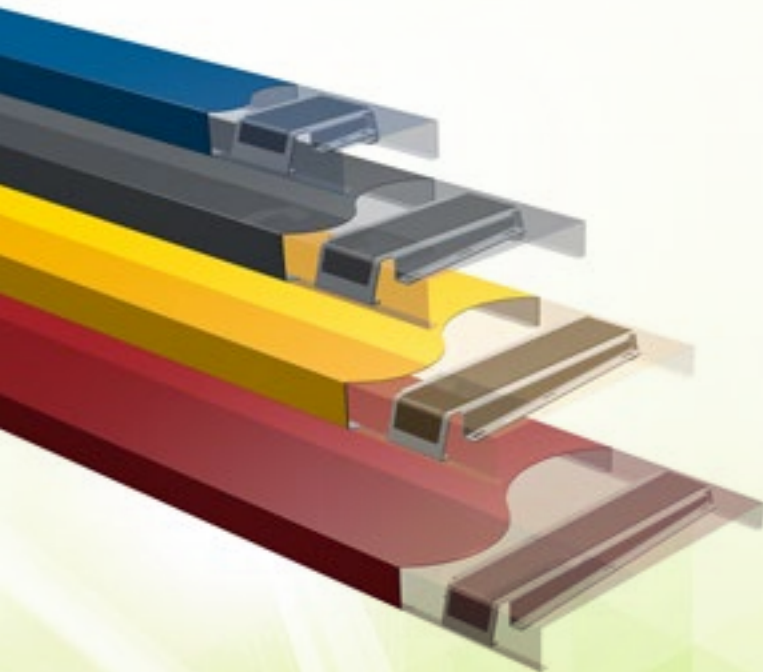

Skyline's market leading range of copings has a proven track record, and become established as the leading system of choice for architects, designers and building owners.

Our copings range has now been expanded to include an sloping coping system that promotes additional water run-off by way of its inclined surface that directs water back onto the roof area.

All Skyline copings employ our trusted bracket fixing system, which has been tested to withstand static wind speed loads of up to 6kN or 220mph.

Available in 30mm incremental coping widths of 182mm up to 1022mm, the sloping coping range provides specifiers and installers with a comprehensive choice of standard widths to suit most applications. And for those troublesome site detailing issues, a fully bespoke service is also available, backed by unparalleled quality and service.

Features & Benefits

The Skyline Sloping Coping range combines durability, functionality and unrivalled flexibility in application. The attractive clean lines of architectural aluminium have an aesthetically pleasing, contemporary quality that will enhance any roofscape, plus a life expectancy of more than 25 years.

Aluminium offers the multiple benefits of light weight, strength and durability; in addition, the innovative fixing mechanism developed by Alumasc gives excellent rigidity. Manufactured in the UK, our copings are available in Alumasc's reliable BBA approved range of polyester powder coatings in 26 factory applied colours from our in-house powder coating facility.

"We can match any BS or RAL colour of your choice"

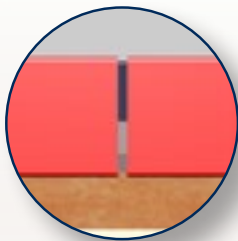

Integrated EPDM bonded seal provides weatherproof seal and allows for expansion and contraction of the joints for building movement and temperature variations



Protects parapet wall and directs water onto the roof area

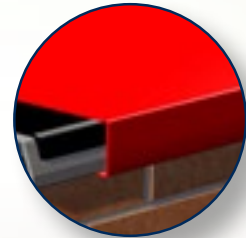

Attractive clean lines

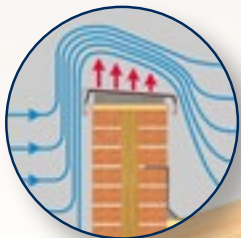

When tested under extreme loads, Skyline Coping System met the required test standard of 6kPa (220mph) under static load conditions

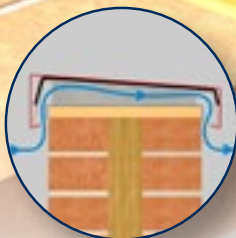

Designed to allow air-flow over the wall area where ventilation of the parapet wall is required

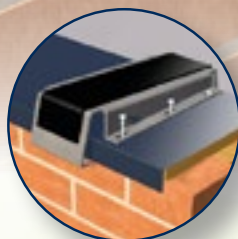

Engineered aluminium bracket with integral fall

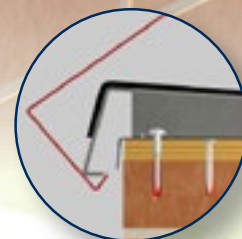

Easy to install Skyline snap-fix system

Product Range

The standard range of sloping copings is available in 30mm increments to cover wall sizes from 91mm to 960mm width (see table below). The standard range of components comprises 3m lengths, angles, stopends, T-junctions and upstands. In addition to the standard range, bespoke fabrication is also available for awkward site detailing.

The Skyline Sloping Coping has a slope of 20mm across its width with an 85mm downstand to the front and 65mm downstand to the rear. Other sizes can be made to order; please contact the Skyline technical team on 01536 383810 for more information.

(Fig:1)

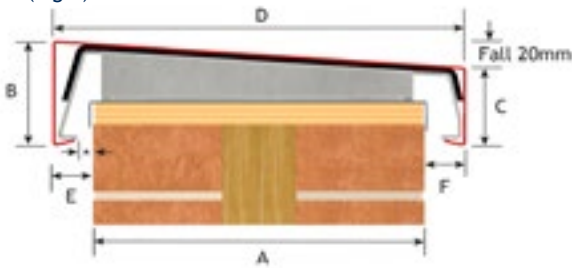

- A - Finished wall width (see note 1)
 - B - Front coping height - 85mm
 - C - Back coping height - 65mm
 - D - Coping width
 - E - Front coping overhang - 31mm recommended
 - F - Rear coping overhang - 31mm recommended
- *Approx 10mm

Note:

Walls should only be measured after all site finishes have been applied i.e rendering, cladding etc and at regular intervals to ensure correct sizing

How to choose your coping size:

1. Determine the finished wall width by measuring **dimension A** (Fig:1)
2. Using the table below, select the corresponding coping width and order code prefix

Example:

For 130mm wall width, choose:

121-150mm wall width = 212mm coping width = SC15 code prefix

Wall width (mm)	Coping Width (mm)	Code Prefix
91-120	182	SC12
121-150	212	SC15
151-180	242	SC18

To order, simply use the prefix code together with the required component suffix code on page 5.

Example 1: 3 Meter Length = SC15/3MPPC

Example 2: 90deg External Angle = SC15/EA90PPC

Sloping Coping Standard Sizes

Wall width (mm)	Coping Width (mm)	Code Prefix	Wall Width (mm)	Coping Width (mm)	Code Prefix
91-120	182	SC12	541-570	632	SC57
121-150	212	SC15	571-600	662	SC60
151-180	242	SC18	601-630	392	SC63
181-210	272	SC21	631-660	722	SC66
211-240	302	SC24	661-690	752	SC69
241-270	332	SC27	691-720	782	SC72
271-300	362	SC30	721-750	812	SC75
301-330	392	SC33	751-780	842	SC78
331-360	422	SC36	781-810	872	SC81
361-390	452	SC39	811-840	902	SC84
391-420	482	SC42	841-870	932	SC87
421-450	512	SC45	871-900	962	SC90
451-480	542	SC48	901-930	992	SC93
481-510	572	SC51	931-960	1022	SC96
511-540	602	SC54			

SC12 to SL42 Copings are manufactured from 2mm aluminium, SC45 to SC96 Copings are manufactured from 3mm aluminium.

3m Length



Code Suffix	
/3MPPC	

Product notes

- Order using the prefix code from Page 4 together with the item suffix code – for example, SC27/3MPPC
- When ordering please specify RAL colour (see page 6)
- 3m lengths supplied complete with fixing strap at: 1.5m centres up to SC42; 1m centres up to SC75; 750mm centres up to SC96.

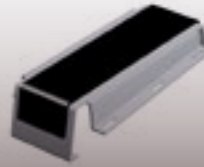

- All fittings supplied complete with fixing strap
- Additional fixing straps available to order using suffix code /FSPPC

90 Angles



Code Suffix	
External	Internal
/EA90PPC	/IA90PPC

135 Angles



Code Suffix	
External	Internal
/EA135PPC	/IA135PPC

Stop Ends



Code Suffix	
Left Hand	Right Hand
/LHCS90PPC	/RHCSPPC

Upstands



Code Suffix	
Left Hand	Right Hand
/LHUSPPC	/RHUSPPC

Tee Junctions



Code Suffix	
Left Hand	Right Hand
/LHTJPPC	/RHTJPPC

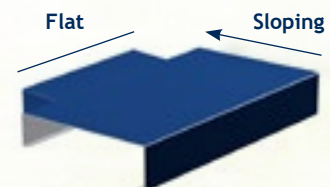

Code Suffix	
Sloping to Flat	
/FLTJPPC	

Colours

Alumasc's Skyline products are available in plain mill finish or polyester powder coated from the BBA approved Raincote range.

The standard aluminium RAL colour range includes a choice of 29 colours. We have our own state-of-the-art powder coating plant in house, and can offer any additional BS or RAL colour to order.



“We can match any BS or RAL colour of your choice”

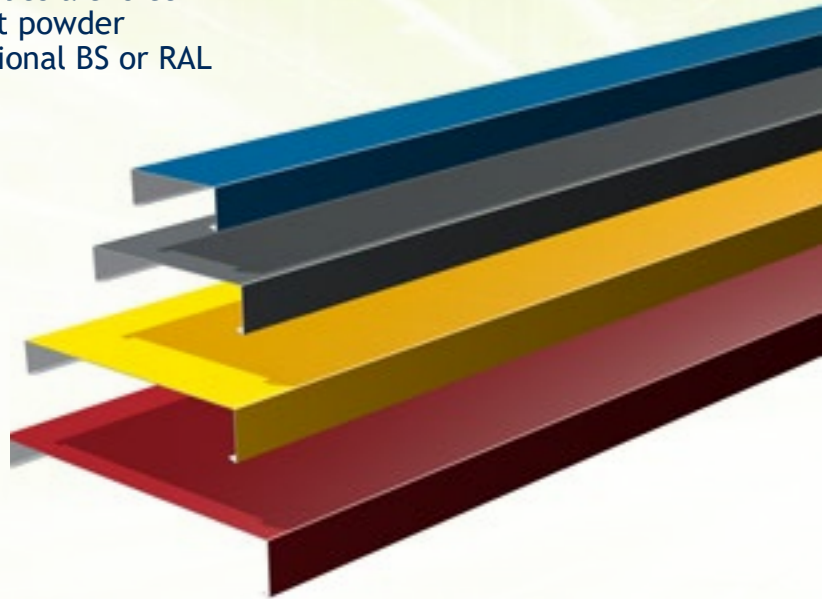

Standard Colours

Colours are produced with a 30% gloss unless otherwise stated.

RAL 1013M Pearl White Matt 	RAL 1035MET Pearl Beige Metallic 	RAL 3012M Beige Red Matt 	RAL 6005M Moss Green Matt 
RAL 7002M Olive Grey Matt 	RAL 7004M Signal Grey Matt 	RAL 7005M Mouse Grey Matt 	RAL 7006M Beige Grey Matt 
RAL 7012M Basalt Grey Matt* 	RAL 7015M Slate Grey Matt* 	RAL 7016M Anthracite Grey Matt* 	RAL 7021M Black Grey Matt 
RAL 7022M Umbra Grey Matt 	RAL 7024M Graphite Grey Matt 	RAL 7032M Pebble Grey Matt 	RAL 7035M Light Grey Matt 
RAL 7037M Dusty Grey Matt* 	RAL 7038M Agate Grey Matt 	RAL 7040M Window Grey Matt 	RAL 8014M Sepia Brown Matt 
RAL 8017M Chocolate Brown Matt 	RAL 8019M Grey Brown Matt 	RAL 9005M Jet Black Matt 	RAL 9006M Metallic Silver Matt 
RAL 9010M Pure White Matt 	RAL 9016M Traffic White Matt 	RAL 9016M/TXT White Matt Textured 	RAL 9017M Black Matt (60% Gloss) 
BLACK/TXT Black Textured 	* Also Available in a textured finish		

Colours are reproduced for general guidance only. For exact colour and finish references, please contact Alumasc for colour swatch samples and for further information.

Quality & Values



Quality

Combining proven materials, advanced manufacturing, a skilled workforce and more than 50 years of industry experience, Skyline delivers superior quality and innovation.

Skyline Sloping Copings are manufactured from high quality 2mm thick aluminium sheet.

Our in-house BBA approved powder coating facility plays an integral part in our quality assurance procedure, which enables strict control of our finishing process. The BBA approved polyester powder coating system is available in 29 standard colours, with any BS or RAL colour available to order.



Fire Regulations

Fire rating is a critical factor today. Solid aluminium sheet is classified as non combustible. Powder coated aluminium, Interpon D1000 series and D2000 series have been tested to BS476, parts 6 & 7 and have been deemed to have met the criteria for class 0 building regulation approval.



SKYLINE[®]

ARCHITECTURAL ALUMINIUM

www.alumascwms.co.uk

AWMS - BURTON LATIMER

Station Road
Burton Latimer
Kettering
Northamptonshire
NN15 5JP

+44 (0)1536 383 810
info@alumascwms.co.uk



ALUMASC[®]

WATER MANAGEMENT SOLUTIONS



www.alumascwms.co.uk