



# SELF

## SYSTEM

**Interior streets, gardens, recreational areas, squares, parks...**

Multipurpose, constant height channels (without slope), very practical in short drain stretches or with frequent outlets.

Available with various grating locking systems (quick system, locking bars, with screws), all types of grating materials up to load class C250.

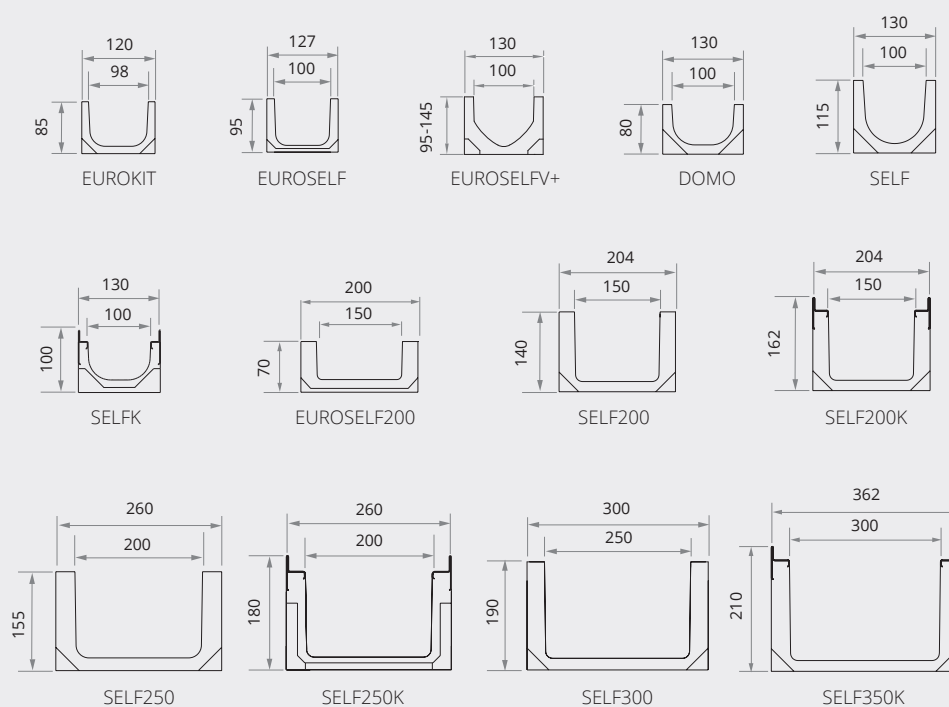

Load Class  
up to A15  
EN-1433 Standard

# EUROKIT



ULMA Linear Drainage Channel type EUROKIT: External width 120 mm; Internal width 98 mm and overall height 85 mm to collect rainwater in 1 metre long units. Locking system "click" type without screws.

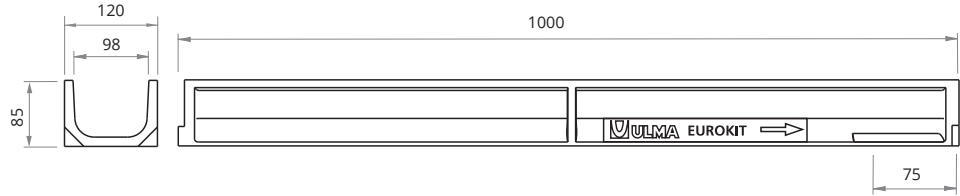

## CHANNEL

Code Channel	L mm	H mm	Width mm		Ø Outlet* mm		Hydraul. Section cm²	Pcs. pallet with grating	Weight Kg	Qref l/s
			Ext.	Int.	Vert.	Hor.				
EUROKIT	1000	85	120	98	110	-	66,5	108	6,4	1,98

\* Vertical outlets on order

## GRATING

Slotted



Material	Design	Load	Code	L mm	Width mm	Thickness mm	Opening mm	Weight Kg	Intake area cm²/ml
GALVANISED STEEL	SLOTTED	A15	GNS100UOA	1000	120	3	7	1,4	213

## HOW TO FIX

Click locking system

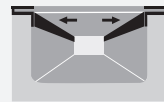

Code	Units ml
(1)	(1)

(1) Click. Without screws.

## OPEN END CAP

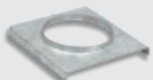
Code	Ø mm	
TEUROKITA	60	

## CLOSED END CAP

Code	
TEUROKITC	



Load Class  
up to C250  
EN-1433 Standard

# EUROSELF



ULMA Linear Drainage Channel type EUROSELF: External width 127 mm; Internal width 100 mm and overall height 95 mm to collect rainwater in 1 metre long units. Locking system consist of locking bar and screws.

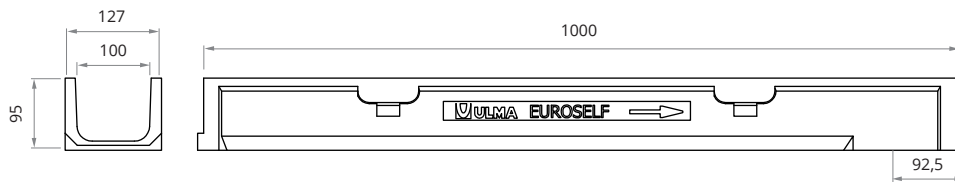

## CHANNEL

Code Channel	L mm	H mm	Width mm		Ø Outlet* mm		Hydraul. Section cm <sup>2</sup>	Pcs. pallet	Weight Kg	Qref l/s
			Ext.	Int.	Vert.	Hor.				
EUROSELF	1000	95	127	100	110	-	80	120	6,9	2,7

\* Vertical outlets on order

## GRATINGS

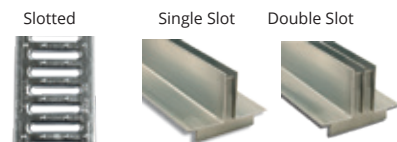

Material	Design	Load	Code	L mm	Width mm	Thickness mm	Opening mm	Weight Kg	Intake area cm <sup>2</sup> /ml
GALVANISED STEEL	SLOTTED*	A15	GN100UCA	1000	130	3	8	1,1	268
	SINGLE SLOT*	C250	GR100UOC	1000	130	70	15	4,8	150
	DOUBLE SLOT*	C250	GDR100UOC	1000	130	70	2 x 12	5,5	240

\* Available in stainless steel, consult design

## HOW TO FIX

Click locking system



Code	Units ml
(1)	(1)
(2)	(2)
(2)	(2)

(1) Click. Without screws.  
(2) Supported

## SUMP UNITS

Code	L mm	H mm	Width mm	Lateral outlets Ø mm	Front outlet Ø mm	Sump units	Weight Kg
AEURO100	500	300	130	90/110	90	1	14,4

## BUCKET

Code
CEURO100

## OPEN END CAP

Code	Ø mm
TEURO100A	90

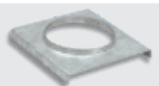

## CLOSED END CAP

Code
TEURO100C

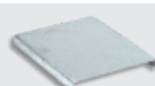

Load Class  
up to C250  
EN-1433 Standard

# EUROSELFV+



ULMA Linear Drainage Channel, type EUROSELFV+; External width 130 mm, Internal width 100 mm; Available with overall heights between 95 mm and 145 mm, to collect rainwater in 1 meter long units, optimized V-shape with self-cleaning effect; especially designed for channel runs with no longitudinal slope. Locking system consist of locking bar and screws.

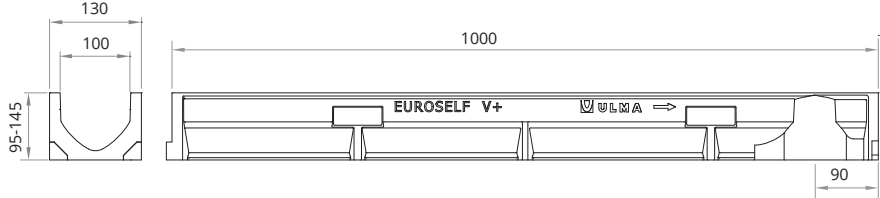

## CHANNELS

Code Channel	L mm	H mm	Width mm		Ø Outlet* mm		Hydraul. Section cm <sup>2</sup>	Pcs. pallet	Weight Kg	Qref l/s
			Ext.	Int.	Vert.	Hor.				
EUROSELFV+ H95	1000	95	130	100	110	-	66	120	7,3	2,0
EUROSELFV+ H125	1000	125	130	100	110	-	95	105	8,7	3,5
EUROSELFV+ H145	1000	145	130	100	110	-	114	90	9,7	4,7

\* Vertical outlets on order

## GRATINGS

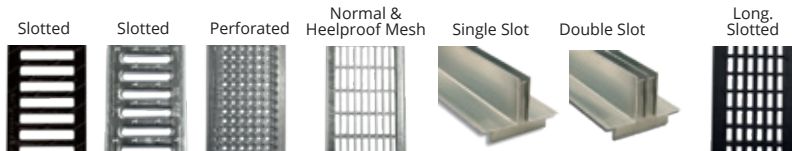

Material	Design	Load	Code	L mm	Width mm	Thickness mm	Opening mm	Weight Kg	Intake area cm <sup>2</sup> /ml
DUCTILE IRON	SLOTTED	B125	FNX100UCBM	500	130	6	14,9	2,1	530
	SLOTTED	C250	FNX100UCCM	500	130	6	13	2,7	435
GALVANISED STEEL	SLOTTED	A15	GN100UCA	1000	130	3	9	1,6	268
	PERFORATED	A15	GP100UCA	1000	130	3	Ø6	1,4	159
	MESH*	B125	GEX100UCB33	1000	130	2	30 x 30	3,2	837
	HEELPROOF MESH*	B125	GEHX100UCB	1000	130	2	30 x 10	3,9	749
	SLOT*	C250	GR100UOC	1000	130	70	15	4,8	150
	DOUBLE SLOT*	C250	GDR100UOC	1000	130	70	2 x 12	5,5	240
STAINLESS STEEL	SLOTTED	A15	IN100UCA	1000	130	3	7	1,5	218
	PERFORATED	A15	IP100UCA	1000	130	3	Ø6	1,7	651
COMPOSITE	LONG. SLOTTED BLACK	A15	PNLH100UCAM	500	130	3	8	0,3	367
	LONG. SLOTTED GREY	A15	PNLH100UCAM GRIS	500	130	3	8	0,3	367

\* Available in stainless steel, consult design

## HOW TO FIX

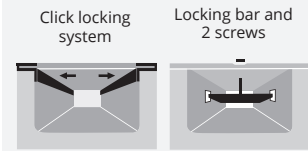

Code	Units ml
TEF840 + CS100	2 + 2
TEF840 + CS100	2 + 2
(1) TNPC850 + CS100	2 + 2
TNPC850 + CS100	2 + 2
TEF840 + CS100	2 + 2
TEF840 + CS100	2 + 2
(2)	(2)
(2)	(2)
TXNPC850 + CS100INOX	2 + 2
TXNPC850 + CS100INOX	2 + 2
(1) TXE840 + CS100INOX	2 + 2
(1) TXE840 + CS100INOX	2 + 2

(1) Click. Without screws.  
(2) Supported

## SUMP UNITS

Code	L mm	H mm	Width mm	Lateral outlets Ø mm	Front outlet Ø mm	Sump units	Weight Kg
AEURO100	500	300	130	90/110	90	1	14,4

## BUCKET

Code
CEURO100

## OPEN END CAP

Code	Ø mm
TEURO100VH95A	90
TEURO100VH125A	90
TEURO100VH145A	110

## CLOSED END CAP

Code
TEURO100VH95C
TEURO100VH125C
TEURO100VH145C

Load Class  
up to C250  
EN-1433 Standard

# DOMO



ULMA Linear Drainage Channel type DOMO: External width 130 mm; Internal width 100 mm and overall height 80 mm to collect rainwater in 1 metre long units. The locking system consists of 2 screws per metre.

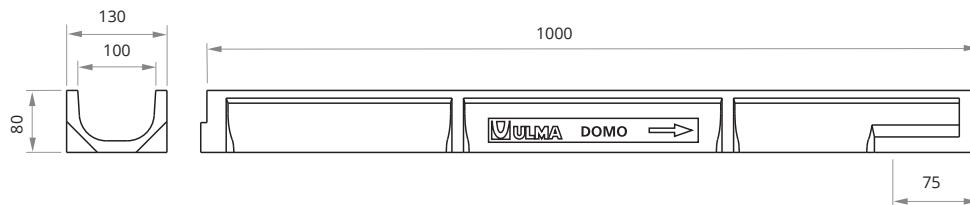

## CHANNEL

Code Channel	L mm	H mm	Width mm		Ø Outlet* mm		Hydraul. Section cm <sup>2</sup>	Pcs. pallet	Weight Kg	Qref l/s
			Ext.	Int.	Vert.	Hor.				
DOMO	1000	80	130	100	110	-	60	120	6,9	1,67

\* Vertical outlets on order

## GRATINGS

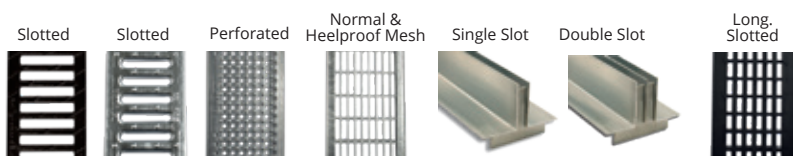

## HOW TO FIX

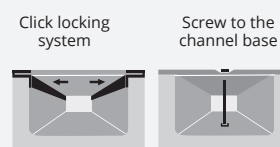

Material	Design	Load	Code	L mm	Width mm	Thickness mm	Opening mm	Weight Kg	Intake area cm <sup>2</sup> /ml	Code	Units ml
DUCTILE IRON	SLOTTED	B125	FNX100UCBM	500	130	6	14,9	2,1	530	TEF870	2
	SLOTTED	C250	FNX100UCCM	500	130	6	13	2,7	435	TEF870	2
GALVANISED STEEL	SLOTTED	A15	GN100UCA	1000	130	3	9	1,6	268	(1) TNPC875	2
	PERFORATED	A15	GP100UCA	1000	130	3	Ø6	1,4	159	TNPC875	2
	MESH*	B125	GEX100UCB33	1000	130	2	30 x 30	3,2	837	TEF860	2
	HEELPROOF MESH*	B125	GEHX100UCB	1000	130	2	30 x 10	3,9	749	TEF860	2
	SLOT*	C250	GR100UOC	1000	130	70	15	4,8	150	(2)	(2)
	DOUBLE SLOT*	C250	GDR100UOC	1000	130	70	2 x 12	5,5	240	(2)	(2)
STAINLESS STEEL	SLOTTED	A15	IN100UCA	1000	130	3	7	1,5	218	TXNPC875	2
	PERFORATED	A15	IP100UCA	1000	130	3	Ø6	1,7	651	TXNPC875	2
COMPOSITE	LONG. SLOTTED BLACK	A15	PNLH100UCAM	500	130	3	8	0,3	367	(1) TXNPC870	2
	LONG. SLOTTED GREY	A15	PNLH100UCAM GRIS	500	130	3	8	0,3	367	(1) TXNPC870	2

\* Available in stainless steel, consult design

(1) Click. Without screws.  
(2) Supported

## SUMP UNITS

Code	L mm	H mm	Width mm	Lateral outlets Ø mm	Front outlet Ø mm	Sump units	Weight Kg
AEURO100	500	300	130	90/110	90	1	14,4

## BUCKET

Code
CEURO100

## CLOSED END CAP

Code
TDOMO100C

Load Class  
up to C250  
EN-1433 Standard

# SELF



ULMA Linear Drainage Channel type SELF: External width 130 mm; Internal width 100 mm and overall height 115 mm to collect rainwater in 1 metre long units. Locking system consists of locking bar CS100 and screws.

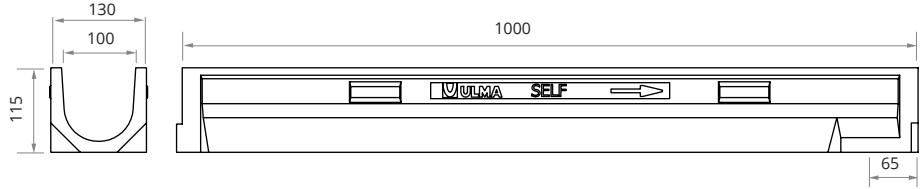

## CHANNEL

Code Channel	L mm	H mm	Width mm		Ø Outlet* mm		Hydraul. Section cm <sup>2</sup>	Pcs. pallet	Weight Kg	Qref l/s
			Ext.	Int.	Vert.	Hor.				
SELF	1000	115	130	100	110	-	85	105	8,4	3,0

\* Vertical outlets on order

## GRATINGS

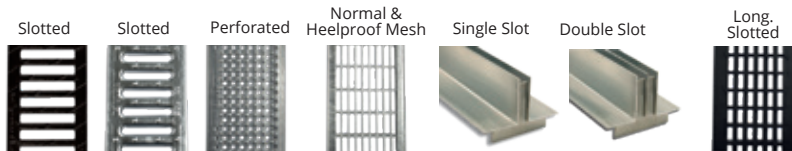

Material	Design	Load	Code	L mm	Width mm	Thickness mm	Opening mm	Weight Kg	Intake area cm <sup>2</sup> /ml
DUCTILE IRON	SLOTTED	B125	FNX100UCBM	500	130	6	14,9	2,1	530
	SLOTTED	C250	FNX100UCCM	500	130	6	13	2,7	435
GALVANISED STEEL	SLOTTED	A15	GN100UCA	1000	130	3	9	1,6	268
	PERFORATED	A15	GP100UCA	1000	130	3	Ø6	1,4	159
	MESH*	B125	GEX100UCB33	1000	130	2	30 x 30	3,2	837
	HEELPROOF MESH*	B125	GEHX100UCB	1000	130	2	30 x 10	3,9	749
	SLOT*	C250	GR100UOC	1000	130	70	15	4,8	150
	DOUBLE SLOT*	C250	GDR100UOC	1000	130	70	2 x 12	5,5	240
STAINLESS STEEL	SLOTTED	A15	IN100UCA	1000	130	3	7	1,5	218
	PERFORATED	A15	IP100UCA	1000	130	3	Ø6	1,7	651
COMPOSITE	LONG. SLOTTED BLACK	A15	PNLH100UCAM	500	130	3	8	0,3	367
	LONG. SLOTTED GREY	A15	PNLH100UCAM-GRIS	500	130	3	8	0,3	367

\* Available in stainless steel, consult design

## HOW TO FIX

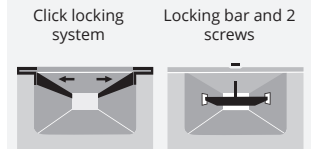

Code	Units ml
TEF840 + CS100	2 + 2
TEF840 + CS100	2 + 2
(1) TNPC850 + CS100	2 + 2
TNPC850 + CS100	2 + 2
TEF840 + CS100	2 + 2
TEF840 + CS100	2 + 2
(2)	(2)
(2)	(2)
TXNPC850 + CS100INOX	2 + 2
TXNPC850 + CS100INOX	2 + 2
(1) TXE840 + CS100INOX	2 + 2
(1) TXE840 + CS100INOX	2 + 2

(1) Click. Without screws.

(2) Supported

## SUMP UNITS

Code	L mm	H mm	Width mm	Lateral outlets Ø mm	Front outlet Ø mm	Sump units	Weight Kg
AEURO100	500	300	130	90/110	90	1	14,4

## BUCKET

Code
CEURO100

## OPEN END CAP

Code	Ø mm
TSELF100A	90

## CLOSED END CAP

Code
TSELF100C

Load Class  
up to C250  
EN-1433 Standard

# SELFK



ULMA Linear Drainage Channel type SELFK: External width 130 mm; Internal width 100 mm and overall height 100 mm to collect rainwater in 1 metre long units. Integrated galvanised steel\* edges for lateral protection. Locking system consists of 2 screws per metre.

\*Also available with stainless steel edge protection

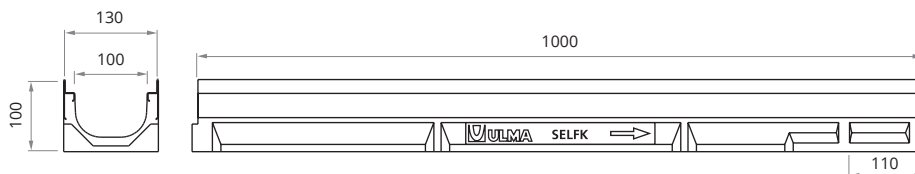
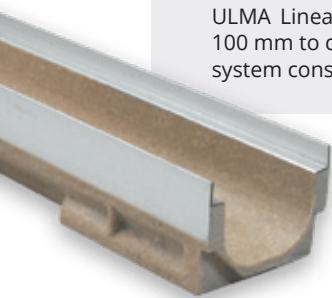

## CHANNEL

Code Channel	L mm	H mm	Width mm		Ø Outlet* mm		Hydraul. Section cm <sup>2</sup>	Pcs. pallet	Weight Kg	Qref l/s
			Ext.	Int.	Vert.	Hor.				
SELFK	1000	100	130	100	110	-	53	105	11,1	1,5

\* Vertical outlets on order

## GRATINGS

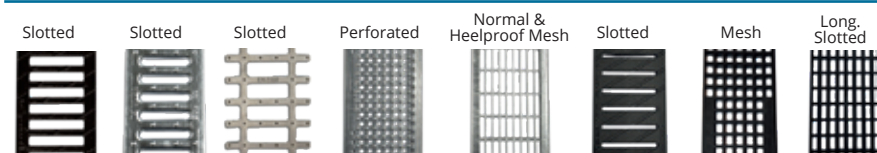

Material	Design	Load	Code	L mm	Width mm	Opening mm	Weight Kg	Intake area cm <sup>2</sup> /ml	HOW TO FIX	
									Code	Units ml
DUCTILE IRON	SLOTTED	B125	FNX100KCBM	500	123	14	2,7	476	TEF880	2
	SLOTTED	C250	FNX100KCCM	500	123	14	2,9	486	TEF880	2
	HEELPROOF SLOTTED	C250	FNHX100KCCM	500	123	5	3,7	174	TEF880	2
STAINLESS DUCTILE IRON	SLOTTED	D400	FIN100KCDM	500	123	19,9	3,5	695	TXE880	2
GALVANISED STEEL	PERFORATED	A15	GP100KCA	1000	123	Ø6	1,1	158	TNPC890	2
	SLOTTED	A15	GN100KCA	1000	123	9	1,6	282	TNPC890	2
	MESH*	B125	GEX100KCB	1000	123	30 x 20	3,3	823	TEF880	2
	HEELPROOF MESH *	B125	GEHX100KCB	1000	123	30 x 10	4,0	743	TEF880	2
STAINLESS STEEL	SLOTTED	A15	IN100KCA	1000	123	7	1,4	216	TXNPC890	2
	PERFORATED	A15	IP100KCA	1000	123	Ø6	1,2	651	TXNPC890	2
COMPOSITE	HEELPROOF SLOTTED BLACK	A15	PNH100KCAM	500	123	5	0,6	159	TXE880	2
	HEELPROOF SLOTTED GRAY	A15	PNH100KCAM-GRIS	500	123	5	0,6	159	TXE880	2
	LONG.SLOTTED BLACK	A15	PNLH100KCAM	500	123	8	0,3	484	TXE880	2
	LONG.SLOTTED GRAY	A15	PNLH100KCAM-GRIS	500	123	8	0,3	484	TXE880	2
	MESH	B125	PE100KCBM	500	123	14 x 12,5	0,5	553	TXE880	2

\* Available in stainless steel, consult design

## HOW TO FIX

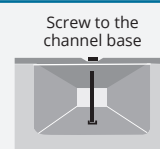

## SUMP UNITS

Code	L mm	H mm	Width mm	Lateral outlets Ø mm	Front outlet Ø mm	Sump units	Weight Kg
AEURO100K	500	318	130	90/110	90	1	15,2

## BUCKET

Code
CEURO100

## CLOSED END CAP

Code
TSELF100KC





Load Class up to C250  
EN-1433 Standard

# EUROSELF200



ULMA Linear Drainage Channel type EUROSELF200: External width 200 mm; Internal width 150 mm and overall height 70 mm to collect rainwater in 1 metre long units. Locking system consists of 2 screws per metre.

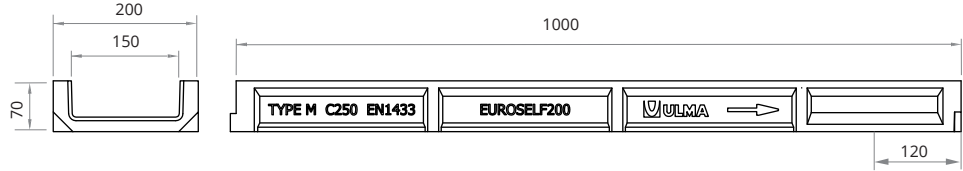

## CHANNEL

Code Channel	L mm	H mm	Width mm		Ø Outlet* mm		Hydraul. Section cm²	Pcs. pallet	Weight Kg	Qref l/s
			Ext.	Int.	Vert.	Hor.				
EUROSELF200	1000	70	200	150	160	-	75	81	12,0	1,9

\* Vertical outlets on order

## GRATINGS

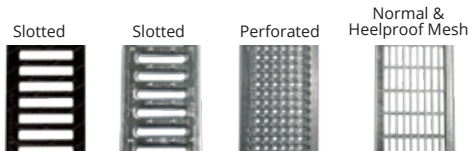

Material	Design	Load	Code	L mm	Width mm	Thickness mm	Opening mm	Weight Kg	Intake area cm²/ml
DUCTILE IRON	SLOTTED	B125	FNX150UCBM	500	200	6	13,75	4,0	683
	SLOTTED	C250	FNX150UCCM	500	200	5	13,75	4,4	683
GALVANISED STEEL	SLOTTED*	A15	GN150UCA	1000	200	3	8	3,4	392
	PERFORATED	A15	GP150UCA	1000	200	3	Ø5	4,2	196
	MESH*	B125	GEX150UCB33	1000	200	2	30 x 30	5,0	1254
	HEELPROOF MESH*	B125	GEHX150UCB	1000	200	2	30 x 10	6,2	1116
STAINLESS STEEL	PERFORATED	A15	IP150UCA	1000	200	3	Ø5	4,4	643

\* Available in stainless steel, consult design

## HOW TO FIX

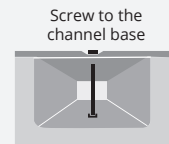

Code	Units ml
TEF850	2
TEF850	2
(1) TNPC860	2
TNPC860	2
TEF850	2
TEF850	2
TXNPC850	2

(1) Click. Without screws.

## CLOSED END CAP

Code
TEUROSELF200C



Load Class  
up to C250  
EN-1433 Standard

# SELF200



ULMA Linear Drainage Channel type SELF200: External width 204 mm; Internal width 150 mm and overall height 140 mm to collect rainwater in 1 metre long units. Locking system consists of locking bar CS150 and screws.

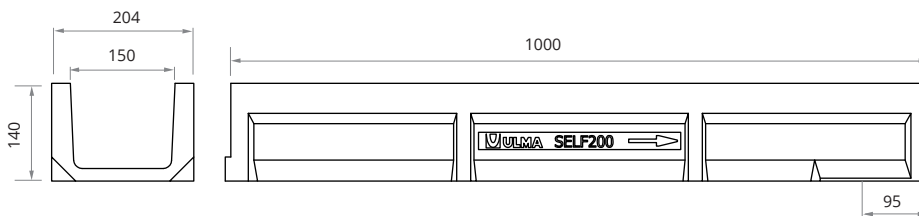

## CHANNEL

Code Channel	L mm	H mm	Width mm		Ø Outlet* mm		Hydraul. Section cm <sup>2</sup>	Pcs. pallet	Weight Kg	Qref l/s
			Ext.	Int.	Vert.	Hor.				
SELF200	1000	140	204	150	160	-	180	54	16,2	7,6

\* Vertical outlets on order

## GRATINGS

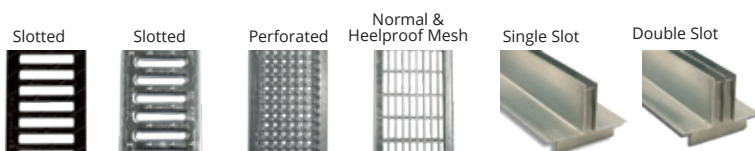

Material	Design	Load	Code	L mm	Width mm	Thickness mm	Opening mm	Weight Kg	Intake area cm <sup>2</sup> /ml
DUCTILE IRON	SLOTTED	B125	FNX150UCBM	500	200	6	13,75	4,0	683
	SLOTTED	C250	FNX150UCCM	500	200	5	13,75	4,4	683
GALVANISED STEEL	SLOTTED*	A15	GN150UCA	1000	200	3	8	3,4	392
	PERFORATED	A15	GP150UCA	1000	200	3	Ø5	4,2	196
	MESH*	B125	GEX150UCB33	1000	200	2	30 x 30	5,0	1254
	HEELPROOF MESH *	B125	GEHX150UCB	1000	200	2	30 x 10	6,2	1116
	SLOT*	C250	GR150UOC	1000	200	70	15	6,2	150
	DOUBLE SLOT*	C250	GDR150UOC	1000	200	70	2 x 12	7,0	240
STAINLESS STEEL	PERFORATED	A15	IP150UCA	1000	200	3	Ø5	4,4	643

\* Available in stainless steel, consult design

## HOW TO FIX

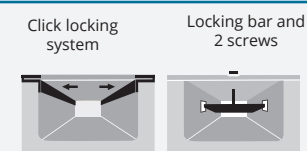

Code	Units ml
TEF850 + CS150	2 + 2
TEF850 + CS150	2 + 2
(1) TNPC860 + CS150	2 + 2
TNPC860 + CS150	2 + 2
TEF850 + CS150	2 + 2
TEF850 + CS150	2 + 2
(1)	(1)
(1)	(1)
TXNPC850 + CS150INOX	2 + 2

(1) Click. Without screws.

## SUMP UNITS

Code	L mm	H mm	Width mm	Lateral outlets Ø mm	Front outlet Ø mm	Sump units	Weight Kg
ASELF200	500	378	204	160/200	160	1	27,7

## BUCKET

Code
CSELF200

## OPEN END CAP

Code	Ø mm
TSELF200A	110

## CLOSED END CAP

Code
TSELF200C

Load Class  
up to C250  
EN-1433 Standard

# SELF200K



ULMA Linear Drainage Channel type SELF200K: External width 204 mm; Internal width 150 mm and overall height 162 mm to collect rainwater in 1 metre long units. Integrated galvanised steel\* edges for lateral protection. Locking system consists of locking bar CS150 and screws.

\*Also available with stainless steel edge protection.

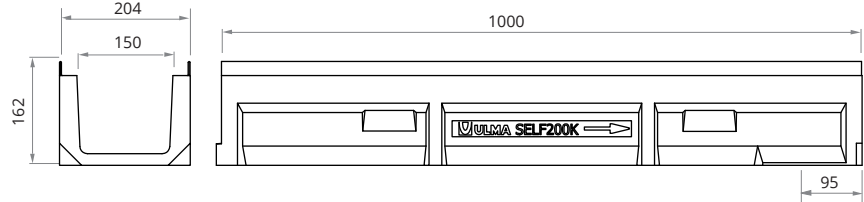

## CHANNEL

Code Channel	L mm	H mm	Width mm		Ø Outlet* mm		Hydraul. Section cm <sup>2</sup>	Pcs. pallet	Weight Kg	Qref l/s
			Ext.	Int.	Vert.	Hor.				
SELF200K	1000	162	204	150	160	-	180	40	19,7	7,6

\* Vertical outlets on order

## GRATINGS

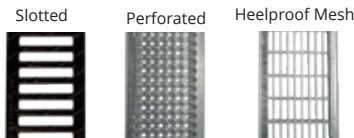

Material	Design	Load	Code	L mm	Width mm	Opening mm	Weight Kg	Intake area cm <sup>2</sup> /ml
DUCTILE IRON	SLOTTED	C250	FNX150KCCM	500	195	14	5,2	720
	PERFORATED	A15	GP150KCA	1000	195	Ø5	4,1	196
GALVANISED STEEL	MESH	B125	GEX150KCB	1000	195	30 x 20	5,6	1413
	HEELPROOF MESH*	B125	GEHX150KCB	1000	195	30 x 10	6,6	1133
STAINLESS STEEL	PERFORATED	A15	IP150KCA	1000	195	Ø5	4,1	794

\* Available in stainless steel, consult design

## HOW TO FIX

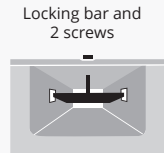

Code	Units ml
TEF880 + CS150	2 + 2
TNPC890 + CS150	2 + 2
TEF880 + CS150	2 + 2
TEF880 + CS150	2 + 2
TXNPC890 + CS150INOX	2 + 2

## SUMP UNITS

Code	L mm	H mm	Width mm	Lateral outlets Ø mm	Front outlet Ø mm	Sump units	Weight Kg
ASELF200K	500	400	204	160/200	160	1	28,9

## BUCKET

Code
CSELF200

## OPEN END CAP

Code	Ø mm
TSELF200KA	110

## CLOSED END CAP

Code
TSELF200KC



Load Class  
up to C250  
EN-1433 Standard

# SELF250



ULMA Linear Drainage Channel type SELF250: External width 260 mm; Internal width 200 mm and overall height 155 mm to collect rainwater in 1 metre long units. Locking system consists of locking bar CS200 and screws.

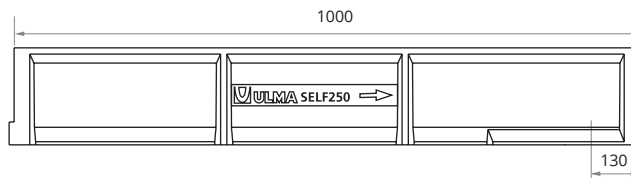
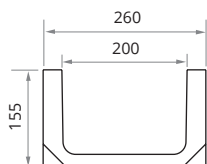

## CHANNEL

Code Channel	L mm	H mm	Width mm		Ø Outlet* mm		Hydraul. Section cm <sup>2</sup>	Pcs. pallet	Weight Kg	Qref l/s
			Ext.	Int.	Vert.	Hor.				
SELF250	1000	155	260	200	200	-	260	35	22,5	12,6

\* Vertical outlets on order

## GRATINGS



Material	Design	Load	Code	L mm	Width mm	Thickness mm	Opening mm	Weight Kg	Intake area cm <sup>2</sup> /ml
DUCTILE IRON	SLOTTED	C250	FNX200UCCM	500	250	6	10	6,7	610
GALVANISED STEEL	SLOTTED*	A15	GN200UCA	1000	250	4	8,5	5,2	418
	MESH*	B125	GEX200UCB33	1000	250	2,5	30 x 30	8,0	1634
	HEELPROOF MESH *	B125	GEHX200UCB	1000	250	2,5	30 x 10	9,5	1453
	SLOT*	C250	GR200UOC	1000	250	70	15	7,9	150
	DOUBLE SLOT*	C250	GDR200UOC	1000	250	70	2x12	10,0	240

\* Available in stainless steel, consult design

## HOW TO FIX

Locking bar and 2 screws



Code	Units ml
TEF1060 + CS200	2 + 2
TNPC1070 + CS200	2 + 2
TEF1060 + CS200	2 + 2
TEF1060 + CS200	2 + 2
(1)	(1)
(1)	(1)

(1) Click. Without screws.

## OPEN END CAP

Code	Ø mm
TSELF250A	160

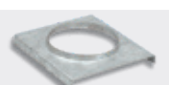

## CLOSED END CAP

Code
TSELF250C

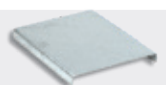

Load Class  
up to C250  
EN-1433 Standard

# SELF250K



ULMA Linear Drainage Channel type SELF250K: External width 260 mm; Internal width 200 mm and overall height 180 mm to collect rainwater in 1 metre long units. Integrated galvanised steel edges for lateral protection. Locking system consists of locking bar CS200 and screws.

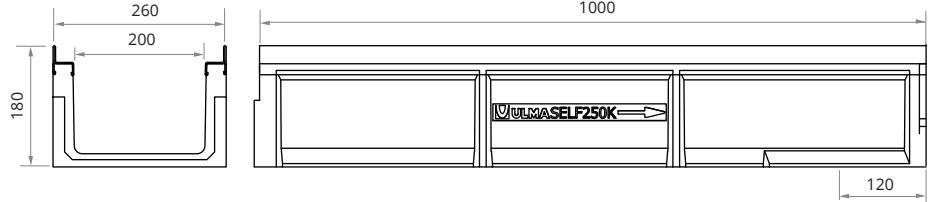

## CHANNEL

Code Channel	L mm	H mm	Width mm		Ø Outlet* mm		Hydraul. Section cm <sup>2</sup>	Pcs. pallet	Weight Kg	Qref l/s
			Ext.	Int.	Vert.	Hor.				
SELF250K	1000	180	260	200	160/200	-	260	28	27,5	12,6

\* Vertical outlets on order

## GRATINGS

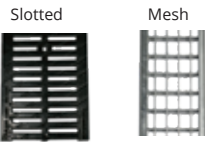

Material	Design	Load	Code	L mm	Width mm	Opening mm	Weight Kg	Intake area cm <sup>2</sup> /ml
DUCTILE IRON	SLOTTED	C250	FNX200KCCM	500	250	14	7,2	919
GALVANISED STEEL	MESH*	B125	GEX200KCB	1000	250	30 x 20	8,0	1846

\* Available in stainless steel, consult design

## HOW TO FIX

Locking bar and 2 screws



Code	Units ml
TEF1080 + CS200	2 + 2
TEF1080 + CS200	2 + 2

## SUMP UNITS

Code	L mm	H mm	Width mm	Lateral outlets Ø mm	Front outlet Ø mm	Sump units	Weight Kg
ASELF250K	500	500	260	315	160	1	47,9

## BUCKET

Code
CSELF250

## OPEN END CAP

Code	Ø mm
TSELF250KA	160

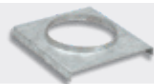

## CLOSED END CAP

Code
TSELF250KC

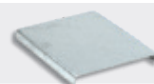

Load Class  
up to C250  
EN-1433 Standard

# SELF300



ULMA Linear Drainage Channel type SELF300: External width 300 mm; Internal width 250 mm and overall height 190 mm to collect rainwater in 1 metre long units. Locking system consists of locking bar CS250 and screws.

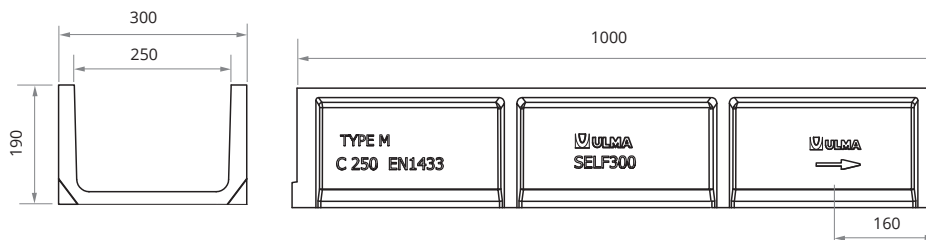

## CHANNEL

Code Channel	L mm	H mm	Width mm		Ø Outlet* mm		Hydraul. Section cm <sup>2</sup>	Pcs. pallet	Weight Kg	Qref l/s
			Ext.	Int.	Vert.	Hor.				
SELF300	1000	190	300	250	200	-	407	35	26,1	22,5

\* Vertical outlets on order

## GRATINGS

Slotted



Mesh



Material	Design	Load	Code	L mm	Width mm	Thickness mm	Opening mm	Weight Kg	Intake area cm <sup>2</sup> /ml	HOW TO FIX	
										Code	Units ml
DUCTILE IRON	SLOTTED	B125	FNX250UCBM	500	300	6	13,2	8,4	1049	TEF1070 + CS250	2 + 2
	SLOTTED	C250	FNX250UCCM	500	300	6	14	10,5	1004	TEF1070 + CS250	2 + 2
GALVANISED STEEL	MESH*	B125	GEX250UCB	1000	300	3	30 x 20	12,3	1993	TEF1070 + CS250	2 + 2

\* Available in stainless steel, consult design

## HOW TO FIX

Locking bar and 2 screws

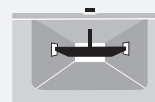

## SUMP UNITS

Code	L mm	H mm	Width mm	Lateral outlets Ø mm	Front outlet Ø mm	Sump units	Weight Kg	BUCKET	
								Code**	Weight Kg
AU250	500	375	310	160/200	-	1	36,5	C250	36,5
AU250S + A250B	500	725*	310	160/200	-	2	62,7		

\* The sump unit can be higher incorporating an intermediate unit.

## BUCKET



\*\* Only applicable if 2 sump units are installed.

## OPEN END CAP

Code	Ø mm	Image
TSELF300A	160	

## CLOSED END CAP

Code	Image
TSELF300C	

Load Class  
up to C250  
EN-1433 Standard

# SELF350K

ULMA Linear Drainage Channel type SELF350K: External width 362 mm; Internal width 300 mm and overall height 210 mm to collect rainwater in 1 metre long units. Integrated galvanised steel edges for lateral protection. Locking system consists of locking bar CS300 and screws.

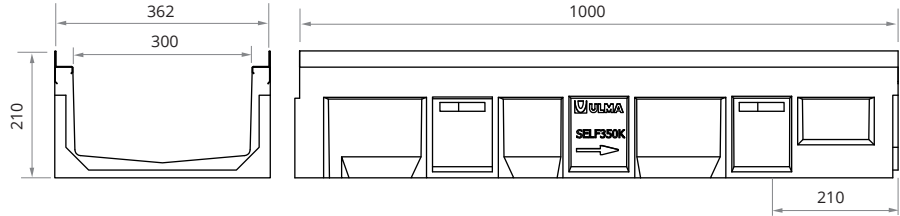

## CHANNEL

Code Channel	L mm	H mm	Width mm		Ø Outlet* mm		Hydraul. Section cm²	Pcs. pallet	Weight Kg	Qref l/s
			Ext.	Int.	Vert.	Hor.				
SELF350K	1000	210	362	300	250	-	455	21	40,3	23,3

\* Vertical outlets on order

## GRATINGS

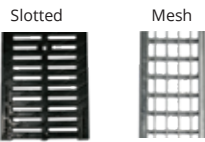

Material	Design	Load	Code	L mm	Width mm	Opening mm	Weight Kg	Intake area cm²/ml
DUCTILE IRON	SLOTTED	C250	FNX300KCCM	500	351	14	15,3	1368
GALVANISED STEEL	MESH*	B125	GEX300KCB	1000	351	30 x 20	13,2	2672

\* Available in stainless steel, consult design

## HOW TO FIX

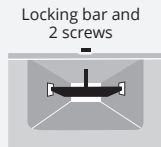

Code	Units ml
TEF1090 + CS300	2 + 2
TEF1090 + CS300	2 + 2

## SUMP UNITS

Code	L mm	H mm	Width mm	Lateral outlets Ø mm	Front outlet Ø mm	Sump units	Weight Kg
ASELF350K	500	500	362	315	160/200	1	56,3

## BUCKET

Code
C250

## OPEN END CAP

Code	Ø mm
TSELF350KA	160

## CLOSED END CAP

Code
TSELF350KC



# SUMP UNITS

## AEURO100 / AEURO100K

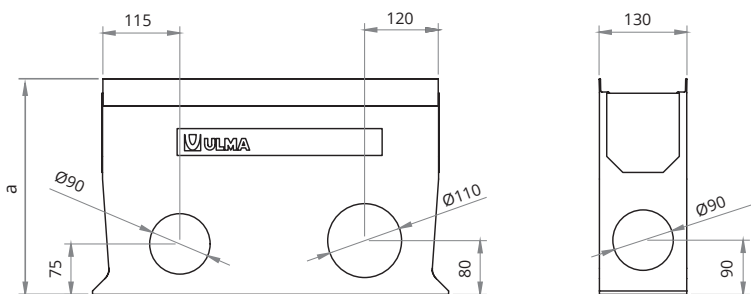

Code Channel	a mm
AEURO100	300
AEURO100K	318

## ASELF200 / ASELF200K

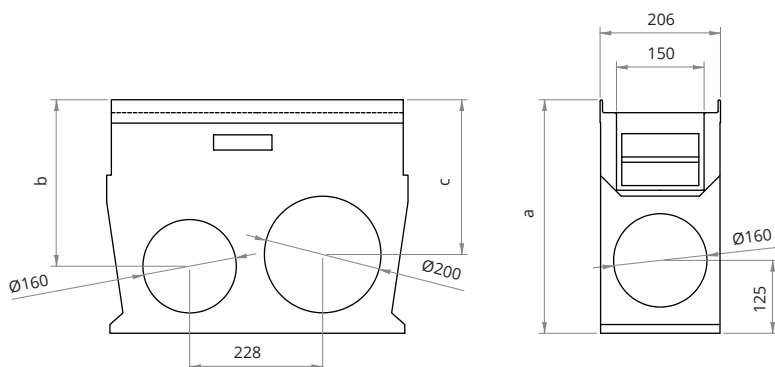

Code Channel	a mm	b mm	c mm
ASELF200	370	255	235
ASELF200K	400	285	265

## ASELF250K / ASELF350K

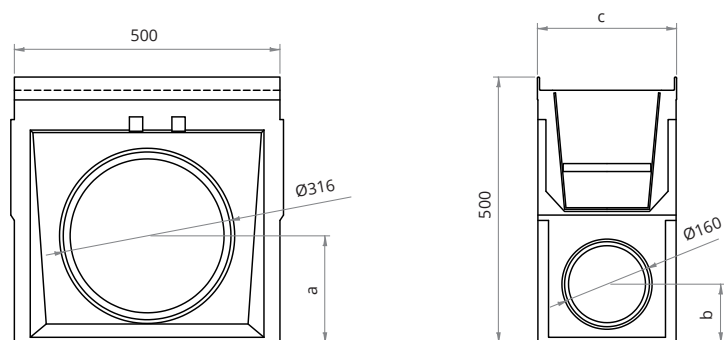

Code Channel	a mm	b mm	c mm
ASELF250K	200	110	260
ASELF350K	185	105	362

## AU250S + A250I + A250B

