



Selection tables of Mapei products for the installation of wooden floors

Substrates

	 Ultradbond P990 1K	 Ultradbond Eco P992 1K	Ultradbond P997 1K T	Ultradbond P-R9	 Ultradbond Eco S955 1K	Ultradbond P902 2K	Ultradbond P913 2K	Lignobond
TYPES OF PARQUET								
Mosaic (EN 13488)	●	●		●□	●	●	●	●
Solid wood without joints (EN 13227)	●	●		●□	●	●△	●	●
Solid jointed wood (EN 13226)	●	●		●□	●	●△	●	●
Assembled control panels (EN 13629)	●	●	●+	●□	●	●	●	●
Plywood elements (EN 13489)	●	●	●+	●□	●	●	●	●
Laminated and floating								
Wood skirting	●		●					
Stairs			●+					

KEY



This symbol is used to identify MAPEI products which give off a low level of volatile organic compounds (VOC) as certified by GEV (Gemeinschaft Emissionskontrollierte Verlegewerkstoffe, Klebstoffe und Bauprodukte e.V.), an international organisation for controlling the level of emissions from products used for floors.

- MAPEI recommended
- * Small sized (L ≤ 500 mm)
- + Kerb laying
- △ Medium sized
- For the fixing of elements non perfectly anchored to the substrate

N.B. - THIS TABLE IS MERELY INDICATIVE; FOR FURTHER INFORMATION, REFER TO THE TECHNICAL DATA SHEET FOR EACH PRODUCT

**SELECTION TABLE OF MAPEI ADHESIVES
FOR THE INSTALLATION OF WOODEN FLOORS**

	Adesilex LC/R	Adesilex LC/RP	Adesilex LC	Adesivil D3	Adesilex PA	Ultrabond Eco 575
	•	•	•		•	
	•	•	•		•	
	•					
					•	
				•		
						•



Adhesives in water emulsion

Adesilex LC/R

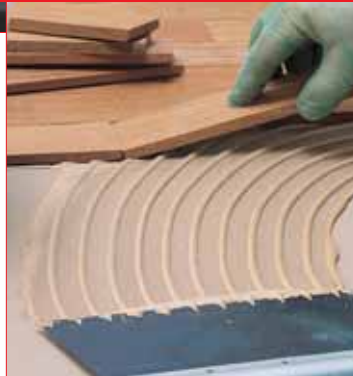

Fast-setting adhesive in water emulsion and with low water content for bonding wooden flooring.

Where to use:

Bonding of:

- wood-back strips and mosaic wooden flooring;
- strips, blocks;
- small wood strips of all types of wood.

Technical data:

Consistency: thick paste.

Colour: beige and brown.

Flammability: no.

Application temperature range:

from +10°C to +30°C.

Open time: approximately 30 minutes.

Set to light foot traffic: after 24 hours.

Polishing: once completely dry (minimum 10 days).

Storage: 24 months. Protect from frost.

Application: notched trowel.

Consumption

0.8-1.0 kg/m².

Packaging

20 and 12 kg drums.



Adesilex LC/RP



Adhesive in water dispersion and with low water content for bonding wooden flooring.

Where to use:

Bonding of:

- wood-back strips and mosaic wooden flooring;
- all types of wooden strips;
- small wood strips not very sensitive to moisture.

Technical data:

Consistency: thick paste.

Colour: beige and brown.

Flammability: no.

Application temperature range:

from +10°C to +30°C.

Open time: approximately 30 minutes.

Set to light foot traffic: after 24 hours.

Polishing: once completely dry (minimum 10 days).

Storage: 24 months. Protect from frost.

Application: notched trowel.

Consumption

0.8-1.0 kg/m².

Packaging

20 and 12 kg drums.



PRIVATE APARTMENT - Reggio Emilia - Italy
Wooden flooring laid with ADESILEX LC/R and ULTRABOND P902 2K
on screed carried out with ECO PRIM PI 1K



Adesilex LC



Adhesive in water emulsion for bonding wooden flooring.

Where to use:

- Bonding of:
- wood-back strips and mosaic wooden flooring;
 - all types of wooden strips and blocks;
 - small wood strips not very sensitive to moisture.

Technical data:

- Consistency:** thick paste.
Colour: beige and brown.
Flammability: no.
Application temperature range: from +10°C to +30°C.
Open time: approximately 30 minutes.
Set to light foot traffic: after 24 hours.
Polishing: once completely dry (minimum 20 days).
Storage: 24 months. Protect from frost.
Application: notched trowel.

Consumption

0.8-1.0 kg/m².

Packaging

20 and 10 kg drums.



Adesivil D3



Solvent-free adhesive for prefinished water resistant floating wooden or laminate flooring.

Where to use:

- Bonding of:
- joints between pieces of prefinished wooden flooring;
 - small wooden pieces;
 - DIY works.

Technical data:

- Consistency:** viscose liquid.
Colour: white.
Dried film: transparent.
Flammability: no.
Application temperature range: from +15°C to +35°C.
Open time: 5-10 minutes.
Set to light foot traffic: after approx. 12 hours.
Final hardening: approximately 24 hours.
Resistance to water: D3 class/EN 204-205.
Storage: 24 months. Protect from frost.
Application: extrusion from the nozzle of the bottle.

Consumption

0.025 kg/m or 0.1-0.2 kg/m².

Packaging

0.5 kg bottles.



Adhesives based on resins in alcohol

Adesilex PA



Adhesive based on synthetic resins in alcohol for bonding wooden flooring.

Where to use:

Bonding of:

- wood-back strips and mosaic wooden flooring;
- all types of wooden strips and blocks;
- small sized prefinished wooden flooring.

Technical data:

Consistency: creamy paste.

Colour: beige.

Flammability: yes.

Application temperature range:

from +10°C to +30°C.

Open time: approx. 10-20 minutes.

Set to light foot traffic: after 24-72 hours.

Polishing: at least 72 hours.

Storage: 24 months.

Application: notched trowel.

Consumption

0.6-1.2 kg/m².

Packaging

16 kg drums.



FLATS IN WIENERBERG - Austria
Products used: TOPCEM PRONTO,
PRIMER PA, ADESILEX PA

Sililated-based adhesives

ADHESIVES FOR WOODEN AND LAMINATE FLOORING

New

97



HOTEL WERZER -
Pörtschach - Austria
Products used:
NIVORAPID, PRIMER G,
ADESILEX PA

Ultrabond Eco S955 1K



One-component, isocyanate and solvent-free, sililated polymer-based adhesive with very low emission of volatile organic compounds (VOC), for all types of parquet.

Where to use:

Bonding pre-finished and traditional solid wood parquet, pre-assembled tops and all shapes and types of multi-layered elements on any kind of substrate. Suitable for heated substrates. No hazard symbols on packaging, and does not contain solvents, isocyanites or free amines, so may be used by those subjects allergic to epoxy-polyurethane products. Easy to clean from hands and pre-finished surfaces. Particularly suitable whenever blocks must be fixed quickly in place.

Technical data:

Consistency: creamy paste.

Colour: beige or brown.

Inflammable: no.

Recommended application temperature range: from +10°C to +35°C.

Open time: 50-60 minutes.

Set to light foot traffic: after 12 hours.

Sanding: after 3 days.

EMICODE: EC1 R - very low emission.

Storage: 12 months.

Application: notched trowel.

Consumption

0.8-1.2 kg/m².

Packaging

15 kg aluminium bags contained in plastic drums.



Two-component epoxy-polyurethane adhesives

Lignobond



Two-component solvent and water free epoxy-polyurethane adhesive for wooden flooring.

Where to use:

Bonding of all types and sizes of wooden flooring on all types of substrate. Suitable for heating screeds.

Technical data:

Consistency: comp. A: thick paste; comp. B: fluid paste.

Colour: comp. A: dark brown or beige; comp.: straw yellow.

Flammability: no.

Mixture ratio: comp. A : comp. B = 90 : 10.

Pot life: 50-60 minutes.

Application temperature range: from +10°C to +30°C.

Open time: 1 hours.

Setting time: 5 hours.

Set to light foot traffic: after 12-24 hours.

Polishing: after 3 days.

Storage: 24 months.

Application: notched trowel.

Consumption

1.0-1.5 kg/m².

Packaging

10 kg and 5 kg drums.



Ultrabond P902 2K



Two-component epoxy-polyurethane adhesive for wooden flooring.

Where to use:

Bonding of all types and sizes of wooden flooring on all types of substrate. Suitable for heating screeds.

Technical data:

Consistency: comp. A: pasty; comp. B: pasty.

Colour: comp. A: beige or brown; comp. B: whitish.

Flammability: no.

Mixture ratio: comp. A : comp. B = 90 : 10.

Pot life: 60-70 minutes.

Application temperature range:

from +10°C to +30°C.

Open time: 1 hour.

Set to light foot traffic: after 24 hours.

Polishing: after 3 days.

Storage: 24 months.

Application: notched trowel.

Consumption

1.0-1.5 kg/m².

Packaging

10 kg drums (A+B).



HOTEL NHOW - Milan - Italy
Wooden flooring installed with ULTRABOND P902 2K on screeds prepared with
MAPECEM, MAPECEM PRONTO, TOPCEM and TOPCEM PRONTO

New

Ultrabond P913 2K



Two-component, epoxy-polyurethane adhesive for wooden floors.

Where to use:
Bonding traditional, medium-sized solid wood floors and for all types of pre-finished floors.

Technical data:
Consistency: comp. A: paste; comp. B: paste.
Colour: comp. A: beige or brown; comp. B: beige.
Inflammable: no.
Mixing ratio: comp. A : comp. B = 90 : 10.
Pot life of mix: 60 minutes.
Recommended application temperature range: from +10°C to +30°C.
Open time: 60 minutes.
Set to light foot traffic: after 24 hours.
Sanding: after 3 days.
Storage: 24 months.
Application: notched trowel.

Consumption
1.0-1.5 kg/m².

Packaging
10 kg drums (A + B).

One-component polyurethane adhesives



Ultrabond P990 1K



Ready-to-use polyurethane one-component, solvent-free, elastic adhesive for all types of wooden flooring and with very low emission of volatile organic compounds (VOC).

Where to use:

Bonding pre-finished and traditional solid wood parquet, pre-assembled tops and all shapes and types of multi-layered elements on any kind of substrate. Particularly suitable for underfloor heating systems.

Ultrabond P990 1K is odourless, solvent free and exempt from free amines, therefore even installers allergic to epoxy and epoxy-polyurethane products can use it.

Technical data:

Consistency: creamy paste.

Colour: beige and brown.

Flammability: no.

Application temperature range:

from +10°C to +35°C.

Open time: 110 minutes.

Set to light foot traffic: after 12 hours.

Polishing: after 3 days.

EMICODE: EC1 R - very low emission.

Storage: 12 months.

Application: notched trowel.

Consumption

0.8-1.0 kg/m².

Packaging

15 and 7 kg in aluminium bags contained in plastic drums.

Carton containing twenty 600 cc aluminium soft cartridges.





Ultrabond P997 1K T



Solvent-free, one-component, ready-to-use, thixotropic polyurethane adhesive for laying wooden steps.

Where to use:

Laying wooden uprights treads and stairs and wooden mosaic on wall. Also suitable for bonding wooden baseboards and for laying pre-finished, three-layered parquet with beads of adhesive:

Technical data:

Consistency: thixotropic paste.

Colour: ochre.

Inflammable: no.

Recommended application temperature range: from +10°C to +35°C.

Open time: approx. 100 minutes.

Set to light foot traffic: after 12 hours.

Polishing: after 3 days.

Storage: 12 months.

Application: by extrusion.

Consumption

- installing wooden stairs: the yeald is ca. 2 m² each soft cartridge (diagonal bead with the distance of 5-10 cm);
- installing pre-finished parquet with three layers: the yeald is ca. 4/6 m² each soft cartridge (diagonal bead with the distance of 10-15 cm);
- installing wood skirtings: the yeald is ca. 15 ml each soft cartridge.

Packaging

boxes containing 20 aluminium soft cartridges, each one containing 600 c.c.



Ultrabond Eco P992 1K



Solvent-free, one-component, ready-to-use, flexible polyurethane adhesive with very low emission of volatile organic compounds (VOC), for all types of parquet and laminates.

Where to use:

Bonding pre-finished and traditional solid wood parquet, pre-assembled tops and all shapes and types of multi-layered elements on any kind of substrate. It is particularly suitable for heating substrates. It is also suitable for floor layers allergic to epoxy and epoxy-polyurethane products. Does not carry any hazard warning indication and is completely free of solvents and any substance which gives off unpleasant odours therefore is particularly suitable for rebuilding work, and for use close to inhabited areas.

Technical data:

Consistency: creamy paste.

Colour: beige.

Inflammable: no.

Recommended application temperature range: from +10°C to +35°C.

Open time: 140 minutes.

Set to light foot traffic: after 12 hours.

Facing: after 3 days.

EMICODE: EC1 - very low emission.

Storage: 12 months.

Application: notched trowel.

Consumption

0.8-1.0 kg/m².

Packaging

15 kg aluminium bags contained in plastic drums.



Ultrabond P-R9



One-component, hygro-setting, expansive polyurethane adhesive used by injection, for fastening and repairing parquet elements which are not perfectly bonded to the substrate.

Where to use:

Fastening and repairing parquet elements which are not perfectly bonded to the substrate, by injecting the product into holes drilled in correspondence with the joints between the elements. It may also be used indoors on pre-finished and painted floors, both before and after sanding. Take care when applying the product.

Technical data:

Consistency: liquid.

Colour: brown.

Inflammable: no.

Recommended application temperature range: from +10°C to +35°C.

Sanding: after 24 hours.

Set to light foot traffic: after 24 hours.

Storage: 6 months.

Application: by extrusion from the tip on the canister.

Consumption

1-2 ml injected into each hole.

Packaging

0.5 kg canisters.

Coloured sealants



Silwood

New



Acrylic sealant in water dispersion for wooden floors.

Where to use:

Sealing perimeter joints in wooden floors and joints between different types of floors when there is no joint trim. Once dry, Silwood may be sanded down and painted over.

It is available in oak, iroko, doussié, wengé, teak, walnut, cherry, beech, maple and birch, and their colours are very similar to the various types of wood most commonly used.

Technical data:

Consistency: creamy paste.

Colour: oak, iroko, doussié, wengé, teak, walnut, cherry, beech, maple and birch (insert code numbers).

Inflammable: no.

Application temperature range: from +5°C to +35°C.

Open time: 10-20 minutes.

Sanding: after 24 hours. After sanding, the product may be painted over.

Storage: 12 months.

Application: by extrusion from a tube.

Consumption

according to the size of the joint to be filled, calculating that its volume mass is 1.75 g/cm³.

Packaging:

310 ml tubes.



Water-based and solvent-based stuccos

Ultracoat Acqua Plus

New



Solvent-free, water-based binder with extremely low emission levels of volatile organic compounds (VOC) and no NMP, mixed with sawdust for grouting wooden floors. Suitable for water-based varnishing cycles.

Where to use:

Grouting and preparing traditional wooden floors, both pre-polished and those requiring repair.

Prepare the grout by mixing the product with sawdust given off during sanding (mixing ratio **Ultracoat Acqua Plus**: sawdust = 3-4 : 1) until a homogenous paste is obtained. Seal the floor by applying the product with a stainless steel or plastic trowel, forcing as much mix as possible to penetrate into the cracks.

Technical data:

Consistency: liquid.

Colour: whitish.

Inflammable: no.

Recommended application temperature range: from +10°C to +35°C.

Sanding: after approximately 1 hour.

Painting: the surface may be painted over after 3 hours, and within 5 hours, with water-based varnish.

Storage: 12 months.

Application: stainless steel or plastic trowel.

Consumption

100-120 g/m² per coat.

Packaging

5 l cans.



Ultracoat LS

New

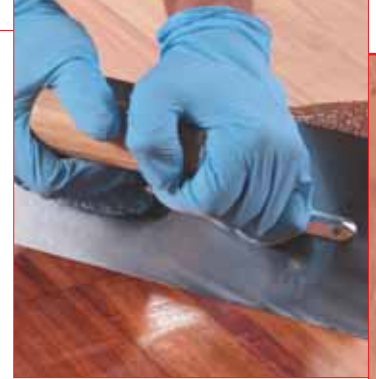

Nitro-cellulose based binder in solvents, mixed with sawdust for grouting wooden floors. Also suitable for sealing large cracks.

Where to use:

Grouting and preparing traditional wooden floors, both pre-polished and those requiring repair.

Prepare the grout by mixing the product with sawdust given off during sanding (mixing ratio **Ultracoat LS**: sawdust = 3-5 : 1) until a homogenous paste is obtained. Seal the floor by applying the product with a stainless steel or plastic trowel, forcing as much mix as possible to penetrate into the cracks.

Technical data:

Consistency: liquid.

Colour: brown.

Inflammable: yes.

Recommended application temperature range: from +10°C to +35°C.

Sanding: after approximately 30 minutes.

Painting: after 30 minutes.

Storage: 12 months.

Application: stainless steel or plastic trowel.

Consumption

100-120 g/m² per coat.

Packaging

10 kg drums.

Water-based base coats

New

Ultracoat P920 2K



Two-component water-based base coat, with very low emission of volatile organic compounds (VOC) and no NMP, for wooden floors.

Where to use:

Preparation of traditional wooden floors, both pre-polished and those requiring repair.

Two-component, water-based base product characterised by its high insulating properties. Easy to sand down and easy to apply.

Reduces the problem of overlaps.

Ultracoat P920 2K has been developed to stain wood without causing unsightly colour variations on wood rich in tannin and other water-soluble colorants (such as oak, teak, etc.). Therefore, it is particularly suitable for more difficult types of wood to avoid them becoming darker or redder.

Ultracoat P920 2K contains a high level of residual solids, and when used in combination with **Ultracoat P925** two-component, water-based paint, it may be applied in two coats.

If single component water-based **Ultracoat P915** paint is used, we recommend applying the cycle in three coats.

Technical data:

Consistency: comp. A liquid; comp. B liquid.

Colour: comp. A transparent; comp. B whitish.

Inflammable: no.

Recommended application temperature range: from +10°C to +35°C.

Pot life of mix: 2 hours.

Mixing ratio: comp. A : comp. B = 5:1 (in volume).

Maximum permitted dilution ratio (Dir. 2004/42/CEE): 10% with clean water.

Recommended at all times at high temperatures.

Sanding: after 12 hours.

Painting: after 2 hours, and within 12 hours.

Storage: 12 months.

Application: by roller or brush.

Consumption

80-100 g/m² per coat.

Packaging

6 l units (A + B).



Water-based and solvent-based varnishes

PAINTS, STUCCOS, BASE COATS AND COLOURED SEALANTS FOR WOODEN FLOORING

New

Ultracoat P915



One-component, water-based polyurethane varnish, with extremely low emission levels of volatile organic compounds (VOC) and no NMP, highly resistant to wear and abrasion, for wooden floors. Suitable for floors subject to frequent pedestrian use.

Where to use:

Highly protective, wear and abrasion-resistant finish for traditional wooden floors for civil and commercial use, both pre-sanded and those requiring repair.

Ultracoat P915 has excellent resistance to abrasion and skid marks. It is aesthetically different from conventional water-based products, in that it is transparent and leaves a warm-coloured finish to the wood. We recommend a three-coat cycle using **Ultracoat P915** or, as an alternative, a first coat of **Ultracoat P920 2K** two-component, water-based base product followed by two coats of **Ultracoat P915**. **Ultracoat P915** is available in opaque (30 gloss - **Ultracoat P915/O**) and satin finish (60 gloss - **Ultracoat P915/S**).

Technical data:

Consistency: liquid.

Colour: transparent.

Gloss factor: opaque (30 gloss) and satin finish (60 gloss).

Inflammable: no.

Recommended application temperature range: from +10°C to +35°C.

Maximum permitted dilution ratio (Dir. 2004/42/CEE): 10% with clean water.

Sanding: after 8 hours.

Painting: after 3 hours, and within 5 hours.

Ready for use: 36-48 hours.

Storage: 12 months.

Application: by roller or brush.

Consumption

70-90 g/m² per coat.

Packaging

5 l cans.

New

Ultracoat P925



Two-component, water-based polyurethane varnish, with an extremely low emission level of volatile organic compounds (VOC) and no NMP, highly resistant to wear and abrasion, for wooden floors. Suitable for floors subject to extremely high pedestrian use.

Where to use:

Highly protective and wear and abrasion-resistant finish on traditional and pre-sanded wood, and wooden floors requiring repair. It may be used in civil and commercial environments subject to extremely high pedestrian use (public offices, shopping centres, airports, exhibition halls, etc.)

Ultracoat P925 has excellent resistance to abrasion and skid marks, which has never been possible with other water-based products. It leaves the parquet with an attractive "natural" finish. Floors treated with this varnish have a natural, even finish, and may be cleaned very easily, as with impregnation cycles which require the use of oil and wax. If it is applied directly without a base product, it livens up the colour of the parquet without yellowing over the years.

A single coat applied directly on top of **Ultracoat P920 2K** base product is usually enough to complete the varnishing cycle. As an alternative, **Ultracoat P925** may be applied directly on the floor instead of the base coat.

Ultracoat P925 is available in opaque (30 gloss - **Ultracoat P925/O**) and satin finish (60 gloss - **Ultracoat P925/S**).

Technical data:

Consistency: comp. A liquid; comp. B liquid.

Colour: comp. A transparent; comp. B whitish.

Gloss factor: opaque (30 gloss) and satin finish (60 gloss).

Inflammable: no.

Recommended application temperature range: from +10°C to +35°C.

Pot life of mix: 2 hours.

Mixing ratio: comp. A : comp. B = 10 : 1 (in volume).

Maximum permitted dilution ratio (Dir. 2004/42/CEE): 10% with clean water.

Sanding: after 12 hours.

Painting: after 3 hours, and within 5 hours.

Ready for use: 36-48 hours.

Storage: 12 months.

Application: by roller or brush.

Consumption

70-90 g/m² per coat.

Packaging

11 l units (A + B).

New

Ultracoat PF1

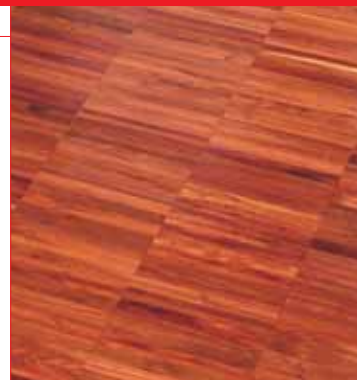

Two-component, fireproof polyurethane varnish, with class 1 fire reaction certification for wooden floors according to UNI 9796/CNVVF/CCI Standards, as outlined in D.M. 06/03/92.

Where to use:

For finishes with a high resistance to wear on floors and wooden items, where class 1 fire reaction certification is required.

Technical data:

Consistency: comp. A liquid; comp. B liquid.

Colour: comp. A straw yellow; comp. B straw yellow.

Gloss factor: gloss (90 gloss).

Inflammable: yes.

Recommended application temperature range: from +10°C to +35°C.

Pot life of mix: 4 hours.

Mixing ratio: comp. A : comp. B = 1:1 (in volume).

Sanding: after 24 hours.

Ready for use: 3 days.

Storage: 12 months.

Application: by roller, brush or spray.

Consumption

150 g/m² per coat. Class 1 fire reaction certification may be obtained by applying a total of three coats of the product at 450 g/m² (equivalent to 405 ml/m²).

Packaging

20 l units (A + B).

Detergents

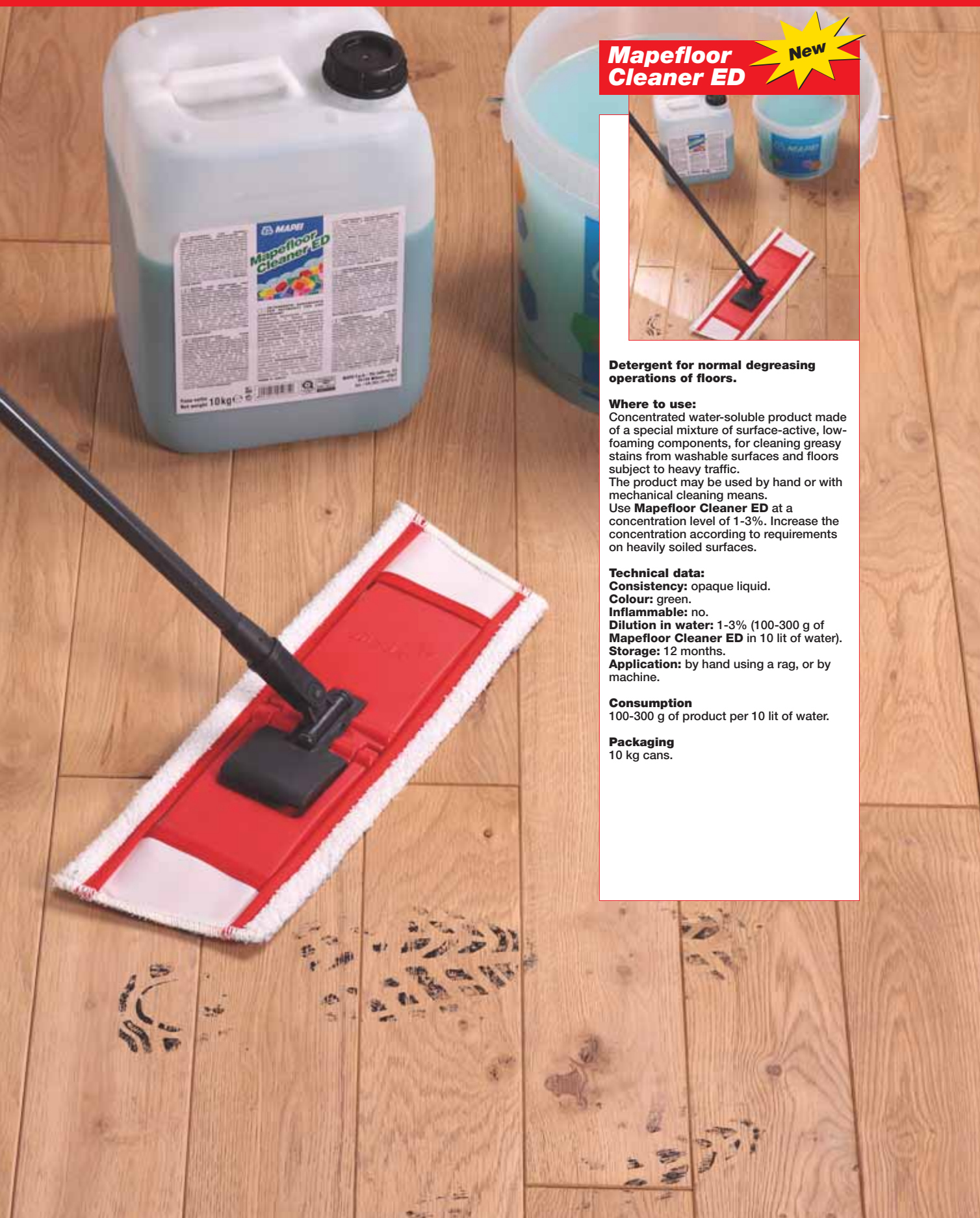

**Mapefloor
Cleaner ED**

New

Detergent for normal degreasing operations of floors.

Where to use:

Concentrated water-soluble product made of a special mixture of surface-active, low-foaming components, for cleaning greasy stains from washable surfaces and floors subject to heavy traffic.

The product may be used by hand or with mechanical cleaning means.

Use **Mapefloor Cleaner ED** at a concentration level of 1-3%. Increase the concentration according to requirements on heavily soiled surfaces.

Technical data:

Consistency: opaque liquid.

Colour: green.

Inflammable: no.

Dilution in water: 1-3% (100-300 g of **Mapefloor Cleaner ED** in 10 lit of water).

Storage: 12 months.

Application: by hand using a rag, or by machine.

Consumption

100-300 g of product per 10 lit of water.

Packaging

10 kg cans.

Waxes



Mapelux Lucida



Shiny, metal-filled, high-resistance, double-reticulation floor wax.

Where to use:

Protective treatment on parquet floors in civil environments, such as shops, showrooms, apartments and offices subject to particularly high traffic. **Mapelux Lucida** is characterised by its high resistance to traffic and frequent clearing cycles with strong detergents, and may also be employed to make maintenance operations easier. Thanks to the product's double reticulation which binds all the components, the **Mapelux Lucida** film is easy to clean, and marks and stains left by traffic may be removed by a simple washing cycle.

Mapelux Lucida must be applied in two criss-cross coats, to obtain good protection of the entire surface.

Technical data:

Consistency: liquid.

Colour: bluish-white.

Inflammable: no.

Application temperature range: from +10°C to +30°C.

Storage: 12 months.

Application: using a wax spreader.

Consumption

approximately 50 g/m².

Packaging

10 kg cans.



Mapelux Opaca



Opaque, metal-filled, high-resistance, double-reticulation floor wax.

Where to use:

Protective treatment on parquet floors in civil environments, such as shops, showrooms, apartments and offices subject to particularly high traffic. **Mapelux Opaca** is characterised by its high resistance to traffic and frequent clearing cycles with strong detergents, and may also be employed to make maintenance operations easier. Thanks to the product's double reticulation which binds all the components, the **Mapelux Opaca** film is easy to clean and marks and stains left by traffic may be removed by a simple washing cycle.

Mapelux Opaca must be applied in two criss-cross coats, to obtain good protection of the entire surface.

Technical data:

Consistency: liquid.

Colour: bluish-white.

Inflammable: no.

Application temperature range: from +10°C to +30°C.

Storage: 12 months.

Application: using a wax spreader.

Consumption

approximately 50 g/m².

Packaging

10 kg cans.



Abrasive products

New

Ultracoat SR



Abrasive mesh disks in silica carbide for sanding parquet floors.

Where to use:

Ultracoat SR abrasive disks are suitable for finishing operations using a machine with a rotating head (single-disk) on rough wood, and for sanding base products, impregnating products and varnish.

Ultracoat SR abrasive disks are available in grades 60, 80, 100, 120, 150, 180, 220 and 320 grain size.

Packaging

boxes containing 20 pieces.



Ultracoat PAD



Pads used for polishing and cleaning parquet floors.

Where to use:

According to the colour (which indicates the grain size and abrasion property), **Ultracoat PAD** disks suitable for parquet floors for cleaning, routine maintenance, polishing and waxing operations with oil and wax.

Ultracoat PAD disks are available in white and tan (for polishing and for applying wax and oil), red (for routine maintenance operations), green (for treating with oil and quick removal of stains and streaks) and black (for quick, thorough deep-down cleaning with a minimum of abrasion, suitable for acid products).

Packaging

boxes containing 5 pieces.



Tools



Trowels for levelling compounds



American - 28 cm.
Extralong - 50 cm.

Trowels for adhesives



Normal metal notch N. 1
Normal metal notch N. 2
Normal metal notch N. 3
Normal metal notch N. 4
Normal metal notch N. 5
Normal metal for wooden flooring

Gun for soft-cartridges



Gun for 600 ml soft-cartridges.

Gun for sealants



Gun for 310 ml cartridges.



Spiked roller



Plastic roller, 23 cm wide and 8 cm in diameter with a handle.
To be used to improve the flow of levelling compounds in thicknesses from 2 to 15 mm, to remove air bubbles and to improve the appearance of the surface of Mapei self-levelling compounds.

Carbide hygrometer



Chemical instrument for measuring the humidity in the substrates. The water reacts with the calcium carbide inside the hygrometer. Acetylene is formed which makes the pressure rise. The water content is determined by the pressure on the manometer.

The hygrometer comes in a plastic suitcase containing:

- a steel container with a stopper and a manometer;
 - 20 glass phials containing calcium carbide;
 - 2 aluminium marbles;
 - 1 scale with support, scalepan, and 20 g and 10 g weights;
 - 1 syringe;
 - 1 small steel spoon and plate.
- 20 boxes containing glass calcium carbide phials are available.

Electronic hygrometer



Electronic instrument that rapidly indicates the % of humidity contained in cement based screeds (A scale), Mapecem based screeds (B scale), and anhydrite based screeds (C scale).

The hygrometer is powered by 9 V batteries and comes in a case containing:

- a cable with a uniaxial connector and connecting terminals with the electrodes that are driven into the screed;
- two steel nails that are used as electrodes;
- an instruction leaflet.

Mapei solutions for the installation of screeds for laying floors

The service life and functionality of a floor covering, whether the material used is ceramic, stone, fabric, resilient or wood, is highly dependant on the physical and elastic-mechanical characteristics of the substrate on which it is laid.

These properties must be defined according to its final use and, therefore, according to the loads which act upon it, the environmental aggression conditions, the type of floor, the deformability of the underlying layers and the deflection of the concrete slab. This technical notebook aims at supplying useful guidelines regarding the techniques to be used and on the products which Mapei offers for the installation of screeds which are durable over a long period of time.

A screed is a constructive element which, in general, is between 4 and 8 cm thick. It is made from mortars blended with cementitious binders or with an anhydrite base. According to whether it is laid so that it adheres to a load-bearing substrate (for example a reinforced concrete slab) or it is laid onto an isolation layer (for example a vapour barrier) or onto a layer of thermal and/or acoustic insulation, it is known as "bonded", "isolating" or "floating", respectively. When the latter type also includes embedded heating pipes, they are defined as "heating".

The screed forms a support which is suitable for any type of floor, be it in ceramic, stone, wood or a resilient material. Also, it must guarantee that the laying operation is carried out in the time required and that its durability is not compromised when operating under various conditions (internal or external use, domestic, commercial or industrial use, etc.).

The durability of a floor covering is influenced, therefore, by the characteristics of the substrate, which are tightly bound to those of the product used for screeds (special binders, pre-blended mortar or traditional mortar prepared on site), and also by the way it is prepared, how it is laid, its compactness and the curing of the mix. To sum up, therefore, the choice of which product to use for the screed must take into consideration its final use, the particular site conditions (internal use, external use, thickness, etc), the type of floor to be laid and the time to wait before laying and before putting the floor covering into service.

TYPES OF SCREEDS

Screeds can be divided into the following categories:

- Isolating (Figs. 1 and 2)
- Floating (Fig. 3)
- Bonded (Fig. 4)
- Heating (Fig. 5)

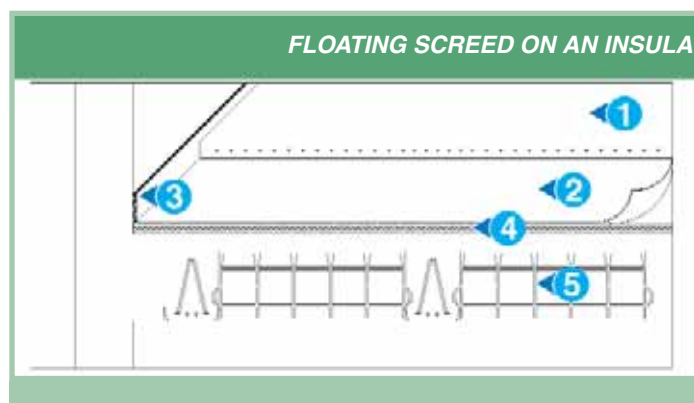
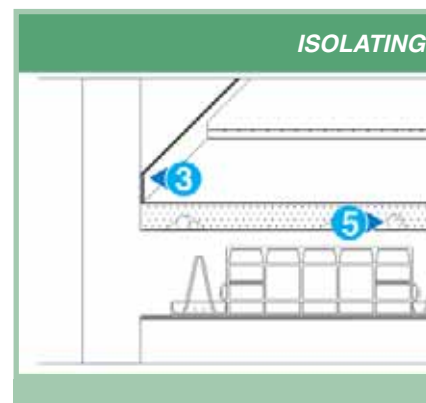
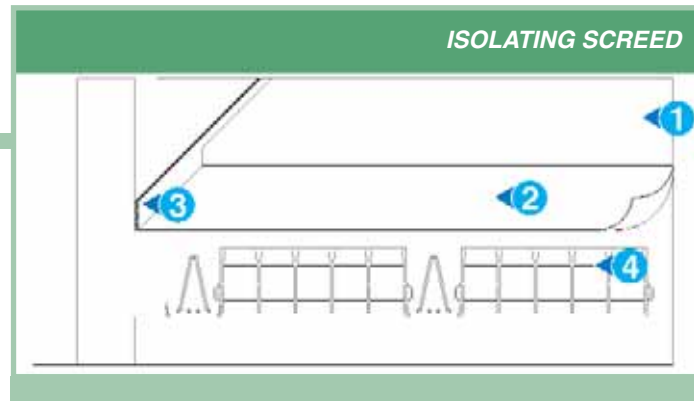

Tab. 1 - Minimum thickness of floating screed according to the deformability

INSULATION Deformability class	
I:	Thickness < 3 mm
I:	Flattening* < 0.5 mm and thickness > 3 mm
II:	Flattening > 0.5 mm and ≤ 3 mm included
III:	Flattening > 3 mm and < 12 mm

* Flatten. the compre



TOPCEM PRONTO and MAPECEM PRONTO
pre-blended mortars for screeds conform to standard **EN 13813** and are **CE** marked



- 1 SCREED ≥ 3.5 cm THICK
- 2 POLYETHYLENE SHEET
- 3 DEFORMABLE MATERIAL
- 4 CONCRETE SLAB

Fig. 1

SCREED OVER LIGHTWEIGHT LAYER

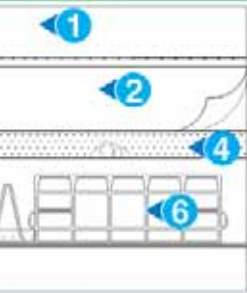

- 1 SCREED ≥ 3.5 cm THICK WITH ELECTRIC-WELDED MESH
- 2 POLYETHYLENE SHEET
- 3 DEFORMABLE MATERIAL
- 4 LAYER OF LIGHTWEIGHT CONCRETE
- 5 PIPE-WORK
- 6 CONCRETE SLAB

Fig. 2

INSULATION LAYER

- 1 SCREED ≥ 4 cm THICK WITH ELECTRIC-WELDED MESH
- 2 POLYETHYLENE SHEET
- 3 DEFORMABLE MATERIAL
- 4 THERMAL/ACOUSTIC INSULATION LAYER
- 5 CONCRETE SLAB

Fig. 3



Requirements and characteristics of the reinforcement by class of the insulation layer

SCREED Thickness	Reinforcement
4 cm	Also without reinforcement
4 cm	50x50 mm mesh, $\varnothing = 2$ mm
5 cm	Also without reinforcement
4 cm	50x50 mm mesh, $\varnothing = 2$ mm
5 cm	Also without reinforcement
4 cm	100x100 mm mesh, $\varnothing = 5$ mm
5 cm	50x50 mm mesh, $\varnothing = 2$ mm

Warning - the reduction in thickness of the insulation layer due to compressive force of a "standard" load according to French norms.



Mapei solutions for the installation of screeds for laying floors

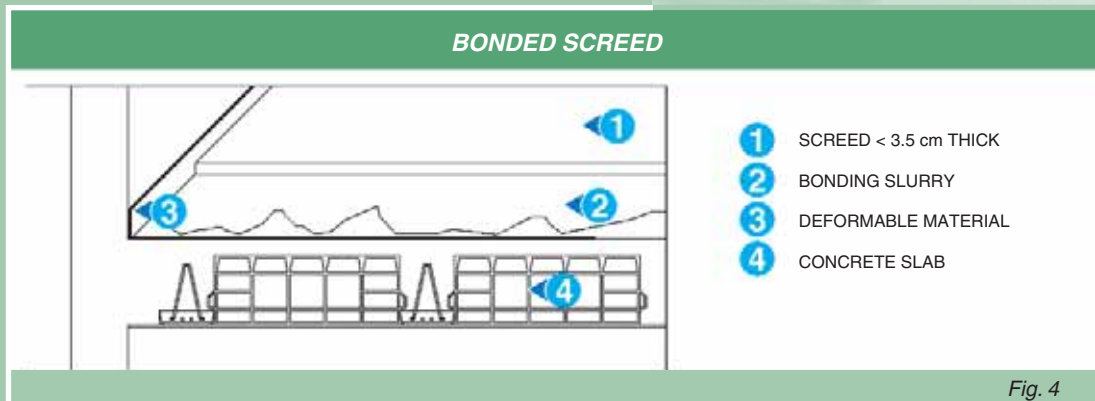

Tab. 2 - Recommended dosages for bonding slurries to improve the adhesion of the screed to the substrate

	Slurry* based on:				
	CEMENT	TOPCEM	TOPCEM PRONTO	MAPECEM	MAPECEM PRONTO
PLANICRETE (parts in weight)	1	1	1	1	1
WATER (parts in weight)	1	1	1	1	1
PRE-PACKED BINDER or MORTAR (parts in weight)	2	3	12	2	8

* For structures subject to heavy mechanical stress, use EPORIP, epoxy adhesive, to bond the screed to the reinforced concrete structure.

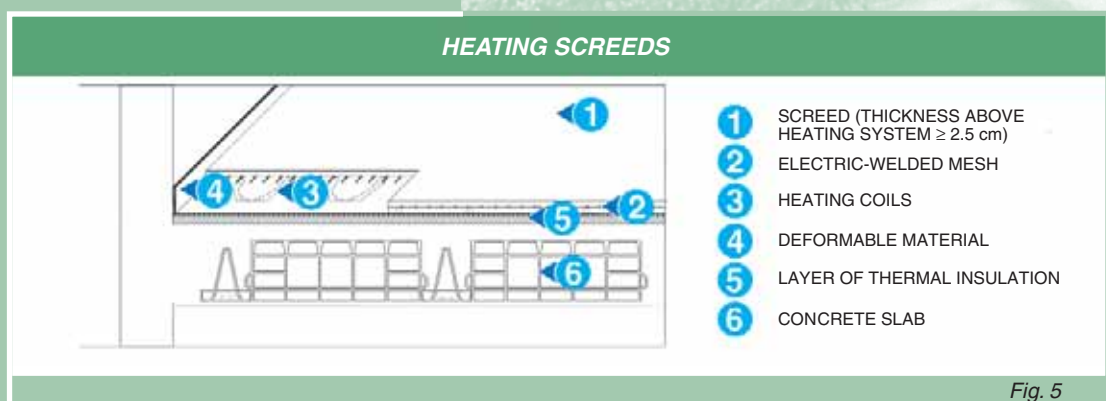

Tab. 3 - Waiting times according to the type of binder used in the screed (approx. 4 cm) before carrying out the testing cycle of the under-floor heating system

Cement + aggregate + water + MAPEFLUID N200	Cement + aggregate + water + MAPEFLUID PZ500	TOPCEM PRONTO + water	TOPCEM aggregate + water	MAPECEM + aggregate + water	MAPECEM PRONTO + water
21 days	14 days	4 days	4 days	1 day	1 day

	Screeds made with:			
	TOPCEM	TOPCEM PRONTO	MAPECEM	MAPECEM PRONTO
Recommended dosage (kg/m³)	200-250	-	350-450	-
Residual moisture (%)				
- after 24 hours	< 3.5	< 3.5	< 2	2
- after 3 days	-	-	<1.6	1.6
- after 4 days	< 2	< 2	-	-
Waiting time before applying smoothing compounds	1 to 4 days	1 to 4 days	4 hours	4 hours
Waiting time before laying floor covering				
- ceramic	24 hours +	24 hours	3 to 4 hours +	3 to 4 hours
- marble	2 days +	2 days	3 to 4 hours +	3 to 4 hours
- wood**	4 days +	4 days	24 hours +	24 hours
Compressive/flexural strength (N/mm²)				
- after 24 hours	> 8/3	> 8/3	> 30/5	> 40/6
- after 3 days	-	-	> 40/6.5	> 50/7
- after 4 days	> 15/4	> 15/4	-	-
- after 7 days	> 22/5	> 22/5	-	-
- after 28 days	> 30/6	> 30/6	> 45/7	> 62/7
+ The waiting time can be longer if when making the screeds aggregate graded less than the suggested 0-8 mm is used or if more mixing water is used.				
* At +23°C, 50% R.H.				
** When laying wooden floor coverings, check the level of moisture with a carbide hygrometer to make sure that it is lower than the value recommended by the manufacturer of the coverings.				





Mapei Group

Europe



AUSTRIA - Mapei GmbH
Fräuleinmühle 2
A - 3134 Nußdorf ob der Traisen
Tel. +43-2783-8891
Fax +43-2783-8893
Internet: <http://www.mapei.at>
E-mail: office@mapei.at
Plant in Traismauer
Distribution centres in Wien, Hall in Tirol and Graz



BENELUX - Mapei Benelux SA/NV
Zoning Industriel
Rue de l'Avenir, 40
B - 4460 Grâce-Hollogne
Tel. +32-4-2397070
Fax +32-4-2397071
Internet: <http://www.mapei.be>
E-mail: mapei@mapei.be
For the Netherlands:
Tel. +31-43-3510498
Fax +31-43-3510499



CROATIA - Mapei Croatia d.o.o.
Visnjevac 18 - 10000 Zagreb
Tel. +385-1-3647789
Fax +385-1-3647787
Internet: <http://www.mapei.com>
E-mail: mapei@mapei.hr



CZECH REPUBLIC
Mapei spol. s r.o.
Smetanova 192 - 77211 Olomouc
Tel. +420-585224580
Fax +420-585227209
Internet: <http://www.mapei.cz>
E-mail: info@mapei.cz
Distribution centre in Prague



FRANCE - Mapei France SA
Zone Industrielle du Terroir
Avenue Léon Jouhaux, 29
31140 Saint Alban
Tel. +33-5-61357305
Fax +33-5-61357314
Internet: <http://www.mapei.fr>
E-mail: mapei@mapei.fr
Plants in Saint Alban and Montgru Saint Hilaire



GERMANY - Mapei GmbH
Bahnhofsplatz 10 - 63906 Erlenbach
Tel. +49-9372-98950
Fax +49-9372-989548
Internet: <http://www.mapei.de>
E-mail: mailto@mapei.de
Plant in Weferlingen



GREAT BRITAIN - Mapei U.K. Ltd
Mapei House -
Steel Park Road - Halesowen
West Midlands B62 8HD
Tel. +44-121-5086970
Fax +44-121-5086960
Internet: <http://www.mapei.com>
E-mail: sales@mapei.co.uk
Plant in Halesowen



GREECE - Mapei Hellas SA
Papadiamantopoulou 24 C
11528 Athens
Tel. +30-210-7472983
Fax +30-210-7472953
Internet: <http://www.mapei.gr>
E-mail: mapeihellas@mapei.gr



HUNGARY - Mapei Kft
Sport Utca 2 - 2040 Budaörs
Tel. +36-23-501667
Fax +36-23-501666
Internet: <http://www.mapei.hu>
E-mail: mapei@mapei.hu
Plant in Sósút
Distribution centres in Győr, Kaposvár and Miskolc



NORWAY - Rescon Mapei AS
Vallsetvegen 6 - 2120 Sagstua
Tel. +47-62-972000
Fax +47-62-972099
Internet: <http://www.resconmapei.com>
E-mail: post@resconmapei.no
Plant in Sagstua



POLAND - Mapei Polska Spzoo
ul. Gustawa Eiffel'a, 14 - 44-109 Gliwice
Tel. +48-32-7754450
Fax +48-32-7754471
Sales office:
Chałubińskiego Street 8, 00-613 Warsaw
Tel. +48-22-5954200
Fax +48-22-5954202
Internet: <http://www.mapei.pl>
E-mail: info@mapei.pl
Plant in Gliwice



PORTUGAL - Lusomapei S.A.
Business Parque Tejo XXI
Estrada Nacional 1 - Km 19,65, Gelfas
2600-659 Castanheira do Ribatejo
Tel. +351 263 860 360
Fax +351 263 860 369
Internet: <http://www.mapei.pt>
E-mail: geral@mapei.pt
Plant in Anadia



ROMANIA - Mapei Romania SRL
14 Gen. Ion Dragalina
Str. Sector 5 - Bucarest
Tel. +40-21-3117819
Fax +40-21-3117821
Internet: <http://www.mapei.ro>
E-mail: info@mapei.ro



RUSSIAN FEDERATION - ZAO Mapei
Derbenevskaya nab., 7,
building 4, 3-d floor
Moscow 113114 Russian Federation
Tel. +7-495-258-5520
Fax +7-495-258-5521
Internet: <http://www.mapei.ru>
E-mail: info@mapei.ru
Plants in Stupino



SLOVAK REPUBLIC - Mapei SK sro
Nádražná 39, 900 28 Ivánka pri Dunaji
Tel. +421-2-53414 705 / 53414 702
Fax +421-2-5363 2692
Internet: <http://www.mapei.sk>
E-mail: office@mapei.sk



SLOVENIA - Mapei doo
Kočevarjeva 2 - 8000 Novo Mesto
Tel. +386-1-7865050/51
Fax +386-1-7865055
Internet: <http://www.mapei.si>
E-mail: mapei@mapei.si
Distribution centre in Grosuplje



SPAIN - Ibermapei SA
Plaza Cataluña, 20 - 5ª Planta
08002 Barcelona
Tel. +34-93-3435050
Fax +34-93-3024229
Internet: <http://www.mapei.es>
E-mail: ibermapei@ibermapei.es
Plants in Amposta (Tarragona) and Cabanillas del Campo (Guadalajara)
Distribution centres in Badalona (Barcelona), Onda (Castellón) and Marratxi (Mallorca)



SWEDEN - Rescon Mapei AB
Gelbgjutarevägen 6 - 17148 Solna
Tel. +46-8-52509080
Fax +46-8-52509086
Internet: <http://www.mapei.se>
E-mail: info@mapei.se



SWITZERLAND - Mapei Suisse SA
1642 Sorens / FR
Tel. +41-26-9159000
Fax +41-26-9159003
Internet: <http://www.mapei.ch>
E-mail: info@mapei.ch
Plant in Sorens



UKRAINE - Mapei Ukraina LLC
01014, Città di Kiev
Ulica Strutinskogo, 8 - 8 Etazh.
Tel. +38-044-5024560, 5024563
Fax +38-044-5024566
Internet: <http://www.mapei.ua>
E-mail: mapei@mapei.ua



HEAD OFFICE

MAPEI SpA

Via Cafiero, 22
20158 Milan (Italy)
Tel. +39-02-37673.1
Fax +39-02-37673.214
<http://www.mapei.com>
E-mail: mapei@mapei.it

PLANTS

- Strada Provinciale 159 -
20060 Robbiano di Mediglia (Milan)
Tel. +39-02-906911 - Fax +39-02-90660575
- Via Mediana S.S. 148 km 81,3 - 04100 Latina
Tel. +39-0773-2548 - Fax +39-0773-250391

DISTRIBUTION CENTRE

SASSUOLO
Via Valle D'Aosta, 46 - 41049 Sassuolo (Modena)
Tel. +39-0536-803116 - Fax +39-0536-805255

Office in Rome

Viale Libano, 28 - 00144 Rome
Tel. +39-06-5929211 - Fax +39-06-59290337

Office in Lecce

Via Orsini del Balzo, 24 - 73100 Lecce
Tel. +39-0832-246551 - Fax +39-0832-248472
E-mail: ufficio.lecce@mapei.it

Asia-Oceania



AUSTRALIA - Mapei Australia Pty Ltd
12 Parkview Drive Archerfield
Brisbane - Queensland 4108
Tel. +61-7-3276 5000
Fax +61-7-3276 5076
Internet: <http://www.mapei.com.au>
E-mail: mapei@mapei.com.au
Plant in Brisbane



CHINA
Mapei Construction Materials
(Guangzhou) co. Ltd.
Hong Fu Loi International Building
Rm. 2003-2004, Yan Jiang Zhong Road
Guangzhou P.R. China
Tel. (86-20) 83653489
Fax (86-20) 83653481
E-mail: mapei-gz@mapei-gz.com
Plant in Conghua (Guangzhou)

CHINA
Mapei Construction Materials
(Shanghai) co. Ltd.
6, Lane 8999, Hunan Road,
Nanhui District 201314
Shanghai P.R. China
Tel. (86-21) 58180808
Fax (86-21) 58180909
E-mail: mapei-sh@mapei-sh.com
Plant in Nanhui (Shanghai)

HONG KONG S.A.R.
Mapei China Ltd
Suite 15, L22 Office Tower,
Langham Place
8 Argyle Street, Mongkok,
Kowloon, Hong Kong
Tel. +852-21486816
Fax +852-25121328
Internet: <http://www.mapei.com.hk>
E-mail: mapei@mapei.com.hk



MALAYSIA
Mapei (Malaysia) Sdn Bhd
PT 521, Batu 23 - Jalan Rawang
Jalan Batang Berjantai
48000 Rawang - Selangor Darul Ehsan
Tel. +60-3-60935799
Fax +60-3-60915801
Internet: <http://www.mapei.com.sg>
E-mail: mapei@tm.net.my
Plant in Rawang (Kuala Lumpur)



NEW ZEALAND - Mapei New Zealand
30 Fisher Crescent - Mt. Wellington
Auckland, New Zealand
Tel. +64-9-9211994
Fax +64-9-9211993
Internet: <http://www.mapei.co.nz>
E-mail: info@mapei.co.nz



SINGAPORE - Mapei Far East Pte Ltd
28, Tuas West Road
638383 Singapore
Tel. +65-68623488
Fax +65-68621012 / 68621013
Internet: <http://www.mapei.com.sg>
E-mail: mapei@mapei.com.sg
Plant in Singapore



UNITED ARAB EMIRATES
I.B.S. (Innovative Building Solutions)
L.L.C.
P.O. Box 73869, Dubai, UAE
Tel. +971-4-3233167
Fax +971-4-3233725
Plant in Dubai



VIETNAM - Mapei Vietnam Ltd.
Plot 8, Street No. 4,
Northern Part of Chu Lai I.Z.
Tam Hiep Commune
Nui Thanh District - Vietnam
Tel. (84-510) 565801-7
Fax (84-510) 565800
Branch in Hanoi:
Tel. (84-4) 9287924-6
E-mail: mapeihn@mapei.com.vn
Branch in Danang:
Tel. (84-511) 3565001
E-mail: mapeidn@mapei.com.vn
Branch in Ho Chi Minh City:
Tel. (84-8) 8206103-4-6
E-mail: mapeihcm@mapei.com.vn
Plant in Chu Lai (Quangnam)

The Americas



ARGENTINA - Mapei Argentina SA
Rondeau 51, 1° floor, Wilde
Buenos Aires
Tel. +54-11-42070009
Fax +54-11-42171088
Internet: <http://www.mapei.com.ar>
Plant in Buenos Aires



CANADA - Mapei Canada Inc
2900, Francis Hughes Avenue
Laval - QUE H7L3J5
Tel. +1-450-6621212
Fax +1-450-6620444
Internet: <http://www.mapei.com>
Plants in Vancouver, Laval, Maskinongé
and Toronto



PUERTO RICO - Mapei Caribe Inc
Road 2 km 26.2 BO. Espinosa
Dorado, Porto Rico 00646
Tel. +1-787-270-4162
Fax +1-787-270-4135
Internet: <http://www.mapei.com>
Plant in Dorado







U.S.A. - Mapei Corp
1144 East Newport Center Drive
Deerfield Beach, Florida 33442
Tel. +1-954-246-8888 / +1-888-300-4422
Fax +1-954-246-8800
Internet: <http://www.mapei.com>
Plants in Phoenix (AZ), Garland (TX),
South River (NJ), Fort Lauderdale (FL),
West Chicago (IL), Fredericksburg (VA),
San Bernardino (CA)
Distribution centre in Anaheim (CA)



VENEZUELA
Mapei de Venezuela CA
Calle Orinco Torre D&D PB Lc 11-12
Urb. Las Mercedes - 1071 Caracas
Tel. +58-212-991-1797/+58-212-9919423
Fax +58-212-991-7623
Internet: <http://www.mapei.com>
E-mail: mapeivenezuela@hotmail.com
Plant in Caracas

For more information on Mapei visit www.barbourproductsearch.info

MAPEI PRODUCT CERTIFICATIONS FOR THE INSTALLATION OF RESILIENT, TEXTILE AND WOOD COVERINGS

PRODUCT					
Adesilex UP71				•	•
Aquacol T			•		•
Eco Prim PU 1K				•	•
Eco Prim PU 1K Turbo				•	•
Eco Prim T			•		•
Fiberplan	CT-C25-F7 A2 _n				
Granirapid			•		•
Mapecem Pronto	CT-C60-F10 A1 _n				
Mapecryl Eco			•		•
Mapefluid N200		•			
Mapefluid PZ500		•			
Mapesilent Band					•
Mapesilent Door					•
Mapesilent Panel					•
Mapesilent Roll					•
Mapesilent Tape					•
Nivorapid	CT-C40-F10 A2 _n			•	•
Novoplan 21	CT-C20-F7 A2 _n				
Pianocem M	CT-C25-F7 A1 _n				
Planipatch			•		•
Plano 3	CT-C25-F7 A2 _n				
Primer G			•		•
Silwood			•		•
Topcem Pronto	CT-C30-F6 A1 _n				
Ultrabond Aqua-Contact Cork			•		•
Ultrabond Eco 170			•		•
Ultrabond Eco 185			•		•
Ultrabond Eco 350			•		•
Ultrabond Eco 380			•		•
Ultrabond Eco 520			•		•
Ultrabond Eco 540			•		•
Ultrabond Eco Fix			•		•
Ultrabond Eco P992 1K			•		•
Ultrabond Eco S955 1K				•	•
Ultrabond Eco V4 Conduttivo			•		•
Ultrabond Eco V4 SP			•		•
Ultrabond Eco VS90			•		•
Ultrabond P990 1K				•	•
Ultrabond Turf PU 1K				•	•
Ultrabond Turf PU 2K				•	•
Ultraplan	CT-C30-F7 A2 _n		•		•
Ultraplan Eco	CT-C25-F7 A2 _n		•		•
Ultraplan Maxi	CT-C35-F7 A2 _n		•		•



*PETRUZZELLI THEATRE - Bari - Italy
Installation of wall coverings with ADESILEX MT32,
bonding of wood with ULTRABOND P990 1K on screeds
in TOPCEM PRONTO and ECO PRIM PU 1K*



PRODUCTS FOR THE INSTALLATION OF RESILIENT, TEXTILE AND WOOD FLOOR AND WALL COVERINGS

HEAD OFFICE

Mapei S.p.A.

Via Cafiero, 22 - 20158 Milan - Italy

Tel. +39-02-37673.1

Fax +39-02-37673.214

www.mapei.com

mapei@mapei.it