

MATERIAL CHARACTERISTICS

POLYMER CONCRETE	on a Polyester resin basis, with mineral fillers, additives
COMPRESSIVE STRENGTH	≥ 90 N/mm ²
BENDING STRENGTH	≥ 22 N/mm ²
ELASTICITY MODULE	25,000 – 35,000 N/mm ²
DENSITY	2,1 – 2,3 kg/dm ³
COEFFICIENT OF LINEAR EXPANSION	Approx. 1.45 x 10 ⁻⁵ 1/K
HEAT RESISTANCE	100°C continuous load, up to 200°C with a load duration up to 5 min.
FROST RESISTANCE	- 50 °C
WATER ABSORPTION	< 0.05% DIN 52 103 (A)

PURPOSE OF USE

Component for the line drainage of surfaces in order to collect, transport and discharge rainwater from adjacent fixed surfaces.

DESIGN

- / Length 500 and 1000 mm
- / Length 1000 mm, /A including formed-in drain socket
- / Constructive height 230, 280, 330 and 380 mm
- / Shallow channel with constructive height 100 mm
- / Sloped channels up to 20 metres, constructive height 230 - 330 mm

ACCESSORIES

- / Gully for pipe connection Ø 160 mm
- / Gully for pipe connection Ø 200 mm
- / End cap closed for shallow channel
- / End cap closed, height adjustable for all constructive heights 230 – 380 mm
- / End cap with connection piece Ø 160 mm, fixed height for constructive heights 230, 280, 330 and 380 mm

EDGE PROTECTION

- / Strip galvanized steel
- / Stainless steel
- / Ductile iron
- / Edge thickness 4 mm

** Not suitable for the diagonal or transverse travel of motorways and highways.

MEADRAIN S NA and SVF / SEF 2000

A 15, B 125, C 250, D 400**, E 600**

nominal width 200

MEADRAIN SVF 2000 SHALLOW POLYMER CONCRETE DRAINAGE CHANNEL

WITH 4 MM EDGE PROTECTION MADE OF GALVANISED STEEL, SEALING JOINT ACCORDING TO EN 1433

Clear width of the drainage channel body 200 mm, total width 233 mm. For the realization of water level slopes. Suitable for all channel covers **MEA 200 CLIPFIX** with longitudinal shift protection and **MEA TSH 200 TOPSLOT**. Loading classes A 15 to E 600** according to EN 1433. Load capacity according to MEA installation instructions.

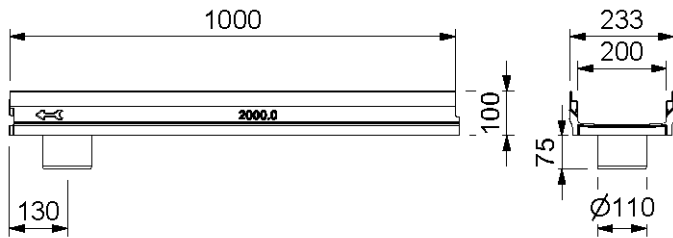

010713438

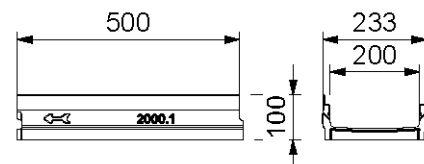

010713436

MEADRAIN SVF 2000 DRAINAGE CHANNEL BODY WITHOUT FALL, LOADING CLASSES A 15 TO E 600** ACCORDING TO EN 1433

Designation	Order No.	Length [mm]	Constructive height [mm]	kg/unit
MEADRAIN SVF 2000.0/100 Drainage channel body ¹⁾	010713434	1000	100	20,48
MEADRAIN SVF 2000.0 A/100 Drainage channel body with tight formed-in flanged drain socket Ø 110 mm ⁸⁾	010713438	1000	100	19,80
MEADRAIN SVF 2000.1/100 Drainage channel body ¹⁾	010713436	500	100	9,52

** Not suitable for the diagonal or transverse travel of motorways and highways.

1) Connection option for vertical drain Ø 110 mm

8) With tight formed-in drain socket Ø 110 mm

MEADRAIN S NA and SVF / SEF 2000

A 15, B 125, C 250, D 400**, E 600**

nominal width 200

MEADRAIN SV 2000 POLYMER CONCRETE DRAINAGE CHANNEL

WITH 4 MM EDGE PROTECTION MADE OF GALVANISED STEEL, SEALING JOINT ACCORDING TO EN 1433

Clear width of the drainage channel body 200 mm, total width 233 mm. Suitable for all channel covers **MEA 200**

CLIPFIX with longitudinal shift protection and **MEA TSH 200 TOPSLOT**. Loading classes A 15 to E 600** according to EN 1433. Load capacity according to MEA installation instructions.

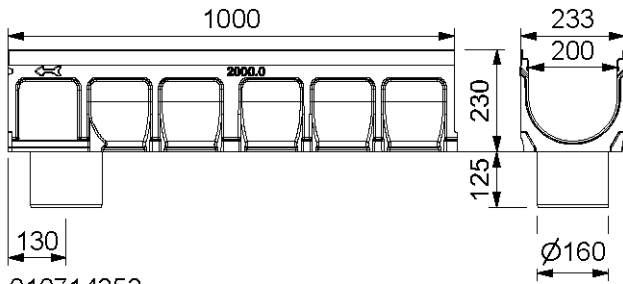

010714252

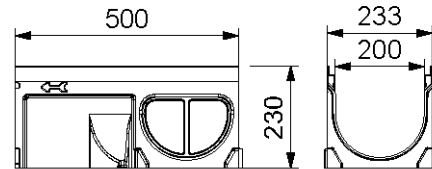

010714254

MEADRAIN SV 2000 NA DRAINAGE CHANNEL BODY WITHOUT FALL, LOADING CLASSES A 15 TO E 600** ACCORDING TO EN 1433

Designation	Order No.	Length [mm]	Constructive height [mm]	kg/unit
NEW! MEADRAIN SV 2000.0 NA Drainage channel ⁵⁾	010714250	1000	230	28,67
NEW! MEADRAIN SV 2000.0/A NA Drainage channel with tight formed-in flanged drain socket Ø 160 mm ⁹⁾	010714252	1000	230	28,67
NEW! MEADRAIN SV 2000.1 NA Drainage channel ^{5) 14)}	010714254	500	230	14,68
NEW! MEADRAIN SV 2010.0 NA Drainage channel ⁵⁾	010714256	1000	280	32,10
NEW! MEADRAIN SV 2010.0/A NA Drainage channel with tight formed-in flanged drain socket Ø 160 mm ⁹⁾	010714258	1000	280	32,60
NEW! MEADRAIN SV 2010.1 NA Drainage channel ^{5) 14)}	010714260	500	280	16,30
NEW! MEADRAIN SV 2020.0 NA Drainage channel ⁵⁾	010714262	1000	330	36,23
NEW! MEADRAIN SV 2020.0/A NA Drainage channel with tight formed-in flanged drain socket Ø 160 mm ⁹⁾	010714264	1000	330	36,20
NEW! MEADRAIN SV 2020.1 NA Drainage channel ^{5) 14)}	010714266	500	330	16,50
NEW! MEADRAIN SV 2030.0 NA Drainage channel ⁵⁾	010714268	1000	380	39,50
NEW! MEADRAIN SV 2030.0/A NA Drainage channel with tight formed-in flanged drain socket Ø 160 mm ⁹⁾	010714270	1000	380	40,00
NEW! MEADRAIN SV 2030.1 NA Drainage channel ^{5) 14)}	010714272	500	380	16,90

** Not suitable for the diagonal or transverse travel of motorways and highways.

5) Connection option for vertical drain Ø 160 mm (drainage preformation), end caps with connector or to gullies/silt boxes.

9) With tight formed-in drain socket Ø 160 mm 14) Connection option for corner-, t- and cross- connections.

MEADRAIN S NA and SVF / SEF 2000

A 15, B 125, C 250, D 400**, E 600**

nominal width 200

MEADRAIN SV 2000 POLYMER CONCRETE DRAINAGE CHANNEL

WITH 4 MM EDGE PROTECTION MADE OF GALVANISED STEEL, SEALING JOINT ACCORDING TO EN 1433

Clear width of the channel body 200 mm, total width 233 mm. Suitable for all channel covers **MEA 200 CLIPFIX** with longitudinal shift protection and **MEA TSH 200 TOPSLOT**. For the realization of linear fall (with fall 0,5%). Loading classes A 15 to E 600** according to EN 1433. Load capacity according to MEA installation instructions.

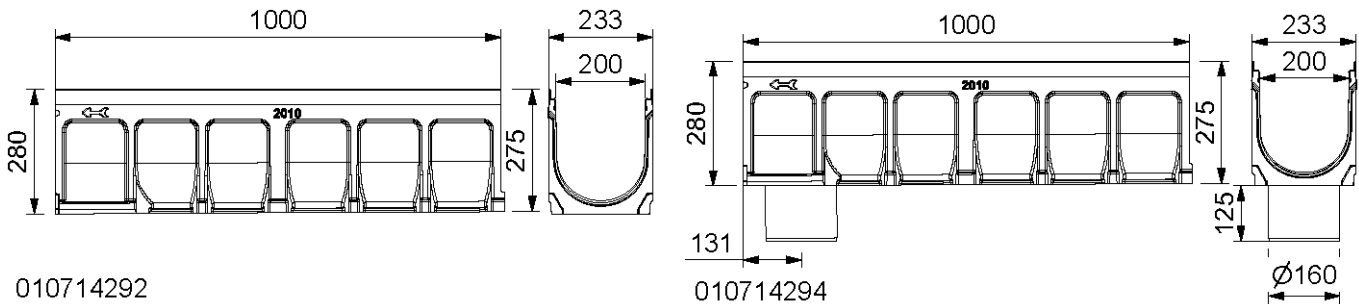

010714292

010714294

MEADRAIN SV 2000 NA DRAINAGE CHANNEL BODY WITH 0,5% FALL, LOADING CLASSES A 15 TO E 600** ACCORDING TO EN 1433

Designation	Order No.	Length [mm]	Constructive height [mm]	Height 2 [mm]	kg/unit
NEW! MEADRAIN SV 2001 NA Drainage channel body	010714274	1000	230	235	28,73
NEW! MEADRAIN SV 2002 NA Drainage channel body	010714276	1000	235	240	29,05
NEW! MEADRAIN SV 2003 NA Drainage channel body	010714278	1000	240	245	29,36
NEW! MEADRAIN SV 2004 NA Drainage channel body	010714280	1000	245	250	29,68
NEW! MEADRAIN SV 2005 NA Drainage channel body	010714282	1000	250	255	30,00
NEW! MEADRAIN SV 2006 NA Drainage channel body	010714284	1000	255	260	30,32
NEW! MEADRAIN SV 2007 NA Drainage channel body	010714286	1000	260	265	30,63
NEW! MEADRAIN SV 2008 NA Drainage channel body	010714288	1000	265	270	30,95
NEW! MEADRAIN SV 2009 NA Drainage channel body	010714290	1000	270	275	31,27
NEW! MEADRAIN SV 2010 NA Drainage channel body ⁵⁾	010714292	1000	275	280	31,90
NEW! MEADRAIN SV 2010 NA Drainage channel with tight formed-in flanged drain socket Ø 160 mm ⁹⁾	010714294	1000	275	280	31,90
NEW! MEADRAIN SV 2011 NA Drainage channel body	010714296	1000	280	285	32,22
NEW! MEADRAIN SV 2012 NA Drainage channel body	010714298	1000	285	290	32,53
NEW! MEADRAIN SV 2013 NA Drainage channel body	010714300	1000	290	295	32,85
NEW! MEADRAIN SV 2014 NA Drainage channel body	010714302	1000	295	300	33,17
NEW! MEADRAIN SV 2015 NA Drainage channel body	010714304	1000	300	305	33,49
NEW! MEADRAIN SV 2016 NA Drainage channel body	010714306	1000	305	310	33,80
NEW! MEADRAIN SV 2017 NA Drainage channel body	010714308	1000	310	315	34,12
NEW! MEADRAIN SV 2018 NA Drainage channel body	010714310	1000	315	320	34,44
NEW! MEADRAIN SV 2019 NA Drainage channel body	010714312	1000	320	325	34,75
NEW! MEADRAIN SV 2020 NA Drainage channel body ⁵⁾	010714314	1000	325	330	35,07
NEW! MEADRAIN SV 2020 NA Drainage channel with tight formed-in flanged drain socket Ø 160 mm ⁹⁾	010714316	1000	325	330	35,07

** Not suitable for the diagonal or transverse travel of motorways and highways.

5) Connection option for vertical drain Ø 160 mm (drainage preformation), end caps with connector or to gullies/silt boxes.

9) With tight formed-in drain socket Ø 160 mm

MEADRAIN SV 2000 AND SVF 2000 ACCESSORIES

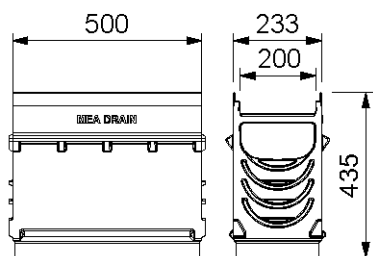

010713880

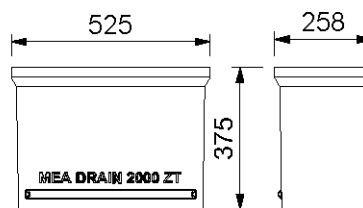

010154708

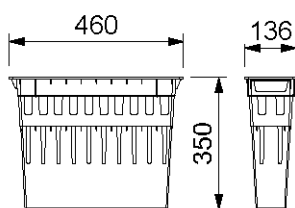

010710153

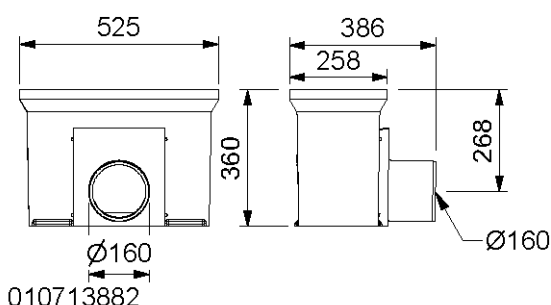

010713882

MEADRAIN SV 2000 GULLY**

Designation	Order No.	Length [mm]	Constructive height [mm]	kg/unit
NEW! MEADRAIN SV 2000.SK-OT NA Gully upper part with sealing rebate and boltless locking device	010713880	500	435	14,40
NEW! MEADRAIN 2000 SK-ZT gully intermediate part made of polymer concrete for a height extension	010154708	-	375	22,00
MEA 150/200 sediment bucket made of plastic*	010710153	-	-	3,10
NEW! MEADRAIN SK-UT-SHORT/A Gully lower part, with integrated drain socket Ø 160 mm	010713882	525	360	23,10
NEW! MEADRAIN SK-UT-SHORT/A Gully lower part, with integrated drain socket Ø 200 mm	010713883	525	360	23,10

* Delivery time on demand

** Not suitable for the diagonal or transverse travel of motorways and highways.

MEADRAIN S NA and SVF / SEF 2000

A 15, B 125, C 250, D 400**, E 600**

nominal width 200



BUILDING SUCCESS

MEADRAIN SV 2000 AND SVF 2000 ACCESSORIES

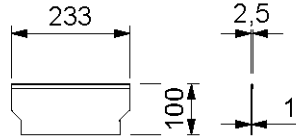

010713440

MEADRAIN SVF 2000 END CAP FOR SHALLOW CHANNEL

Designation	Order No.	Material	kg/unit
MEADRAIN SVF 2000.SE End cap for shallow channel start/end	010713440	Galv. steel	0,20

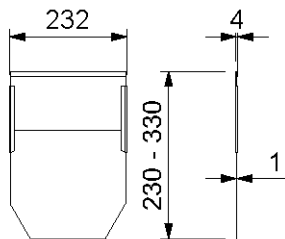

010714318

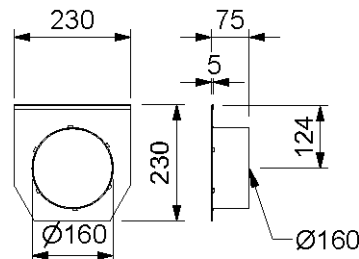

010714322

MEADRAIN SV/SG 2000 NA END CAPS AND ACCESSORIES

Designation	Order No.	Material	kg/unit
NEW! MEADRAIN SV/SG 2000-10.SE NA End cap for channel start/end, height adjustable	010714318	Galv. steel	0,77
NEW! MEADRAIN SV/SG 2010-30.SE NA End cap for channel start/end, height adjustable	010714320	Galv. steel	0,77
NEW! MEADRAIN SV/SG 2000.E NA End cap for channel end, fixed height with connection piece Ø 160 mm	010714322	Galv. steel	1,03
NEW! MEADRAIN SV/SG 2010.E NA End cap for channel end, fixed height with connection piece Ø 160 mm	010714324	Galv. steel	1,03
NEW! MEADRAIN SV/SG 2020.E NA End cap for channel end, fixed height with connection piece Ø 160 mm	010714326	Galv. steel	1,50
NEW! MEADRAIN SV/SG 2030.E NA End cap for channel end, fixed height with connection piece Ø 160 mm	010714328	Galv. steel	1,60

** Not suitable for the diagonal or transverse travel of motorways and highways.

5) Connection option for vertical drain Ø 160 mm (drainage preformation), end caps with connector or to gullies/silt boxes.

MEADRAIN S NA and SVF / SEF 2000

A 15, B 125, C 250, D 400**, E 600**

nominal width 200

MEADRAIN SEF 2000 SHALLOW POLYMER CONCRETE DRAINAGE CHANNEL WITH 4 MM EDGE PROTECTION MADE OF STAINLESS STEEL, SEALING JOINT ACCORDING TO EN 1433

Clear width of the channel body 200 mm, total width 233 mm. For the realization of water level slopes. Suitable for all channel covers **MEA 200 CLIPFIX** with longitudinal shift protection and **MEA TSH 200 TOPSLOT**. Loading classes A 15 to E 600** according to EN 1433. Load capacity according to MEA installation instructions.

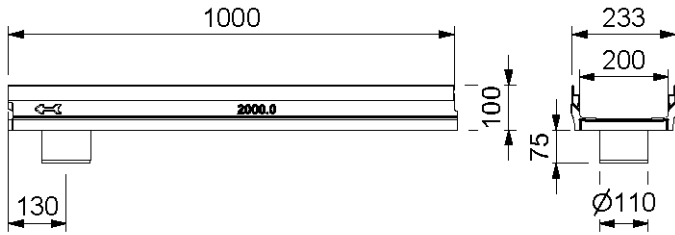

010713456

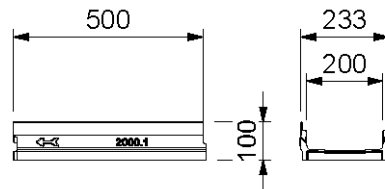

010713454

MEADRAIN SEF 2000 DRAINAGE CHANNEL BODY WITHOUT FALL, LOADING CLASSES A 15 TO E 600** ACCORDING TO EN 1433

Designation	Order No.	Length [mm]	Constructive height [mm]	kg/unit
MEADRAIN SEF 2000.0/100 Drainage channel body* 1)	010713452	1000	100	19,89
MEADRAIN SEF 2000.0 A/100 Drainage channel with tight formed-in flanged drain socket Ø 110 mm* 8)	010713456	1000	100	19,86
MEADRAIN SEF 2000.1/100 Drainage channel body* 1)	010713454	500	100	10,22

* Delivery time on demand

** Not suitable for the diagonal or transverse travel of motorways and highways.

1) Connection option for vertical drain Ø 110 mm

MEADRAIN S NA and SVF / SEF 2000

A 15, B 125, C 250, D 400**, E 600**

nominal width 200

MEADRAIN SE 2000 POLYMER CONCRETE DRAINAGE CHANNEL

WITH 4 MM EDGE PROTECTION MADE OF STAINLESS STEEL, SEALING JOINT ACCORDING TO EN 1433

Clear width of the drainage channel body 200 mm, total width 233 mm. For the realization of water level slopes. Suitable for the all channel covers **MEA 200 CLIPFIX** with longitudinal shift protection and **MEA TSH 200 TOPSLOT**. Loading classes A 15 to E 600** according to EN 1433. Load capacity according to MEA installation instructions.

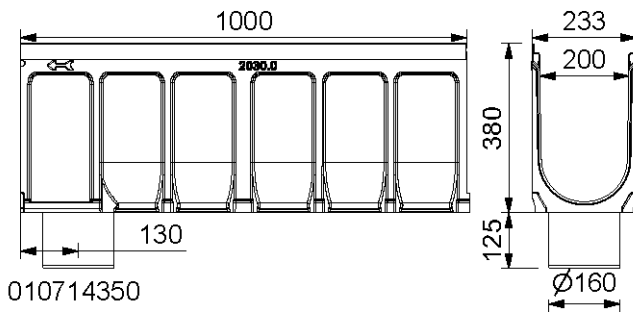

010714350

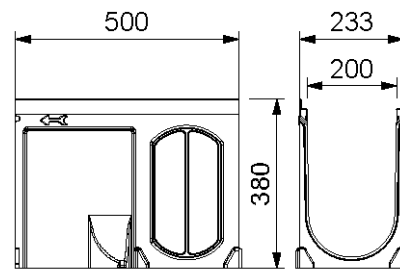

010714352

MEADRAIN SE 2000 NA DRAINAGE CHANNEL BODY WITHOUT FALL, LOADING CLASSES A 15 TO E 600** ACCORDING TO EN 1433

Designation	Order No.	Length [mm]	Constructive height [mm]	kg/unit
NEW! MEADRAIN SE 2000.0 NA Drainage channel* 5)	010714330	1000	230	28,67
NEW! MEADRAIN SE 2000.0/A NA Drainage channel with tight formed-in flanged drain socket Ø 160 mm* 9)	010714332	1000	230	28,67
NEW! MEADRAIN SE 2000.1 NA Drainage channel* 5) 14)	010714334	500	230	14,68
NEW! MEADRAIN SE 2010.0 NA Drainage channel* 5)	010714336	1000	280	32,10
NEW! MEADRAIN SE 2010.0/A NA Drainage channel with tight formed-in flanged drain socket Ø 160 mm* 9)	010714338	1000	280	32,60
NEW! MEADRAIN SE 2010.1 NA Drainage channel* 5) 14)	010714340	500	280	16,30
NEW! MEADRAIN SE 2020.0 NA Drainage channel* 5)	010714342	1000	330	36,23
NEW! MEADRAIN SE 2020.0/A NA Drainage channel with tight formed-in flanged drain socket Ø 160 mm* 9)	010714344	1000	330	36,20
NEW! MEADRAIN SE 2020.1 NA Drainage channel* 5) 14)	010714346	500	330	16,50
NEW! MEADRAIN SE 2030.0 NA Drainage channel* 5)	010714348	1000	380	39,50
NEW! MEADRAIN SE 2030.0/A NA Drainage channel with tight formed-in flanged drain socket Ø 160 mm* 9)	010714350	1000	380	40,00
NEW! MEADRAIN SE 2030.1 NA Drainage channel* 5) 14)	010714352	500	380	16,90

* Delivery time on demand

** Not suitable for the diagonal or transverse travel of motorways and highways.

5) Connection option for vertical drain Ø 160 mm (drainage preformation), end caps with connector or to gullies/silt boxes.

9) With tight formed-in drain socket Ø 160 mm

14) Connection option for corner-, t- and cross- connections.

MEADRAIN S NA and SVF / SEF 2000

A 15, B 125, C 250, D 400**, E 600**

nominal width 200

MEADRAIN SE 2000 POLYMER CONCRETE DRAINAGE CHANNEL WITH 4 MM EDGE PROTECTION MADE OF STAINLESS STEEL, SEALING JOINT ACCORDING TO EN 1433

Clear width of the channel body 200 mm, total width 233 mm. For the realization of linear fall (with fall 0,5%). Suitable for all channel covers **MEA 200 CLIPFIX** with longitudinal shift protection and **MEA TSH 200 TOPSLOT**. Loading classes A 15 to E 600** according to EN 1433. Load capacity according to MEA installation instructions.

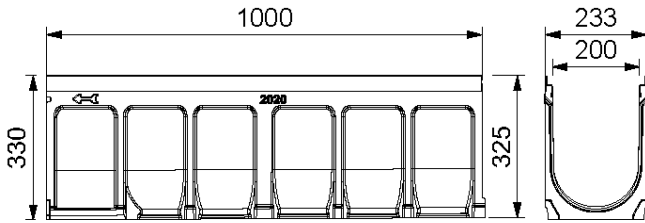

010714394

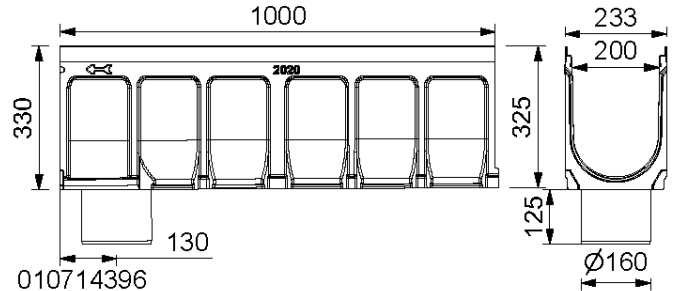

010714396

MEADRAIN SE 2000 NA DRAINAGE CHANNEL BODY, WITH 0,5% FALL, LOADING CLASSES A 15 TO E 600** ACCORDING TO EN 1433

Designation	Order No.	Length [mm]	Constructive height [mm]	Height 2 [mm]	kg/unit
NEW! MEADRAIN SE 2001 NA Drainage channel body*	010714354	1000	230	235	28,73
NEW! MEADRAIN SE 2002 NA Drainage channel body*	010714356	1000	235	240	29,05
NEW! MEADRAIN SE 2003 NA Drainage channel body*	010714358	1000	240	245	29,36
NEW! MEADRAIN SE 2004 NA Drainage channel body*	010714360	1000	245	250	29,68
NEW! MEADRAIN SE 2005 NA Drainage channel body*	010714362	1000	25	255	30,00
NEW! MEADRAIN SE 2006 NA Drainage channel body*	010714364	1000	255	260	30,32
NEW! MEADRAIN SE 2007 NA Drainage channel body*	010714366	1000	260	265	30,63
NEW! MEADRAIN SE 2008 NA Drainage channel body*	010714368	1000	26	270	30,95
NEW! MEADRAIN SE 2009 NA Drainage channel body*	010714370	1000	270	275	31,27
NEW! MEADRAIN SE 2010 NA Drainage channel body* ⁵⁾	010714372	1000	275	280	31,90
NEW! MEADRAIN SE 2010/A NA Drainage channel with tight formed-in flanged drain socket Ø 160 mm* ⁹⁾	010714374	1000	275	280	31,90
NEW! MEADRAIN SE 2011 NA Drainage channel body*	010714376	1000	280	285	32,22
NEW! MEADRAIN SE 2012 NA Drainage channel body*	010714378	1000	285	290	32,53
NEW! MEADRAIN SE 2013 NA Drainage channel body*	010714380	1000	290	295	32,85
NEW! MEADRAIN SE 2014 NA Drainage channel body*	010714382	1000	29	300	33,17
NEW! MEADRAIN SE 2015 NA Drainage channel body*	010714384	1000	300	305	33,49
NEW! MEADRAIN SE 2016 NA Drainage channel body*	010714386	1000	305	310	33,80
NEW! MEADRAIN SE 2017 NA Drainage channel body*	010714388	1000	310	315	34,12
NEW! MEADRAIN SE 2018 NA Drainage channel body*	010714390	1000	315	320	34,44
NEW! MEADRAIN SE 2019 NA Drainage channel body*	010714392	1000	320	325	34,75
NEW! MEADRAIN SE 2020 NA Drainage channel body* ⁵⁾	010714394	1000	325	330	35,07
NEW! MEADRAIN SE 2020/A NA Drainage channel with tight formed-in flanged drain socket Ø 160 mm* ⁹⁾	010714396	1000	325	330	35,07

* Delivery time on demand

** Not suitable for the diagonal or transverse travel of motorways and highways.

5) Connection option for vertical drain Ø 160 mm (drainage preformation), end caps with connector or to gullies/silt boxes

9) With tight formed-in drain socket Ø 160 mm

MEADRAIN SE 2000 AND SEF 2000 ACCESSORIES

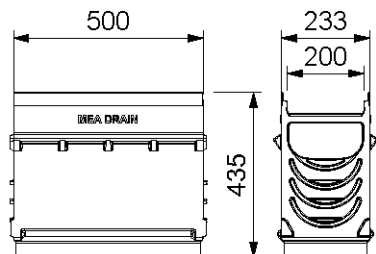

010713894

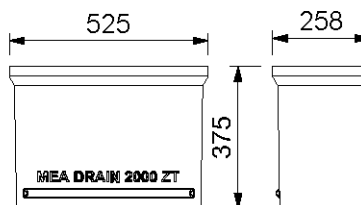

010154708

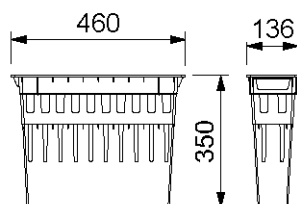

010710153

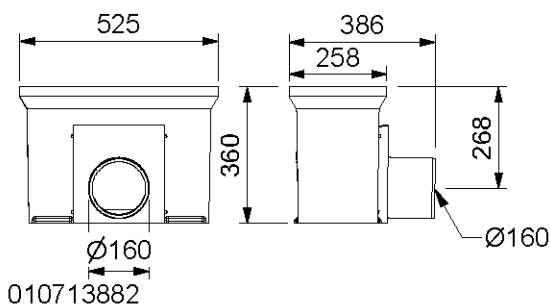

010713882

MEADRAIN SE 2000 GULLY**

Designation	Order No.	Length [mm]	Constructive height [mm]	kg/unit
NEW! MEADRAIN SE 2000.SK-OT NA Gully upper part with sealing rebate and boltless locking device*	010713894	500	255	14,40
NEW! MEADRAIN 2000 SK-ZT gully intermediate part made of polymer concrete for a height extension	010154708	-	375	22,00
MEA 150/200 sediment bucket made of plastic*	010710153	-	-	3,10
NEW! MEADRAIN SK-UT-SHORT/A Gully lower part, with integrated drain socket Ø 160 mm	010713882	525	360	23,10
NEW! MEADRAIN SK-UT-SHORT/A Gully lower part, with integrated drain socket Ø 200 mm	010713883	525	360	23,10

* Delivery time on demand

** Not suitable for the diagonal or transverse travel of motorways and highways.

MEADRAIN SE 2000 AND SEF 2000 ACCESSORIES

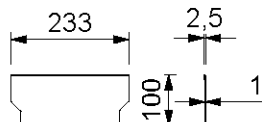

010713458

MEADRAIN SEF 2000 END CAP FOR SHALLOW CHANNEL

Designation	Order No.	Material	kg/unit
MEADRAIN SEF 2000.SE End cap for shallow channel start/end*	010713458	Stainl. steel	0,20

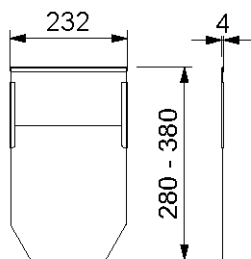

010714400

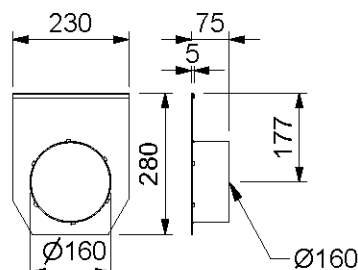

010714404

MEADRAIN SE 2000 NA END CAPS AND ACCESSORIES

Designation	Order No.	Material	kg/unit
NEW! MEADRAIN SE 2000-10.SE NA End cap for channel start/end, height adjustable*	010714398	Stainl. steel	0,77
NEW! MEADRAIN SE 2010-30.SE NA End cap for channel start/end, height adjustable*	010714400	Stainl. steel	0,77
NEW! MEADRAIN SE 2000.E NA End cap for channel end, fixed height with connection piece Ø 160 mm*	010714402	Stainl. steel	1,03
NEW! MEADRAIN SE 2010.E NA End cap for channel end, fixed height with connection piece Ø 160 mm*	010714404	Stainl. steel	1,03
NEW! MEADRAIN SE 2020.E NA End cap for channel end, fixed height with connection piece Ø 160 mm*	010714406	Stainl. steel	1,50
NEW! MEADRAIN SE 2030.E NA End cap for channel end, fixed height with connection piece Ø 160 mm*	010714408	Stainl. steel	1,60

* Delivery time on demand

** Not suitable for the diagonal or transverse travel of motorways and highways.

MEADRAIN S NA and SVF / SEF 2000

A 15, B 125, C 250, D 400**, E 600**

nominal width 200

MEADRAIN SG 2000 POLYMER CONCRETE DRAINAGE CHANNEL

WITH 4 MM EDGE PROTECTION MADE OF DUCTILE IRON, SEALING JOINT ACCORDING TO EN 1433

Clear width of the channel body 200 mm, total width 233 mm. For the realization of water level slopes. Suitable for all channel covers **MEA 200 CLIPFIX** with longitudinal shift protection and **MEA TSH 200 TOPSLOT**. Loading classes A 15 to E 600** according to EN 1433. Load capacity according to MEA installation instructions.

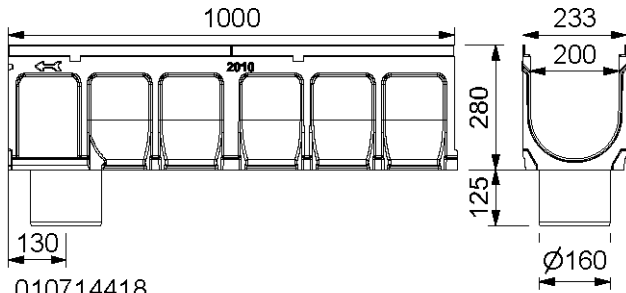

010714418

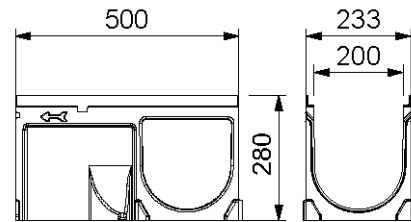

010714420

MEADRAIN SG 2000 NA DRAINAGE CHANNEL BODY WITHOUT FALL, LOADING CLASSES A 15 TO E 600** ACCORDING TO EN 1435

Designation	Order No.	Length [mm]	Constructive height [mm]	kg/unit
NEW! MEADRAIN SG 2000.0 NA Drainage channel ⁵⁾	010714410	1000	230	28,67
NEW! MEADRAIN SG 2000.0/A NA Drainage channel with tight formed-in flanged drain socket Ø 160 mm ⁹⁾	010714412	1000	230	28,67
NEW! MEADRAIN SG 2000.1 NA Drainage channel body ^{5) 14)}	010714414	500	230	14,68
NEW! MEADRAIN SG 2010.0 NA Drainage channel ⁵⁾	010714416	1000	280	32,10
NEW! MEADRAIN SG 2010.0/A NA Drainage channel with tight formed-in flanged drain socket Ø 160 mm ⁹⁾	010714418	1000	280	32,60
NEW! MEADRAIN SG 2010.1 NA Drainage channel body ^{5) 14)}	010714420	500	280	16,30
NEW! MEADRAIN SG 2020.0 NA Drainage channel ⁵⁾	010714422	1000	330	36,23
NEW! MEADRAIN SG 2020.0/A NA Drainage channel with tight formed-in flanged drain socket Ø 160 mm ⁹⁾	010714424	1000	330	36,20
NEW! MEADRAIN SG 2020.1 NA Drainage channel body ^{5) 14)}	010714426	500	330	16,50
NEW! MEADRAIN SG 2030.0 NA Drainage channel ⁵⁾	010714428	1000	380	39,50
NEW! MEADRAIN SG 2030.0/A NA Drainage channel with tight formed-in flanged drain socket Ø 160 mm ⁹⁾	010714430	1000	380	40,00
NEW! MEADRAIN SG 2030.1 NA Drainage channel body ^{5) 14)}	010714432	500	380	16,90

** Not suitable for the diagonal or transverse travel of motorways and highways.

5) Connection option for vertical drain Ø 160 mm (drainage preformation), end caps with connector or to gullies/silt boxes.

9) With tight formed-in drain socket Ø 160 mm

14) Connection option for corner-, t- and cross- connections.

MEADRAIN S NA and SVF / SEF 2000

A 15, B 125, C 250, D 400**, E 600**

nominal width 200

MEADRAIN SG 2000 POLYMER CONCRETE DRAINAGE CHANNEL WITH 4 MM EDGE PROTECTION MADE OF DUCTILE IRON, SEALING JOINT ACCORDING TO EN 1433

Clear width of the channel body 200 mm, total width 233 mm. For the realization of linear fall (with fall 0,5%). Suitable for all channel covers **MEA 200 CLIPFIX** with longitudinal shift protection and **MEA TSH 200 TOPSLOT**. Loading classes A 15 to E 600** according to EN 1433. Load capacity according to MEA installation instructions.

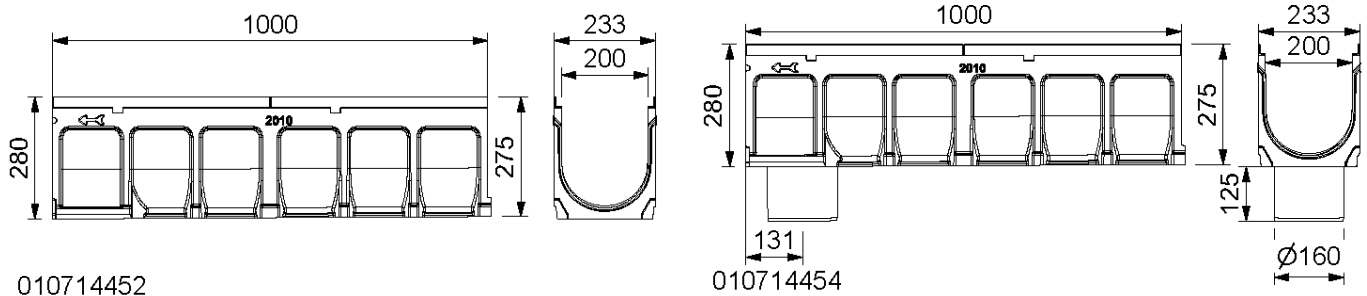

MEADRAIN SG 2000 NA DRAINAGE CHANNEL BODY, WITH 0,5% FALL, LOADING CLASSES A 15 TO E 600** ACCORDING TO EN 1433

Designation	Order No.	Length [mm]	Constructive height [mm]	Height [mm]	kg/unit
NEW! MEADRAIN SG 2001 NA Drainage channel body	010714434	1000	230	235	28,73
NEW! MEADRAIN SG 2002 NA Drainage channel body	010714436	1000	235	240	29,05
NEW! MEADRAIN SG 2003 NA Drainage channel body	010714438	1000	240	245	29,36
NEW! MEADRAIN SG 2004 NA Drainage channel body	010714440	1000	245	250	29,68
NEW! MEADRAIN SG 2005 NA Drainage channel body	010714442	1000	250	255	30,00
NEW! MEADRAIN SG 2006 NA Drainage channel body	010714444	1000	255	260	30,32
NEW! MEADRAIN SG 2007 NA Drainage channel body	010714446	1000	260	265	30,63
NEW! MEADRAIN SG 2008 NA Drainage channel body	010714448	1000	265	270	30,95
NEW! MEADRAIN SG 2009 NA Drainage channel body	010714450	1000	270	275	31,27
NEW! MEADRAIN SG 2010 NA Drainage channel body ⁵⁾	010714452	1000	275	280	31,90
NEW! MEADRAIN SG 2010/A NA Drainage channel with tight formed-in flanged drain socket Ø 160 mm ⁹⁾	010714454	1000	275	280	31,90
NEW! MEADRAIN SG 2011 NA Drainage channel body	010714456	1000	280	285	32,22
NEW! MEADRAIN SG 2012 NA Drainage channel body	010714458	1000	285	290	32,53
NEW! MEADRAIN SG 2013 NA Drainage channel body	010714460	1000	290	295	32,85
NEW! MEADRAIN SG 2014 NA Drainage channel body	010714462	1000	295	300	33,17
NEW! MEADRAIN SG 2015 NA Drainage channel body	010714464	1000	300	305	33,49
NEW! MEADRAIN SG 2016 NA Drainage channel body	010714466	1000	305	310	33,80
NEW! MEADRAIN SG 2017 NA Drainage channel body	010714468	1000	310	315	34,12
NEW! MEADRAIN SG 2018 NA Drainage channel body	010714470	1000	315	320	34,44
NEW! MEADRAIN SG 2019 NA Drainage channel body	010714472	1000	320	325	34,75
NEW! MEADRAIN SG 2020 NA Drainage channel body ⁵⁾	010714474	1000	325	330	35,07
NEW! MEADRAIN SG 2020/A NA Drainage channel with tight formed-in flanged drain socket Ø 160 mm ⁹⁾	010714476	1000	325	330	35,07

** Not suitable for the diagonal or transverse travel of motorways and highways.

5) Connection option for vertical drain Ø 160 mm (drainage preformation), end caps with connector or to gullies/silt boxes.

9) With tight formed-in drain socket Ø 160 mm

MEADRAIN SG 2000 ACCESSORIES

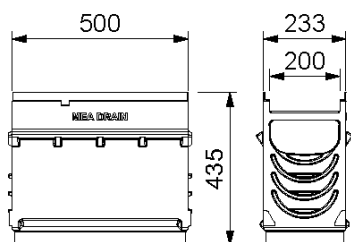

010713906

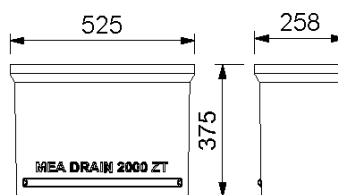

010154708

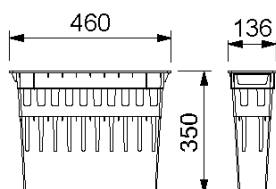

010710153

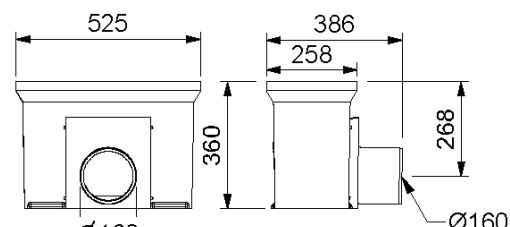

010713882

MEADRAIN SG 2000 GULLY**

Designation	Order No.	Length [mm]	Constructive height [mm]	kg/unit
NEW! MEADRAIN SG 2000.SK-OT NA Gully upper part with sealing rebate and boltless locking device	010713906	500	255	14,40
NEW! MEADRAIN 2000 SK-ZT gully intermediate part made of polymer concrete for a height extension	010154708	-	375	22,00
MEA 150/200 sediment bucket made of plastic*	010710153	-	-	3,10
NEW! MEADRAIN SK-UT-SHORT/A Gully lower part, with integrated drain socket Ø 160 mm	010713882	525	360	23,10
NEW! MEADRAIN SK-UT-SHORT/A Gully lower part, with integrated drain socket Ø 200 mm	010713883	525	360	23,10

MEADRAIN S NA and SVF / SEF 2000

A 15, B 125, C 250, D 400**, E 600**

nominal width 200



BUILDING SUCCESS

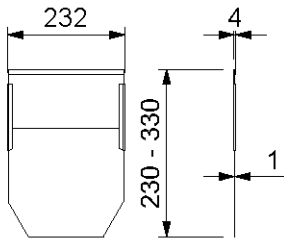

010714318

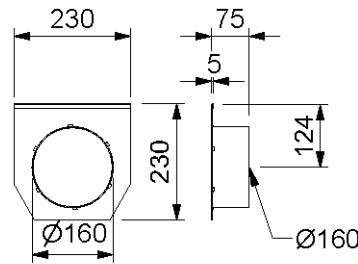

010714322

MEADRAIN SV/SG 2000 NA END CAPS AND ACCESSORIES

Designation	Order No.	Material	kg/unit
NEW! MEADRAIN SV/SG 2000-10.SE NA End cap for channel start/end, height adjustable	010714318	Galv. steel	0,77
NEW! MEADRAIN SV/SG 2010-30.SE NA End cap for channel start/end, height adjustable	010714320	Galv. steel	0,77
NEW! MEADRAIN SV/SG 2000.E NA End cap for channel end, fixed height with connection piece Ø 160 mm	010714322	Galv. steel	1,03
NEW! MEADRAIN SV/SG 2010.E NA End cap for channel end, fixed height with connection piece Ø 160 mm	010714324	Galv. steel	1,03
NEW! MEADRAIN SV/SG 2020.E NA End cap for channel end, fixed height with connection piece Ø 160 mm	010714326	Galv. steel	1,50
NEW! MEADRAIN SV/SG 2030.E NA End cap for channel end, fixed height with connection piece Ø 160 mm	010714328	Galv. steel	1,60

JOINTING COMPOUNDS FOR STANDARD APPLICATIONS***

Designation	Order No.	Material	kg/unit
SABA MS Floor GREY sealant 600 ml in a bag, stable	010152708	MS Polymer basis	0,84
SABA Primer 9102, 1 liter	010155803	Silane basis	0,92
Joint Cleaner solvent 48, 1 liter, Cleaner for adhesive flanks	010155807	-	0,81
Dispensing gun for 600 ml bags	010152707	-	0,79

* Delivery time on demand.

** Not suitable for the diagonal or transverse travel of motorways and highways.

*** For watertight mounting of drainage channels (only for channels transporting rainwater). Not suitable for installation in LAU facilities, gaz stations or similar constructions.

This edition of the technical data sheet shall be valid from October 2021 until a revised version is published and replaces any previous publications. The respectively current version is available for download at www.mea-group.com

MEA Bautechnik GmbH
 Business Unit Water Management
 Sudetenstraße 1
 86551 Aichach
 Tel.: +49 (0) 82 51. 91 0
 Fax: +49 (0) 82 51. 91 13 06
 E-Mail: info@mea-group.com
www.mea-group.com