

Maximum reliability. Minimum fuss.



# Facade Support System

Fastener Systems

**Product Focus**

All of the system components are manufactured from aluminum 6106, which has a high mechanical strength of 250 MPa, enabling large centrespans.

The components allow for free expansion (the vertical profile has one fixed and sliding mounts along the profile) or flanged (the profile is only attached to fixed points). The type of installation used is based on the technical specifications for the chosen exterior wall cladding.

### Three piece system

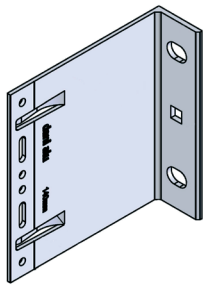

Bracket



Thermal break profiles

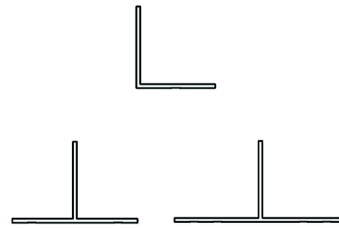

Vertical profiles

### Pre-assembled brackets with thermal break profiles

The brackets contain fixed points and slots for installation flexibility. The reinforced brackets offer good strength against mechanical loads.

There are 2 heights and 12 depths available.

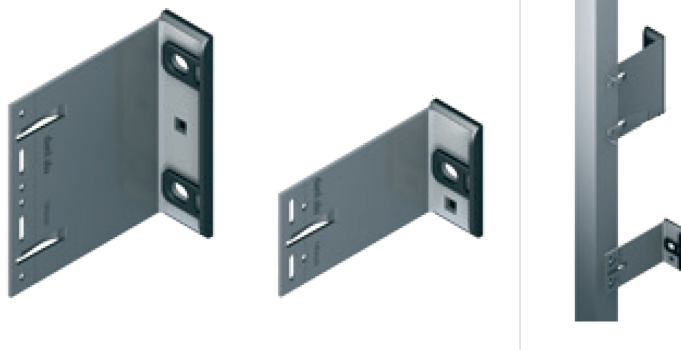

Spring clamps allow for vertical adjustment of the profiles.

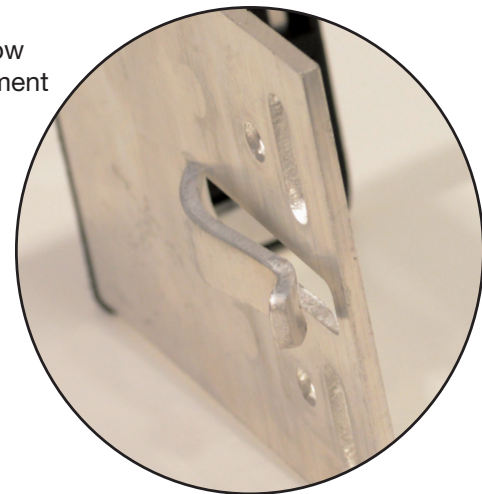

### The Fixfast facade support system with thermal breaks is designed to:

- Meet all the requirements in terms of low weight, durability and mechanical strength
- Break the thermal path between aluminium structure and building.
- Break the thermal path between the fixings and the brackets.
- Avoid bi-metallic corrosion between brackets and structure.

The factory pre-assembled thermal break spacers speed up installation times. The spacers are clipped to the brackets and also prevent loss / separation of the spacers during installation.

## Choice of brackets

The bracket depths range from 60 mm to 280 mm depending on the cavity depth.

The thermal break profiles are factory assembled to the brackets.

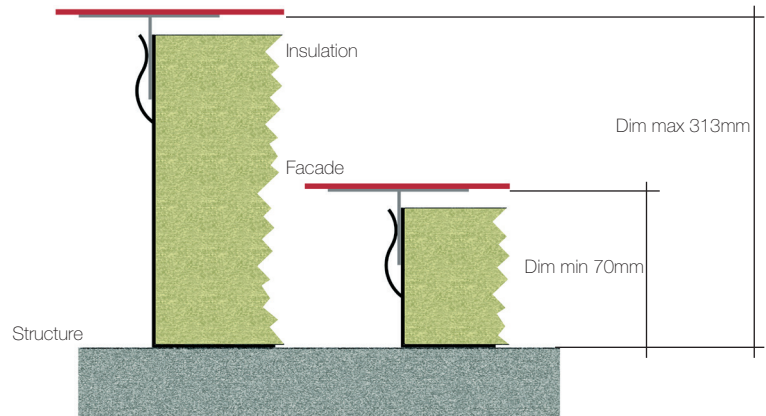

Bracket depth	60	80	100	120	140	160	180	200	220	240	260	280
Dim min	70	90	110	130	150	170	190	210	230	250	270	290
Dim max	93	113	133	153	173	193	213	233	253	273	293	313

Dim min: Minimum distance between structure and internal face of the facade system (mm)

Dim max: Maximum distance between structure and internal face of the facade system (mm)

## Vertical Profiles

The vertical profiles are available in 3 types:



Available in: Mill finish, Black taped and Powder coated for certain rainscreen types.

## Depth Adjustment

The system allows for an adjustment of +/- 10 mm to compensate for unevenness of the supporting structure.

NOTE: Customers must ensure regulations regarding air gaps are complied with, and any specific manufacturer recommendations are taken into account.

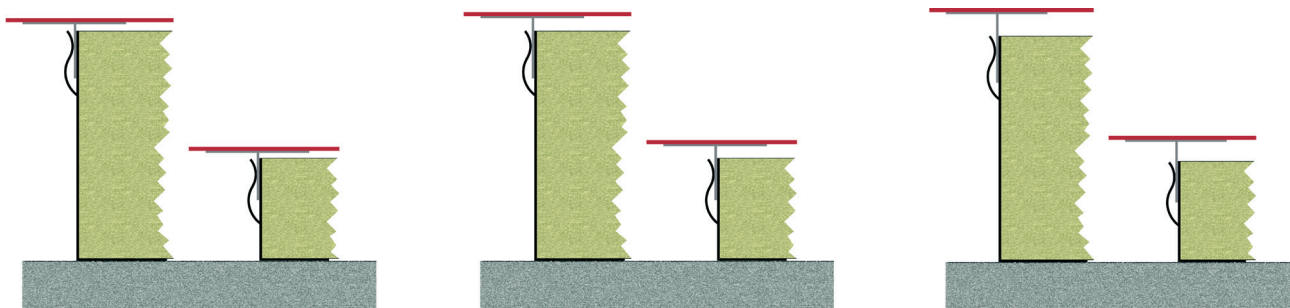

## Calculation and Specification

To assist with the specification process, Fixfast can offer loading and fixing calculations for this system - this service should be discussed at the time of enquiry or order.



Merlin House  
Seven Mile Lane  
Borough Green  
Sevenoaks  
Kent  
TN15 8QY

**Enquiries**

0800 304 7616

**International**

+44 (0) 1732 882387

**Fax**

0845 450 7486

**Email**

info@fixfast.com



Certificate number 10905  
ISO 9001, ISO 14001  
OHSAS 18001