

**www.venesta.co.uk**  
For help and advice on choosing  
your washroom, visit our website  
for a comprehensive guide.

**Our address**

Chartwell Court  
West Mill  
Imperial Business Park  
Gravesend, Kent  
DA11 0DL

Telephone  
01474 353333

Facsimile  
01474 533558

Email  
marketing@venesta.co.uk

Republic of Ireland  
Telephone  
1 800 931 880

Facsimile  
1 800 931 881

[www.venesta.co.uk](http://www.venesta.co.uk)

Education range

Education range  
**We know education  
washrooms.  
Raising the standard  
on your behalf.**

**Call us, we're here to help.  
01474 353333.**

[www.venesta.co.uk](http://www.venesta.co.uk)



**Venesta**

# We know washrooms. After 100 years of innovation in partnership with our customers, we're still passionate about setting new standards of design, value, performance and reliability.

At Venesta\*, we live and breathe washrooms. Ever since the early days, innovation has been our inspiration, and product excellence our goal. With a commitment to setting the benchmark for design and performance, we've partnered our clients in creating solutions that they can rely on to satisfy the most challenging and demanding of briefs.

Today, our expert knowledge and pioneering attitude have inspired our new range of commercial toilet cubicle and washroom systems. On the following pages you'll discover great product choice, value for money and uncompromising quality. And because customer care is so important to us, you'll find we're breaking new ground in customer service too.

We invite you to see for yourself.

# We know education.

## From nurseries to universities and children's play areas, we're committed to raising the standard of our children's washrooms.

### Safety

Children have a right to be safe at all times. With this in mind, we've introduced a number of important features into our designs. Low level and shaped door options allow adult supervision, where it's needed, while our clever safety hinges mean an end to trapped fingers. We also include door lock options for emergency release, giving you extra peace of mind.

### Privacy

Safety may be one of our top priorities but we also believe that children have a right to privacy. That's why we give you the option of full height cubicle partitions. For secondary and further education, our solutions also include urinal privacy screens.

### Colours

Children love colour and bold designs. So, we've created the widest and brightest palette featuring 36 fresh and vibrant colours, ensuring you can create a washroom that children will enjoy using. And we've not stopped at colour; our screen prints add extra vibrancy, making them a popular choice from nurseries to universities.

### Hygiene

A hard-working washroom should also be one that's easy to maintain. That's why our solutions include features that make cleaning really easy. These include

our solid surface washtrough with individual drainers. Also, the solid grade laminate we use is totally impervious to water, which means it can withstand intensive cleaning.

### Anti-vandal

At Venesta, we work hard to ensure our stylish and robust designs encourage respect and discourage vandalism. So, our solutions for secondary and further education washrooms feature steel cored anti-vandal structures and durable metal fittings.

### Performance

All education ranges except Academy are available in all three performance options suitable for every type of wet or dry environment that is likely to be encountered, allowing you to specify the most appropriate option to meet the site requirements and your budget.

### MFC

For dry environments with low risk of vandalism. Panels are manufactured from 18mm nominal thickness high performance moisture-resistant melamine faced chipboard. Edges lipped with PVC.

### HPL

For more heavily used washrooms, panels are heat, scratch and impact resistant. Manufactured from moisture-resistant

chipboard faced with high pressure laminate, panels are 18mm nominal thickness. Edges lipped with PVC.

### SGL

Solid grade laminate is extremely resistant to impact and all surfaces are impervious to water. Panels are 13mm nominal thickness with polished black radiused edges.

### Value for money to suit your every budget

A quality product doesn't always mean an expensive product. No one knows that better than Venesta. We strive to ensure that our products are always competitively priced and that whatever your budget, you can expect a wide choice of excellent designs that are surprisingly affordable.



### 01 Playful colour

Our screen prints add extra vibrancy, making them a popular choice

### 02 Made to last

Our solutions for secondary and further education washrooms feature satin anodised aluminium headrail and pilasters

### 03 Easy cleaning

The solid grade laminate we use is totally impervious to water

### 04 Right to feel safe

Low level and shaped door options allow adult supervision

# We know washroom solutions. Choice at your service.



## 2-11 years

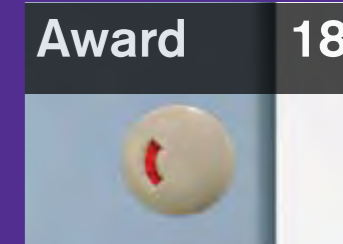
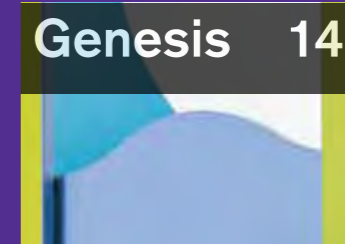
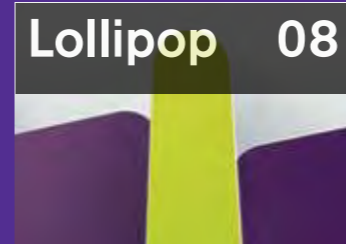

2-11 years

## 11+ years

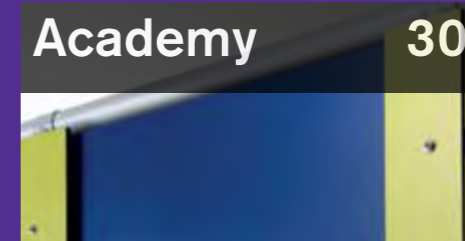

11+ years



## Panelling

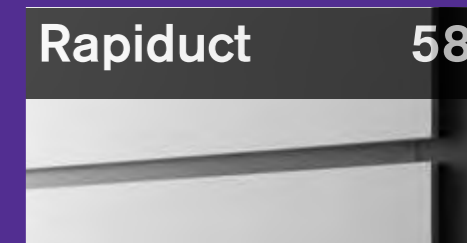
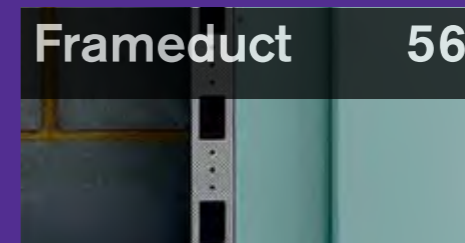
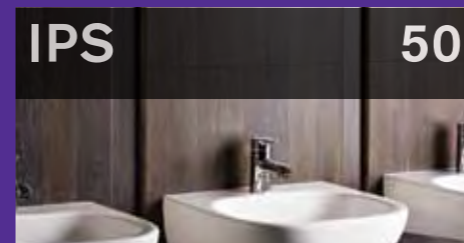

Panelling

## Complementary

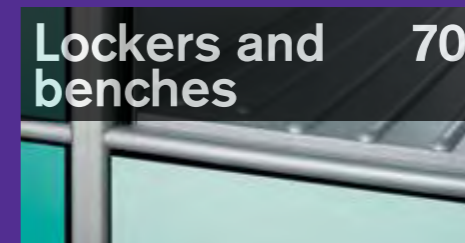
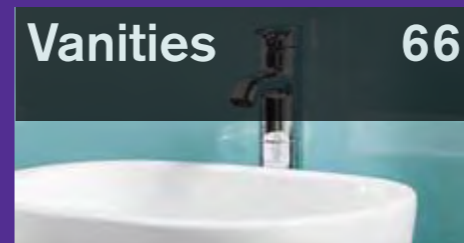

Complementary

**2-11 years** Our design team has gone to town to create spaces that challenge and delight young minds. Lollipop, Surf and Genesis are perfect combinations of fun, safety and hygiene – perfect for schools, crèches and children’s play areas.

# Lollipop

Designed to suit the specific needs of young children, Lollipop is a free-standing system that delivers fun and safety in equal measures. It comes with two door height options, a choice of colourful, easy to operate indicator bolts or magnetic catches and specially designed safety hinges.

## Key features

- No headrail
- Unique shaped doors and partitions
- Available in 2 heights for younger children
- Total colour flexibility
- Anti-finger trap hinges
- Door emergency release mechanism
- Choice of screen prints
- Allows adult supervision
- Unique pedestal design, offering rigidity



### Main image

Lollipop cubicles in Colours screen print, Jamboree and Baby Blue, shelf height Rapiduct in Baby Blue, HPL Lollipop vanity in Colours screen print, Jamboree and Baby Blue

See p20 for Lollipop technical specifications

# Surf

With Surf, children of junior age can expect exciting designs and maximum safety. Full height cubicle partitions give growing children the privacy they need while safety hinges and indicator bolts with emergency release provide peace of mind.



**01** Headrail and shaped partition detail

**02** HPL Surf vanity in Jive, Teal and Monsters screen print

See p21 for Surf technical specifications

## Main image

Surf cubicles in Monsters screen print and Jive, HPL Surf vanity and light pelmet in Jive and Teal



## Key features

- Unique shaped doors and partitions
- Available in 2 heights
- Total colour flexibility
- Anti-finger trap hinges
- Door emergency release mechanism
- Choice of screen prints
- Allows privacy for children and adult supervision
- Suitable for wet and dry environments

## Case study Belleville Primary School

Before this project went ahead we stipulated that our suppliers needed, not only to provide highly thought out, stylish systems but also to be hot on the quality of their service too. I'm delighted to say, we got both from Venesta.

Mr Grove, Head, Belleville Primary School

Judged 'outstanding' by Ofsted in 2007, Belleville School in Battersea, looks after 730 pupils, aged between 4 and 11. Housed in a classic Victorian building, the school is committed to providing a warm and friendly environment for children to learn and spends a lot of time and effort ensuring its pupils feel safe, secure and stimulated.

Charged with an extensive refurbishment to the whole school, chartered surveyors, Wilby and Burnett briefed Venesta to provide a cubicle range that would answer the school's need for a fun, safe and hygienic environment. Genesis was selected for its design and variety of height options making it the natural choice. School head, Mr Grove, was particularly impressed by Venesta's online design studio which allowed him to visualise different colour mixes before making his selection.

A key consideration on this project was timing. The refurbishment was planned for the school holidays, meaning it had to be gutted and refitted in just six weeks. Thankfully, the highly efficient Venesta team was able to rise to the challenge and delivered the cubicles on time and ready to install.





# Genesis

As the recognised standard for children's washroom cubicles, Genesis is a popular, highly flexible choice for your school or nursery. It features four height options, safety hinges and a choice of indicator bolts or magnetic catches.

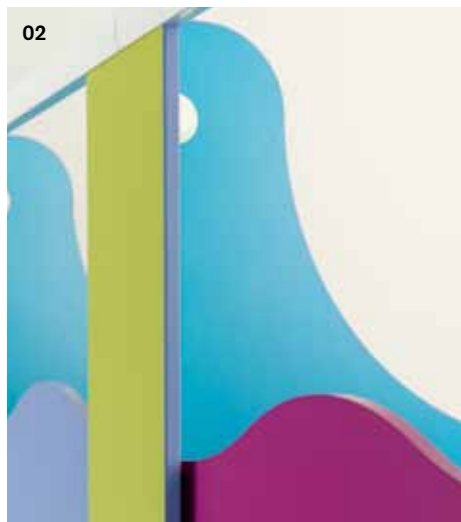

**01** ABS indicator bolt fascia in Iceberg

**02** Headrail and shaped partition detail

See p22 for Genesis technical specifications

## Main image

Genesis cubicles in Jive, Teal, Wisteria and Jamboree, HPL vanity and light pelmet in Jive, Wisteria and Jamboree



## Key features

- Shaped doors and partitions
- Available in 4 heights
- Total colour flexibility
- Anti-finger trap hinges
- Choice of screen prints
- Suitable for wet and dry environments

# Screen prints

Colour and design spark a child's imagination so our design team is constantly working on new ideas to inspire young minds. These screen print designs can be applied to the front of cubicle doors, duct panels and vanity units. Door rears are designed to match your chosen partition colour. Available in HPL only.

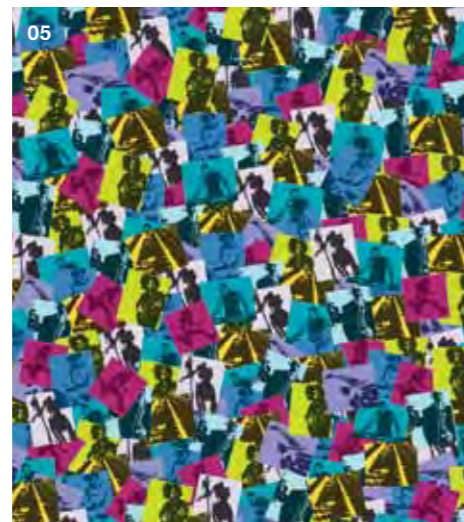
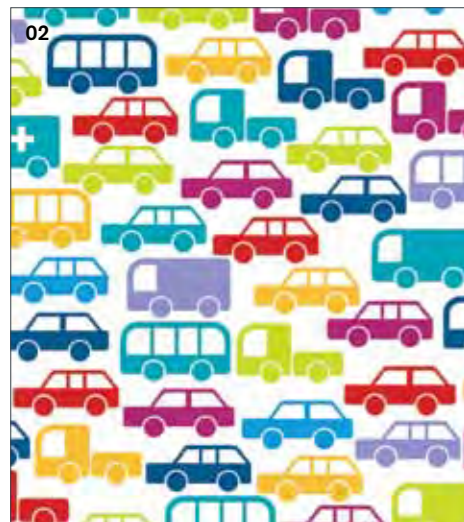
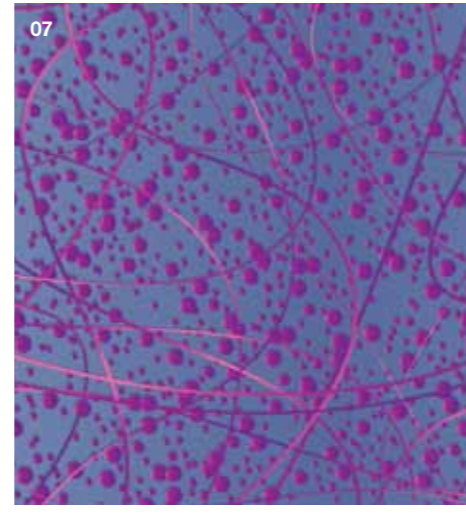
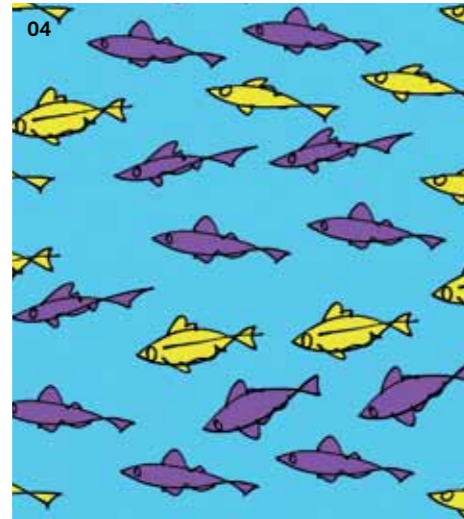

- 01 Colours screen print
- 02 Cars screen print
- 03 Monsters screen print
- 04 Fish screen print
- 05 Pop Art screen print
- 06 Abstract screen print
- 07 Fizz screen print
- 08 Circles screen print
- 09 Award screen print
- 10 Lollipop screen print
- 11 Surf screen print

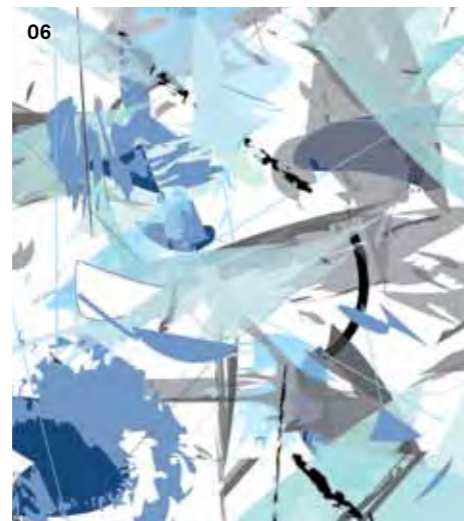

# Door heights

Balancing privacy needs with the need to supervise children is something we carefully consider with all our education washroom designs. The option of shaped and low height doors ensures you can achieve both.

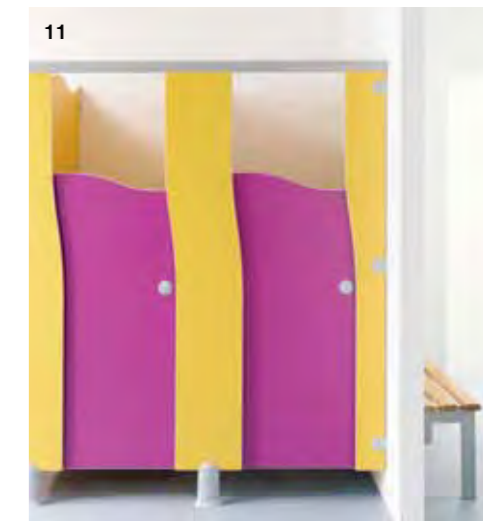

# Award

Versatile, economical and easy to assemble. Award gives you a tried and tested bespoke solution that works equally well in wet or dry environments. Plus, it comes with a choice of vibrant colours and sleek fittings.

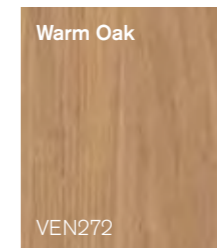
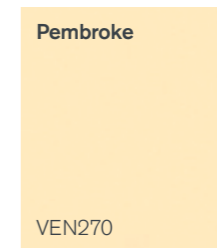
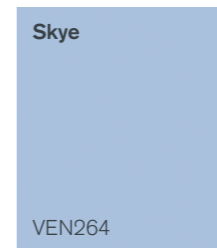
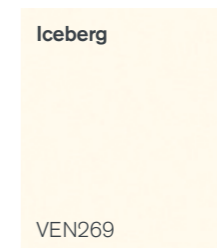
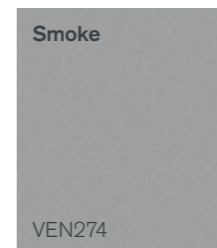
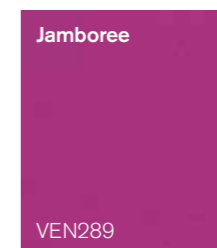
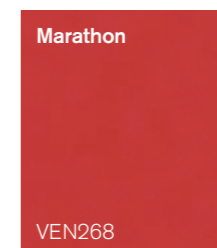
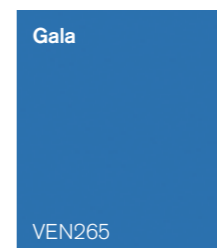
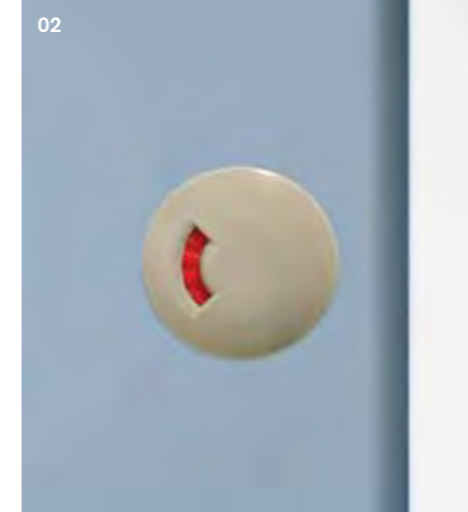

The fittings come in a choice of two options: ABS Smoke and Graphite or powder coated aluminium in Light Grey and Dark Grey

**Key features**  
 Flexibility  
 Suitable for wet and dry environments  
 Simple installation  
 Economical

**01** ABS pedestal in Smoke

**02** ABS indicator bolt fascia in Smoke

See p23 for Award technical specifications

**Main image**  
 Award cubicles with cut down doors in Skye and Iceberg

## Technical Specifying Lollipop

### Overall height

Height A - 1350mm  
Height B - 1550mm

### Floor clearance

150mm

### Maximum depth

MFC - 1500mm  
HPL - 1500mm  
SGL - 1500mm

### Door height options

Height A - 1000mm  
Height B - 1200mm

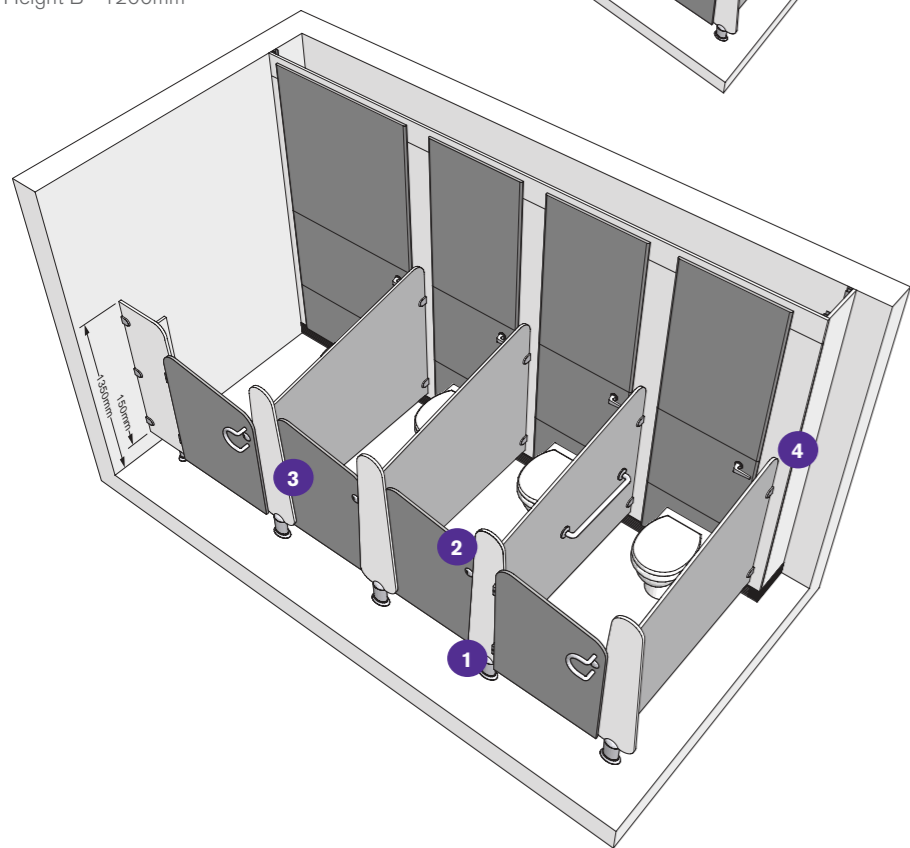
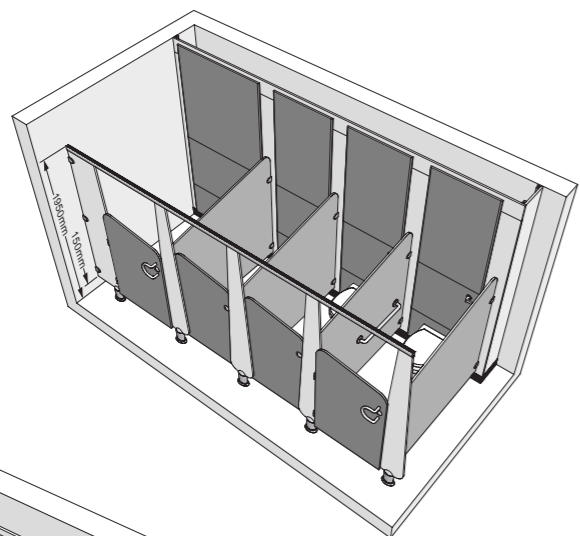

1 Pedestal



2 Indicator bolt



3 Hinge



4 Cleat



### Panels and doors

Available in MFC, HPL and SGL.

### Colour finish

MFC, HPL and SGL

36 colours.

5 screen prints (HPL only).

### Cubicle hardware

ABS – 8 colours.

### Edge treatment

MFC and HPL

3mm PVC lipping.

SGL

Polished black radiused edge.

### Headrail

Easy to fix, one piece construction. Available in 8 finishes with matching end cap which complement other fittings.

**Standard** with no headrail

Sound concrete sub-floor required.

**Full height** with headrail

Suitable for any floor type.

### Steel support

Structural steel post, bolted to concrete floor with anchors.

### Cubicle hardware

#### Hinge

Universal aluminium safety hinge.

#### Wall fixing

Cleat with through fixing and snap on outer case accommodates out of line wall.

#### Indicator bolt

Easy grip indicator bolt with emergency release facility and concealed fixings. Magnetic catch option in lieu of indicator bolts.

#### Pedestal

Height adjustable for uneven floors, with concealed fixings.

### Height

2 height options.

### Vanities

A complementary Lollipop vanity with shaped under panels is available. Under panels may also feature a choice of 5 screen prints.

Lollipop vanities available in 600mm high K2 profile.

### Accessories

Coat hooks and toilet roll holders available.

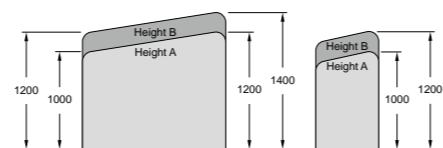

## Technical Specifying Surf

### Overall height

1950mm

### Floor clearance

150mm

### Maximum depth

MFC - 2000mm  
HPL - 2000mm  
SGL - 2000mm

### Door height options

Height C - 1300mm  
Height D - 1500mm

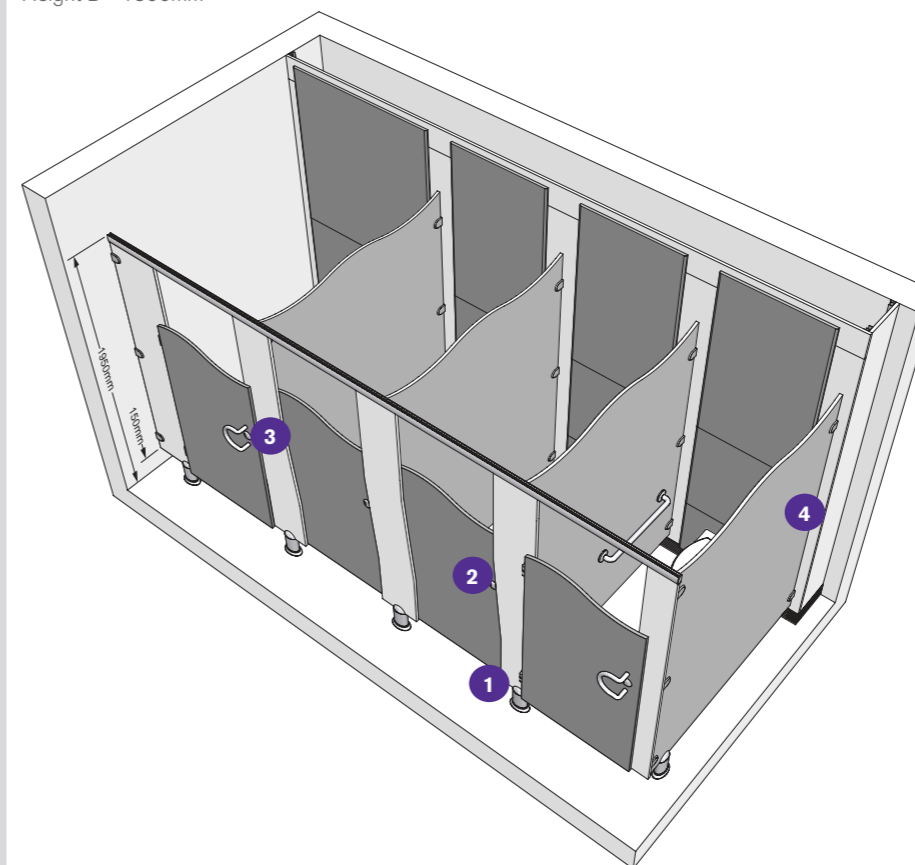
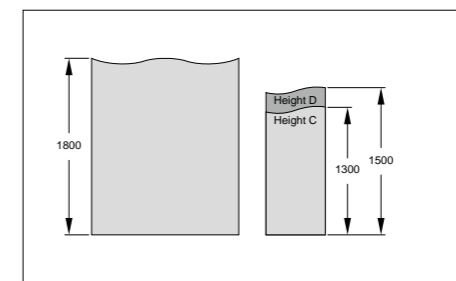

1 Pedestal



2 Indicator bolt



3 Hinge



4 Cleat



### Panels and doors

Available in MFC, HPL and SGL.

### Colour finish

MFC, HPL and SGL

36 colours.

5 screen prints (HPL only).

### Cubicle hardware

ABS – 8 colours.

Aluminium - Light Grey and Dark Grey.

### Edge treatment

MFC and HPL

3mm PVC lipping.

SGL

Polished black radiused edge.

### Headrail

Easy to fix, one piece construction. Available in 8 finishes with matching end cap to complement other fittings.

### Cubicle hardware

#### Hinge

Universal aluminium safety hinge.

#### Wall fixing

Cleat with through fixing and snap on outer case accommodates out of line wall.

#### Indicator bolt

Easy grip indicator bolt with emergency release facility and concealed fixings.

#### Pedestal

Height adjustable for uneven floors with concealed fixings.

### Height

2 door height options.

### Vanities

A complementary Surf vanity with shaped top and under panels is available – under panels may also feature a choice of 5 screen prints.

Surf vanities available in 750mm or 800mm high K2 profile in 3 fixed lengths – 750mm, 1500mm and 2250mm.

N.B. Surf vanity is available in 3 fixed lengths – 750mm, 1500mm and 2250mm.

### Accessories

Coat hooks and toilet roll holders available.

# Technical Specifying Genesis

**Overall height**  
1950mm

**Floor clearance**  
150mm

**Maximum depth**  
MFC - 2000mm  
HPL - 2000mm  
SGL - 2000mm

**Door height options**  
Height A - 975mm  
Height B - 1175mm  
Height C - 1375mm  
Height D - 1575mm

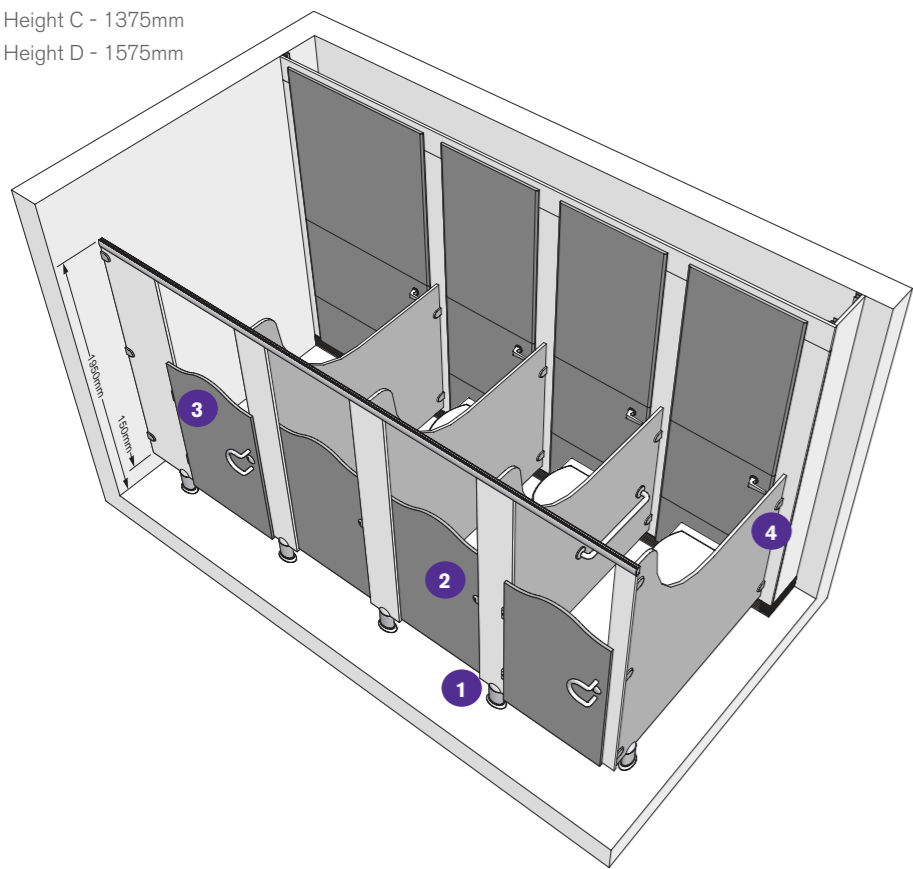
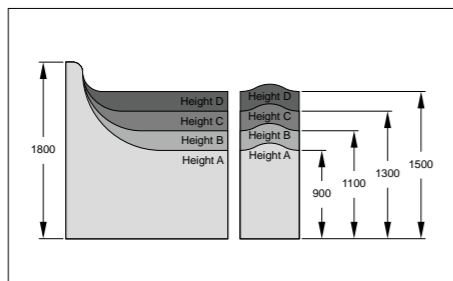

**Panels and doors**  
Available in MFC, HPL and SGL.

**Colour finish**  
MFC, HPL and SGL  
36 colours.  
5 screen prints (HPL only).  
**Cubicle hardware**  
ABS - 8 colours.  
Aluminium - Light Grey and Dark Grey.

**Edge treatment**  
MFC and HPL  
3mm PVC lipping.  
SGL  
Polished black radiused edge.

**Headrail**  
Easy to fix, one piece construction.  
Available in 8 finishes with matching end cap to complement other fittings.

**Cubicle hardware**  
**Hinge**  
Universal aluminium safety hinge.  
**Wall fixing**  
Cleat with through fixing and snap on outer case accommodates out of line wall.

**Indicator bolt**  
Easy grip indicator bolt with emergency release facility and concealed fixings.

**Pedestal**  
Height adjustable for uneven floors with concealed fixings.

**Heights**  
4 height options.

**Vanities**  
Genesis vanities are available in 600mm, 675mm, 750mm and 800mm height.

**Accessories**  
Coat hooks and toilet roll holders available.

# Technical Specifying Award

**Overall height**  
2100mm

**Floor clearance**  
100mm

**Maximum depth**  
MFC - 2000mm  
HPL - 2000mm  
SGL - 2000mm

**Door height options**  
Height A - 1300mm  
Height B - 1100mm

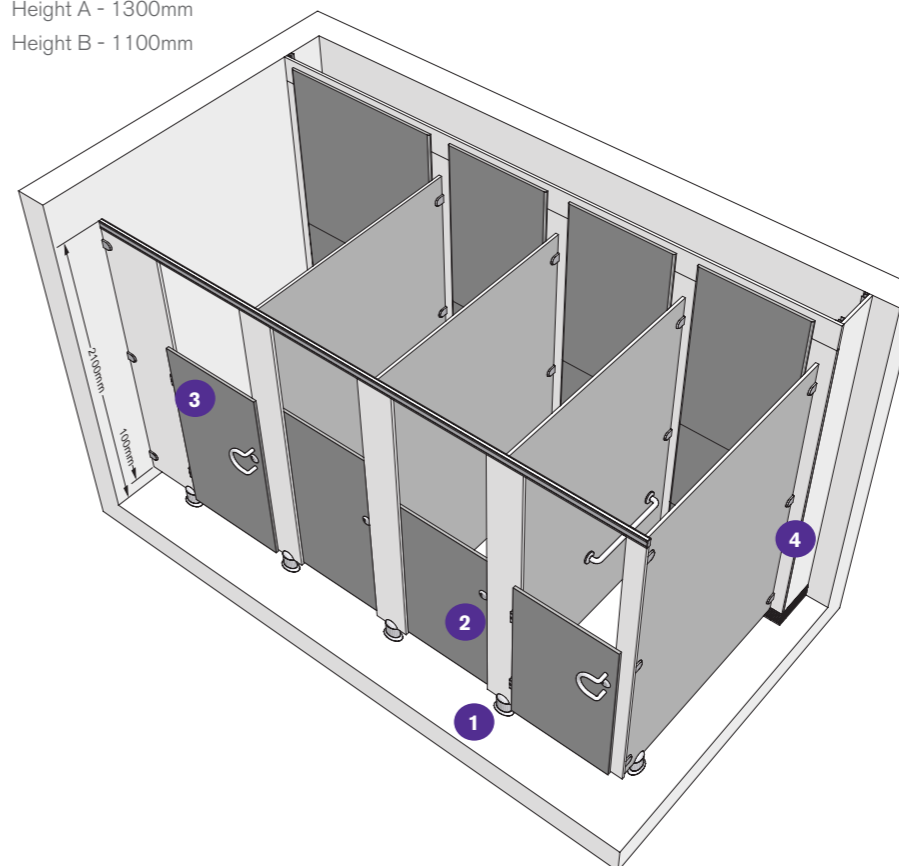

**Panels and doors**  
Available in MFC, HPL and SGL.

**Colour finish**  
MFC, HPL and SGL  
12 colours.  
**Cubicle hardware**  
ABS - 8 colours.  
ABS - Graphite and Smoke.  
Aluminium - Light Grey and Dark Grey.

**Edge treatment**  
MFC and HPL  
1mm PVC lipping.  
SGL  
Polished black radiused edge.

**Headrail**  
Rigid aluminium channel in Light Grey and Dark Grey with matching end cap.

**Cubicle hardware**  
**Hinge**  
Universal aluminium safety hinge.  
**Wall fixing**  
Cleat with through fixing and snap on outer case accommodates out of line wall.

**Indicator bolt**  
Easy grip indicator bolt with emergency release facility and concealed fixings.

**Pedestal**  
Height adjustable for uneven floors with concealed fixings.

**Height**  
3 door height options.  
For standard height option see p40.

**Accessories**  
Coat hooks and toilet roll holders available.

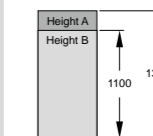

**11+ years** Cleanliness, ease of maintenance, privacy, vandal resistance. With tough demands like these, you'll be glad to know we build these things into our designs as a matter of course. The results speak for themselves.

11+ years

## Centurion Full height

As well as being extra robust, Centurion is wonderfully flexible. So, if you're looking for extra privacy with a full height cubicle, Centurion will satisfy your needs.

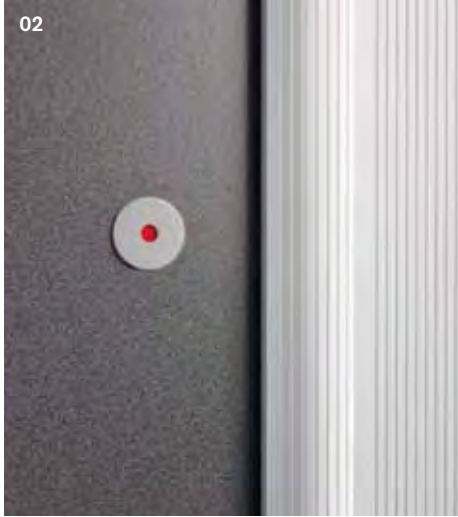

**01** Floor fixed pilasters in satin anodised aluminium

**02** Light Grey powder coated aluminium indicator bolt fascia

See p44 for Centurion technical specifications

### Main image

Centurion in Asphalt and Blossom with satin anodised aluminium pilasters



### Key features

- Robust frame design
- Fluted aluminium pilasters
- Renowned for strength and rigidity
- Hardwearing anti-static powder coated finish
- Easy adjust hinges
- Floor to ceiling for increased privacy



## Centurion

Centurion's strength comes from a number of key details. Wall channels offer extra rigidity and pilasters extend to the floor, so no pedestals are required.

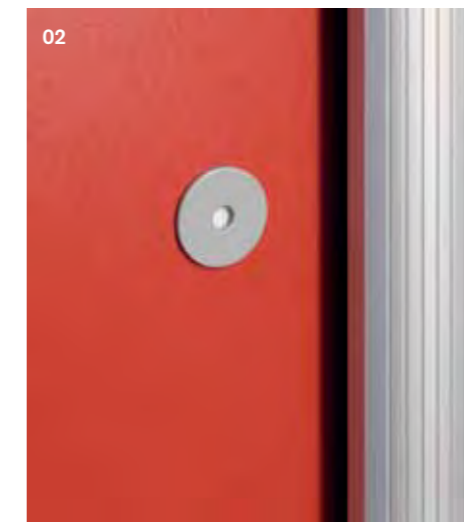

**01** Satin anodised aluminium headrail at pilaster junction

**02** Light Grey powder coated aluminium indicator bolt fascia

See p44 for Centurion technical specifications

### Main image

Centurion in Marathon with satin anodised aluminium pilasters, IPS panels in Graphite



## Case study Tudor Grange Academy

To meet the rigorous demands of this type of environment, all facilities in our Academy have to be robust, efficient and fit for purpose. Centurion has fulfilled these requirements, and has given an excellent finished appearance in all washroom areas.

Graham Turner, Facilities Manager, Tudor Grange Academy.

Tudor Grange in Solihull is a mixed academy, catering for 11-16 year olds, formed in 1974 from the combination of well established boys' and girls' grammar schools on the same site.

The academy has a reputation for excellence and academic achievement and is popular with parents and students alike. In fact, it's always over subscribed. When it came to refurbishment, Facilities Manager, Graham Turner, was looking for a highly robust, high specification cubicle that would be able to withstand the many rigours of this large and busy academy.

Solihull Council, having specified Venesta in the past, chose our Centurion range for the six male and female toilet facilities situated throughout the campus. Centurion combines strength and rigidity with wall channels and pilasters that extend to the floor, obviating the need for pedestals. This gave the academy the long-lasting quality that they were looking for.



# Titan

Titan certainly lives up to its name. A full height design with low floor clearance for privacy and partitions with rigid wall channels for strength where you need it most.

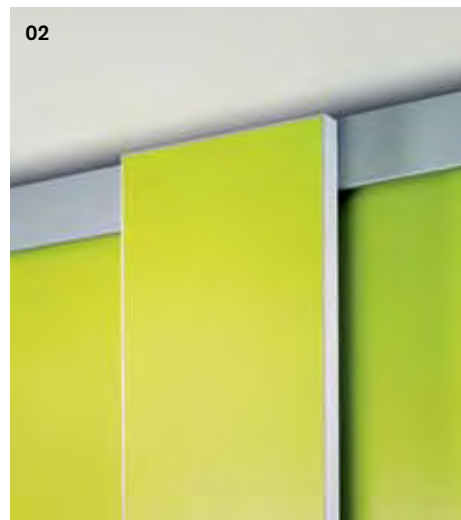

**01** Unique aluminium shoe in Light Grey powder coated aluminium

**02** Light Grey powder coated aluminium headrail

See p46 for Titan technical specifications

## Main image

Titan in Jive



## Key features

- Total privacy
- Partition skirting channel
- Suitable for wet and dry environments
- Floor to ceiling
- Unique aluminium shoe
- Wall channels for additional rigidity



## Quantum

Quantum, our best selling cubicle range, sets the benchmark for washrooms. Your need for maximum flexibility has inspired us to create a range that suits both wet and dry areas and offers the widest choice of fittings and colours.



**01** Pedestals that are fitted to partitions give the range its floating appearance

**02** Powder coated aluminium headrail in Hydrogen

See p47 for Quantum technical specifications

**Main image**  
Quantum in Oxford Blue, Baby Blue and Skye, IPS panels in Baby Blue and Iceberg

### Key features

- Floating appearance
- Sculptured headrail design
- Matching contemporary fixings
- Suitable for wet and dry environments
- Total colour flexibility
- Shower curtain track option

# Award

Versatile, economical and easy to assemble, Award gives you a tried and tested bespoke solution that works equally well in wet or dry environments. Plus, it comes with a choice of vibrant colours and sleek fittings.

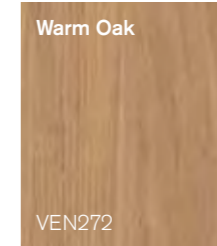
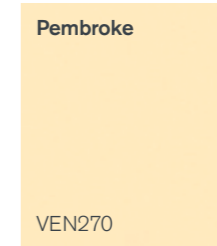
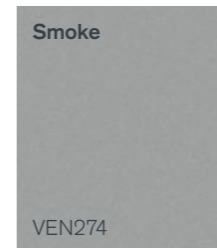
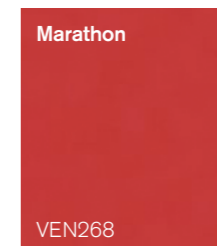
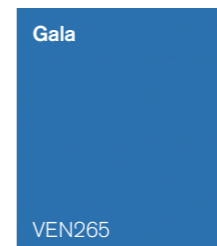
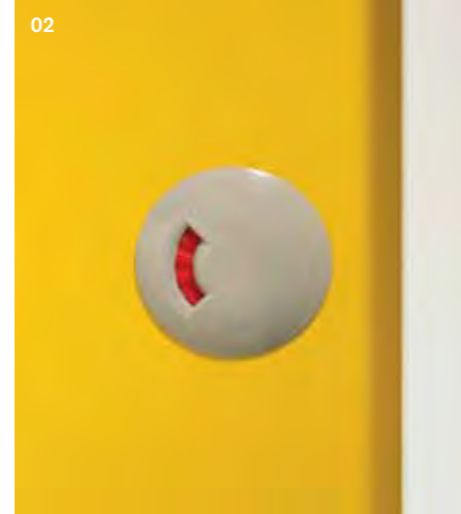

The fittings come in a choice of four options: ABS Smoke and Graphite or powder coated aluminium in Light Grey and Dark Grey

**Key features**  
 Flexibility  
 Suitable for wet and dry environments  
 Simple installation  
 Economical

**01** ABS pedestal in Smoke

**02** ABS indicator bolt fascia in Smoke

See p48 for Award technical specifications

**Main image**  
 Award in Buttercup and Iceberg

# Access

Hard-working, clean cut and robust, Access is your ultimate no-frills solution that has the stamina to last, whatever you throw at it. And it comes in a choice of refreshing vibrant colours, giving you lasting style too.

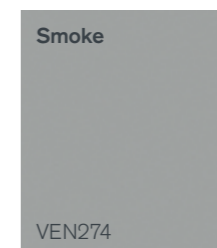

The fittings are available in ABS Graphite

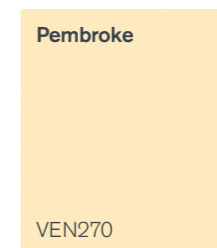
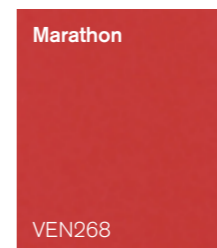
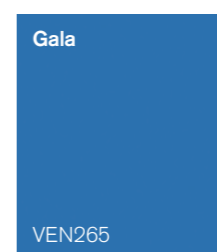

01 ABS indicator bolt

02 ABS fixing cleat

See p49 for Access technical specifications

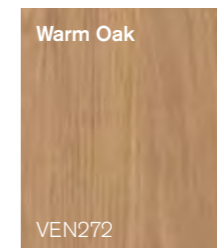

**Main image**

Access in Gala and Smoke, HPL vanity in Smoke, Gala and Graphite

- Key features**
- Economical
  - Flexibility
  - Suitable for wet and dry environments
  - Robust fittings
  - Easy to install

# Technical Specifying Centurion

Centurion full height		
Maximum height	Door clearance	Overall height
MFC - 2770mm	10mm	2115mm
HPL 1 - 2570mm		
HPL 2 - 3000mm	Ceiling clearance	Floor clearance
SGL - 2550mm	45mm	100mm
Minimum height	Maximum depth	Maximum depth
MFC - 2000mm	MFC - 2000mm	MFC - 2000mm
HPL 1 - 2000mm	HPL 1 - 2000mm	HPL - 2000mm
HPL 2 - 1560mm	HPL 2 - 1560mm	SGL - 2000mm
SGL - 2000mm	SGL - 2000mm	

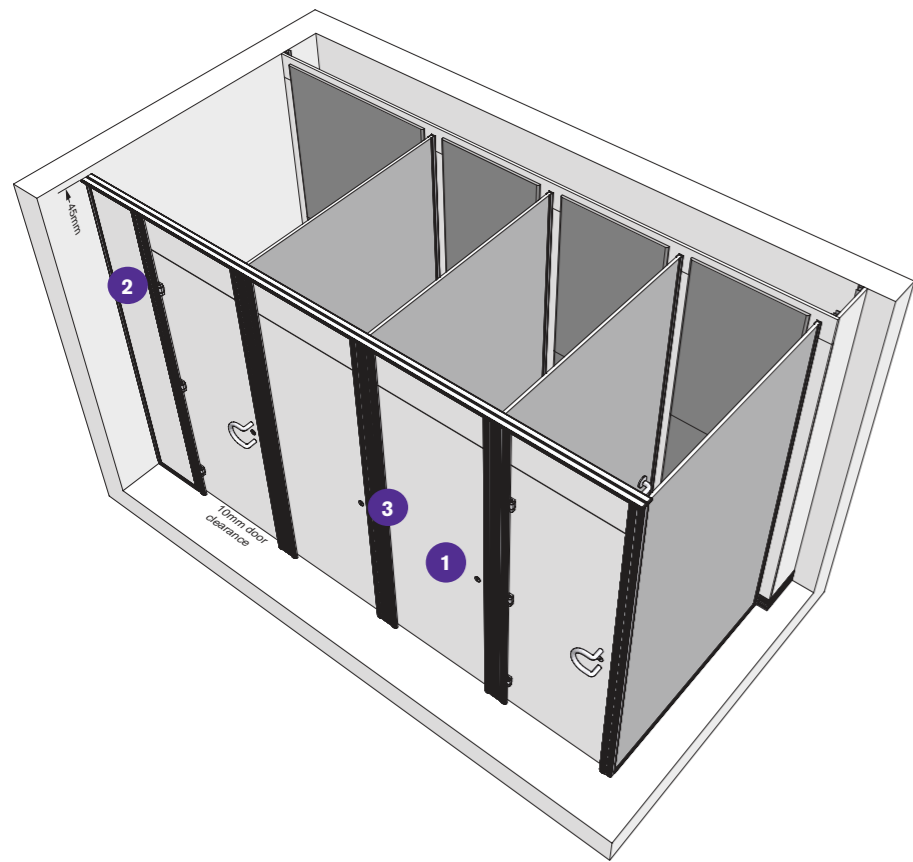

### Panels and doors

Available in MFC, HPL and SGL.

### Colour finish

**MFC, HPL and SGL**

36 colours.

### Cubicle hardware

Light Grey or Dark Grey aluminium.

### Edge treatment

**MFC and HPL**

Matching 1mm PVC lipping.

**SGL**

Polished black radiused edge.

### Pilasters

Extruded aluminium sections available in satin anodised or Dark Grey powder coated aluminium.

### Headrail

Extruded aluminium headrail available in satin anodised or Dark Grey powder coated aluminium.

### Hinge

Overpanels fitted above doors.

### Cubicle hardware

#### Hinge

Universal aluminium safety hinge.

#### Wall fixing

Partitions fixed to walls using aluminium channel.

#### Indicator bolt

Indicator bolt with emergency release facility and keep, all with concealed fixings.

#### Floor fixing

Partitions fixed to floor using aluminium channel.

### Accessories

Coat hooks and toilet roll holders available.



# Technical Specifying Centurion

Centurion standard height		
Maximum height	Door clearance	Overall height
MFC - 2770mm	10mm	2115mm
HPL 1 - 2570mm		
HPL 2 - 3000mm	Ceiling clearance	Floor clearance
SGL - 2550mm	45mm	100mm
Minimum height	Maximum depth	Maximum depth
MFC - 2000mm	MFC - 2000mm	MFC - 2000mm
HPL 1 - 2000mm	HPL 1 - 2000mm	HPL - 2000mm
HPL 2 - 1560mm	HPL 2 - 1560mm	SGL - 2000mm
SGL - 2000mm	SGL - 2000mm	

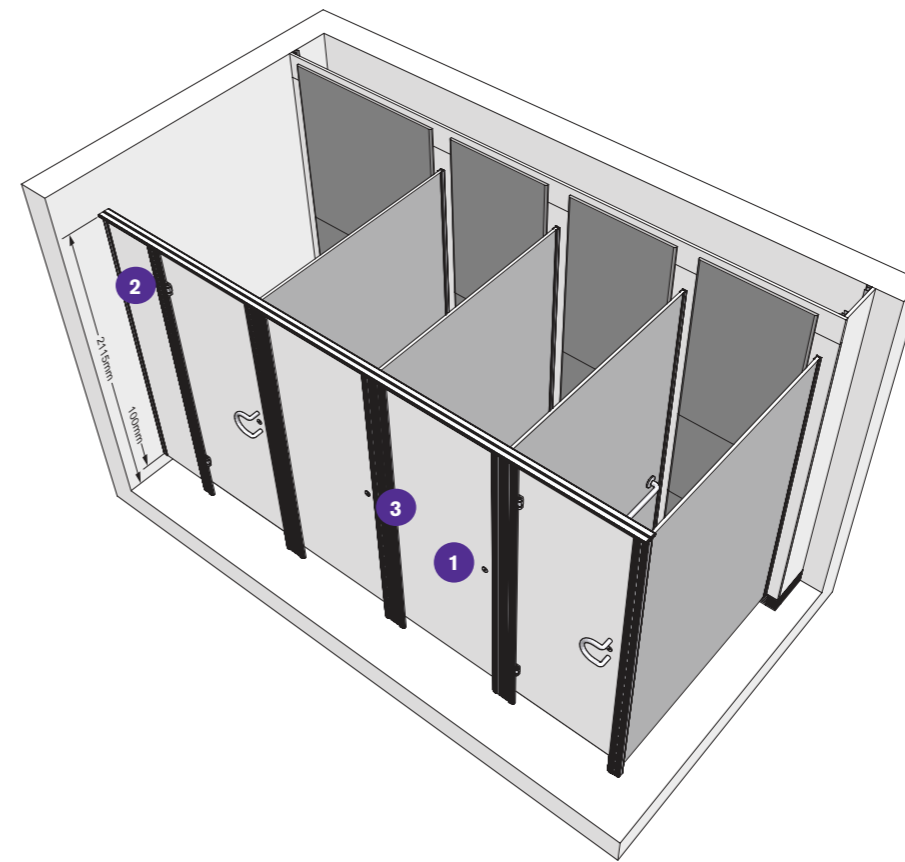

### Panels and doors

Available in MFC, HPL and SGL.

### Colour finish

**MFC, HPL and SGL**

36 colours.

### Cubicle hardware

Light Grey or Dark Grey aluminium.

### Edge treatment

**MFC and HPL**

Matching 1mm PVC lipping.

**SGL**

Polished black radiused edge.

### Pilasters

Extruded aluminium sections available in satin anodised or Dark Grey powder coated aluminium.

### Headrail

Extruded aluminium headrail available in satin anodised or Dark Grey powder coated aluminium.

### Cubicle hardware

#### Hinge

Universal aluminium safety hinge.

#### Wall fixing

Partitions fixed to walls using aluminium channel.

#### Indicator bolt

Indicator bolt with emergency release facility and keep, all with concealed fixings.

#### Pedestal

The Centurion cubicle has extruded aluminium pilasters which extend down to floor level and fix to floor mounting blocks.

### Accessories

Coat hooks and toilet roll holders available.

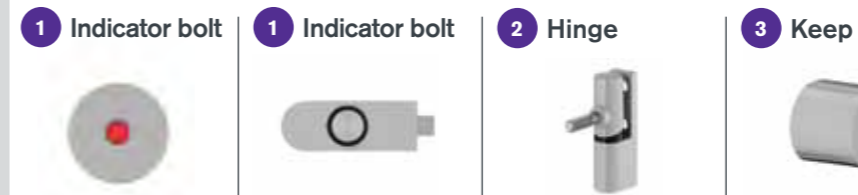

# Technical Specifying Titan

**Maximum height**

MFC - 2780mm  
 HPL 1 - 2580mm  
 HPL 2 - 3100mm  
 SGL - 2560mm

**Door and Ceiling clearance**

10mm

**Maximum depth**

MFC - 2000mm  
 HPL 1 - 2000mm  
 HPL 2 - 1560mm  
 SGL - 2000mm

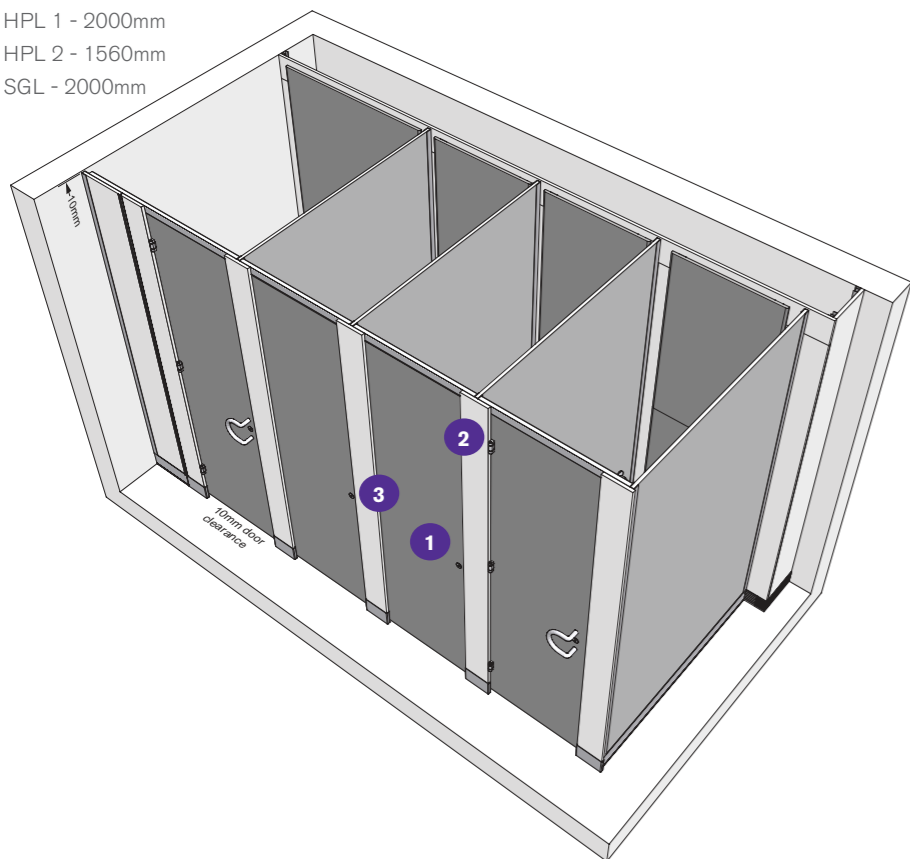

**Panels and doors**

Available in MFC, HPL and SGL.

**Colour finish**

**MFC, HPL and SGL**  
 36 colours.

**Cubicle hardware**

Aluminium Light Grey or Dark Grey.

**Edge treatment**

**MFC and HPL**  
 Matching 3mm PVC lipping.  
**SGL**  
 Polished black radiused edge.

**Headrail**

Easy to fix, one piece construction. Available in 2 finishes which complement other fittings. Powder coated aluminium.

**Cubicle hardware**

**Hinge**

Universal aluminium safety hinge.

**Wall fixing**

Aluminium wall channel and privacy skirting.

**Indicator bolt**

Indicator bolt with emergency release facility and keep, all with concealed fixings.

**Accessories**

Coat hooks and toilet roll holders available.

1 Indicator bolt | 1 Indicator bolt | 2 Hinge | 3 Keep



# Technical Specifying Quantum

**Overall height**

2100mm

**Floor clearance**

100mm

**Maximum depth**

MFC - 2000mm  
 HPL - 2000mm  
 SGL - 2000mm

**Post-formed option**

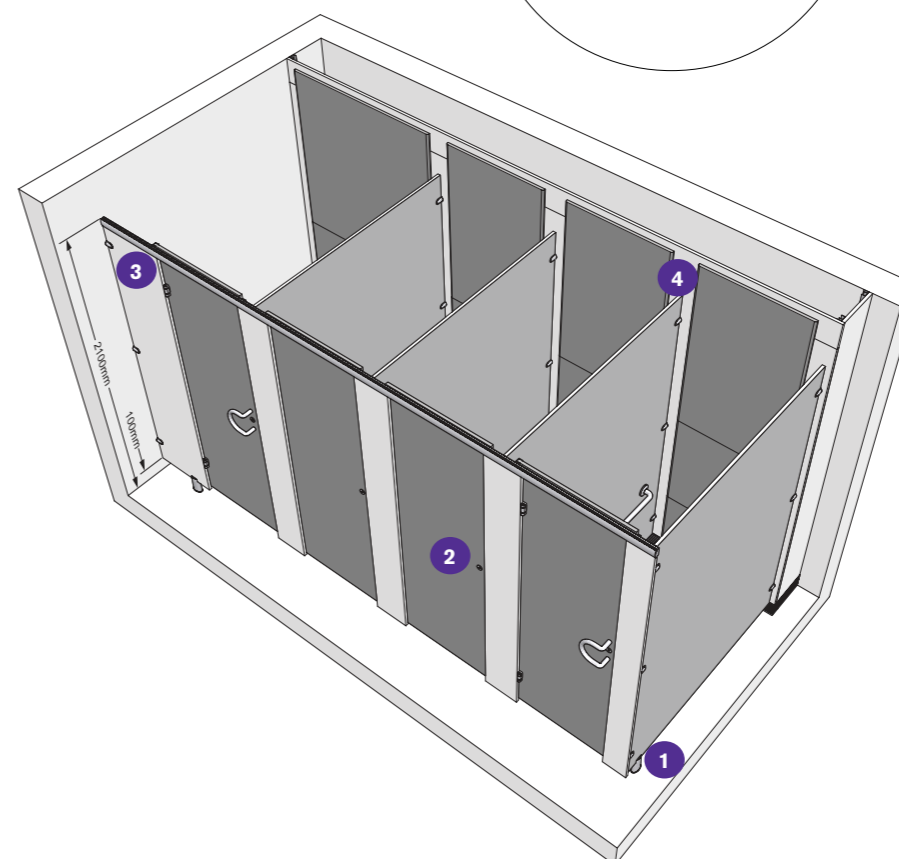
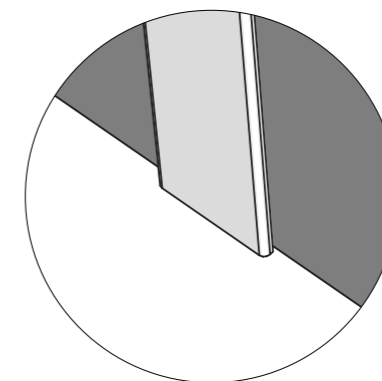

**Panels and doors**

Available in MFC, HPL and SGL.

**Colour finish**

**MFC, HPL and SGL**  
 36 colours.

**Cubicle hardware**

ABS 8 colours. Aluminium Light Grey or Dark Grey and Stainless Steel.

**Edge treatment**

**MFC**  
 Matching 3mm PVC lipping.  
**HPL**  
 Matching 3mm PVC lipping with the option of post-formed pilasters.  
**SGL**  
 Polished black radiused edge.

**Headrail**

Easy to fix, one piece construction. Matching end cap. Headrail available in 8 powder coated aluminium colours and also a stainless steel effect.

**Cubicle hardware**

**Hinge**

Universal aluminium safety hinge.

**Wall fixing**

Cleat with through fixing and snap on outer case accommodates out of line wall.

**Indicator bolt**

Indicator bolt with emergency release facility and keep, all with concealed fixings.

**Pedestal**

Height adjustable for uneven floors with concealed fixings.

**Accessories**

Coat hooks and toilet roll holders available.

1 Pedestal | 2 Indicator bolt | 3 Hinge | 4 Cleat



## Technical Specifying Award

### Overall height

2100mm

### Floor clearance

100mm

### Door height

2000mm

### Maximum depth

MFC - 2000mm

HPL - 2000mm

SGL - 2000mm

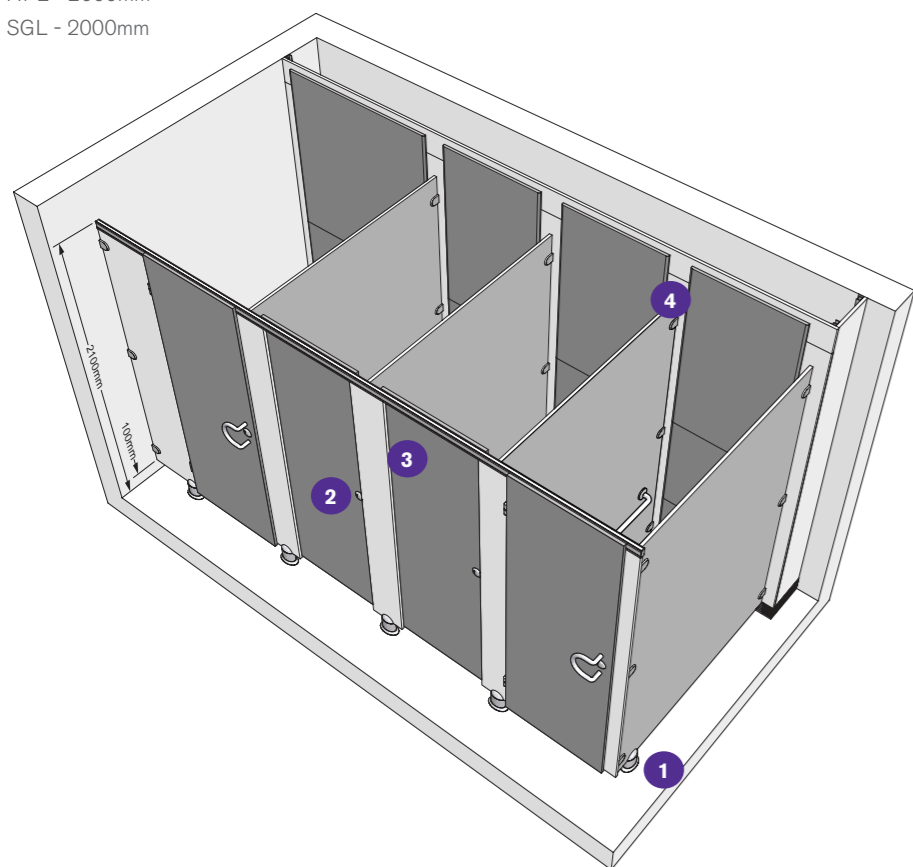

### Panels and doors

Available in MFC, HPL and SGL.

### Colour finish

**MFC, HPL and SGL**

12 colours.

### Cubicle hardware

ABS Graphite and Smoke.

Aluminium Light Grey and

Dark Grey.

### Edge treatment

**MFC and HPL**

Matching 1mm PVC lipping.

**SGL**

Polished black radiused edge.

### Headrail

Rigid aluminium channel in Light Grey and Dark Grey with matching end cap.

### Cubicle hardware

#### Hinge

Universal aluminium safety hinge.

#### Wall fixing

Cleat with through fixing and snap on outer case accommodates out of line wall.

#### Indicator bolt

Easy grip indicator bolt with emergency release facility and concealed fixings.

#### Pedestal

Height adjustable for uneven floors, with concealed fixings.

### Accessories

Coat hooks and toilet roll holders available.

1 Pedestal



2 Indicator bolt



3 Hinge



4 Cleat



## Technical Specifying Access

### Overall height

1950mm

### Floor clearance

150mm

### Maximum depth

MFC - 2000mm

HPL - 2000mm

SGL - 2000mm

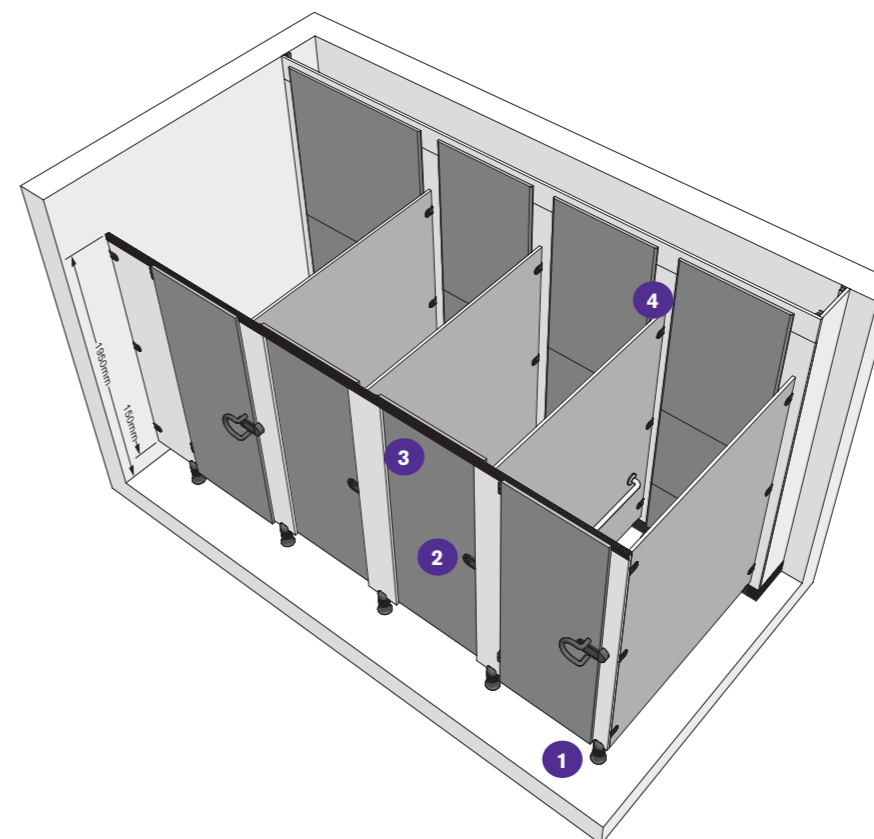

### Panels and doors

Available in MFC, HPL and SGL.

### Colour finish

**MFC, HPL and SGL**

8 colours.

### Cubicle hardware

ABS Graphite.

### Edge treatment

**MFC and HPL**

Matching 1mm PVC lipping.

**SGL**

Polished black radiused edge.

### Headrail

Rigid aluminium channel in Dark Grey.

### Cubicle hardware

#### Hinge

Universal aluminium safety hinge.

#### Wall fixing

Cleat with through fixing and anti-tamper securing device accommodates out of line wall.

#### Indicator bolt

Easy grip indicator bolt with emergency release facility and concealed fixings.

#### Pedestal

Height adjustable for uneven floors, with concealed fixings.

### Accessories

Coat hooks and toilet roll holders available.

1 Pedestal



2 Indicator bolt



3 Hinge



4 Cleat





**We know panelling.**  
At Venesta, we're renowned for our innovations in panelling. Whatever type of panelling you need, from our pioneering Integrated Plumbing System, IPS, to our cost-effective Rapiduct system, we've a fit for purpose solution to suit your needs.

# Panelling

**You're assured of the right solution.**  
 Venesta has a proven track record of supplying high quality panelling systems to the UK's most demanding education environments. Our long-standing partnership with Armitage Shanks and Ideal Standard gives you the flexibility to choose industry leading sanitaryware.

### IPS

**Pre-plumbed**

Inspired by your need for a speedy, one-stop-shop solution, we created the UK's first made to measure pre-plumbed system. IPS is a metal-framed, factory-made system that comes complete with fitted sanitaryware. Designed to suit all commercial sectors, what makes IPS unique is its click-fix mechanism and in-built flexibility which means you can install it quickly and efficiently. Plus, it comes complete with a factory-tested guarantee of quality.



### Frameduct

**Non-plumbed**

If you're looking for a sturdy, metal-framed panelling system but want the choice of specifying your own sanitaryware, then Frameduct is the ideal solution. It's made to measure and features a click-fix mechanism so it's quick and easy to install. Frameduct can be specified with any Venesta cubicle or vanity system.



### Rapiduct

**Timber-framed**

Simple, functional and highly cost-effective, this panelling system is flexible enough to suit any cubicle range. Unlike the other panelling options, Rapiduct is constructed onto a timber-frame, not supplied by Venesta, and is designed for your own build and installation. You can specify Rapiduct with any Venesta cubicle or vanity system.



Benefits	IPS	Frameduct	Rapiduct
To help you choose the right system for you, we've put together this at-a-glance benefits checklist.			
Factory fitted Armitage Shanks sanitaryware	•		
Choice of pre-plumbed WC suites, urinals, basins and vanity units	•		
Fully tested sanitaryware	•		
Speedy installation	•	•	•
Factory assembled guaranteeing a quality product and finish	•	•	
Unique click-fix metal frame	•	•	
Metal framework, impervious to water	•	•	
Product longevity	•	•	•
Existing sanitaryware can be used		•	•
Alternative sanitaryware options can be sourced		•	•
Lockable duct panel option	•	•	•
Conceals plumbing and services (wastes and traps)	•	•	•
Provides easy access for maintenance	•	•	•
Robust panel fixings	•	•	•
Choice of board types and edge details providing an offering to suit any application	•	•	•
Universal – it complements any cubicle range	•	•	•
10-year product guarantee	•	•	•



# IPS

A ground-breaking pre-plumbed system that ticks all the boxes. It's simple, it's flexible, and it's compatible with the widest range of products. Plus, there are only four easy steps to installation.



- 01** Once the site has been prepared, fix the aluminium site frame to the wall, ceiling and floor.
- 02** Click-fix the first IPS unit onto the frame and slide into position. Attach a vertical flashgap to the frame, on either side of the unit, screw-fixing to the frame from the face. Fix tie back to the wall. Repeat until all units are in place.
- 03** Once all the units are in position, connect the plumbing and services.
- 04** Simply attach the top and bottom panels to the units. Installation complete.

Unskilled labour required     Part-skilled labour required     Part-skilled labour required     Part-skilled labour required

25 minute installation     30 minute installation     10 minute installation\*     5 minute installation

The comparisons given between IPS, Frameduct and Rapiduct are a guide and are designed to help you choose the right product for your project. \* Dependent on brassware.

# IPS Sanitaryware



**Contour 21 back to wall WC**  
S305601 41cm height  
S305701 46cm height



**Sandringham back to wall WC**  
S304301



**Contour 21 wall hung WC**  
S307601



**Contour hy urinal**  
S611901 67cm height



**Contour urinal**  
S611001 66cm height



**Sandringham urinal**  
S610301



**Sandringham wall hung WC**  
V391001



**Contour 21 46cm height back to wall WC**  
S305501 70cm projection  
S305301 75cm projection

### WC seats

- S405601 Contour 21 small schools seat and cover, white, bottom fixing hinges (305)
- S405701 Contour 21 small schools seat only, white, bottom fixing hinges (305)
- S405901 Contour 21 standard seat only, white, bottom fixing hinges (355)
- S406501 Contour 21 seat and cover, white, top fixing hinges
- S406601 Contour 21 seat retaining buffers, white
- S406636 Contour 21 seat only, blue, retaining buffers, top fixing hinges (DOC M pack)
- S4066RN Contour 21 seat only, charcoal, retaining buffers, top fixing hinges (DOC M pack)
- S4032 Orion Plus seat and cover, white, metal pillars
- S4033 Orion Plus seat only, white, metal pillars

### DOC M pack

- S6954 Doc M Contour 21 back to wall pack with lever operated cistern, grab rails, seat and hinged arm support with toilet roll holder



**Orbit 21cm fully inset basin**  
S248601 1 tap hole  
S248801 2 tap holes



**Sandringham 50cm fully inset basin**  
S250701 1 tap hole  
S250801 2 tap holes

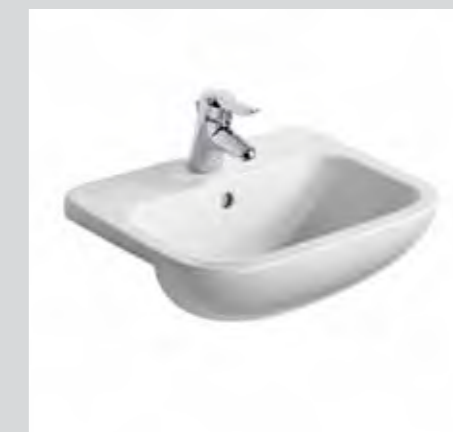

**Profile 50cm semi-recessed basin**  
S244101 1 tap hole  
S244001 2 tap holes



**Contour 21 schools back to wall WC**  
S304601 305mm height  
S304701 355mm height



**Sandringham 50cm semi-recessed basin**  
S245801 1 tap hole  
S245901 2 tap holes



**Portman 21 50cm panel mounted basin**  
S225401 right tap hole



**Portman 21 40cm panel mounted basin**  
S231401 right tap hole

# IPS Brassware and fittings



**Sensorflow 21 compact deck mounted**  
A4852AA mains A4853AA link



**Avon 21 basin mixer**  
B8263AA



**Avon bib wall mounted tap**  
S7241AA

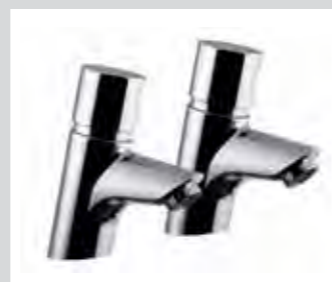

**Avon 21 pillar taps**  
B8267AA pair



**Nuastyle 21 pillar taps**  
B8262AA pair



**Sandringham monoblock mixer**  
B4447AA



**Sandringham pillar taps**  
S7029AA pair



**Sensorflow WC and urinal flush**  
S358967 6 litre WC flush  
S359967 4.5 litre WC flush  
A4854AA mains A4855AA link



**Armitage Shanks unbranded dual flush plate**  
S4399AA chrome plated



**Pneumatic panel mounted palm push button**  
S4513MY stainless steel



**Chrome plated lever**  
CO35N20CP



**Shower in a box**  
S6933



**Sensorflow 21 shower control**  
S4185AA mains  
S4186AA link



**Contour 21 push button shower valve**  
B8266 chrome plated



**Triton swivel mounted shower head/shower arm**  
S9312 shower head  
S9329 shower arm



**Short projection shower head**  
S9313AA

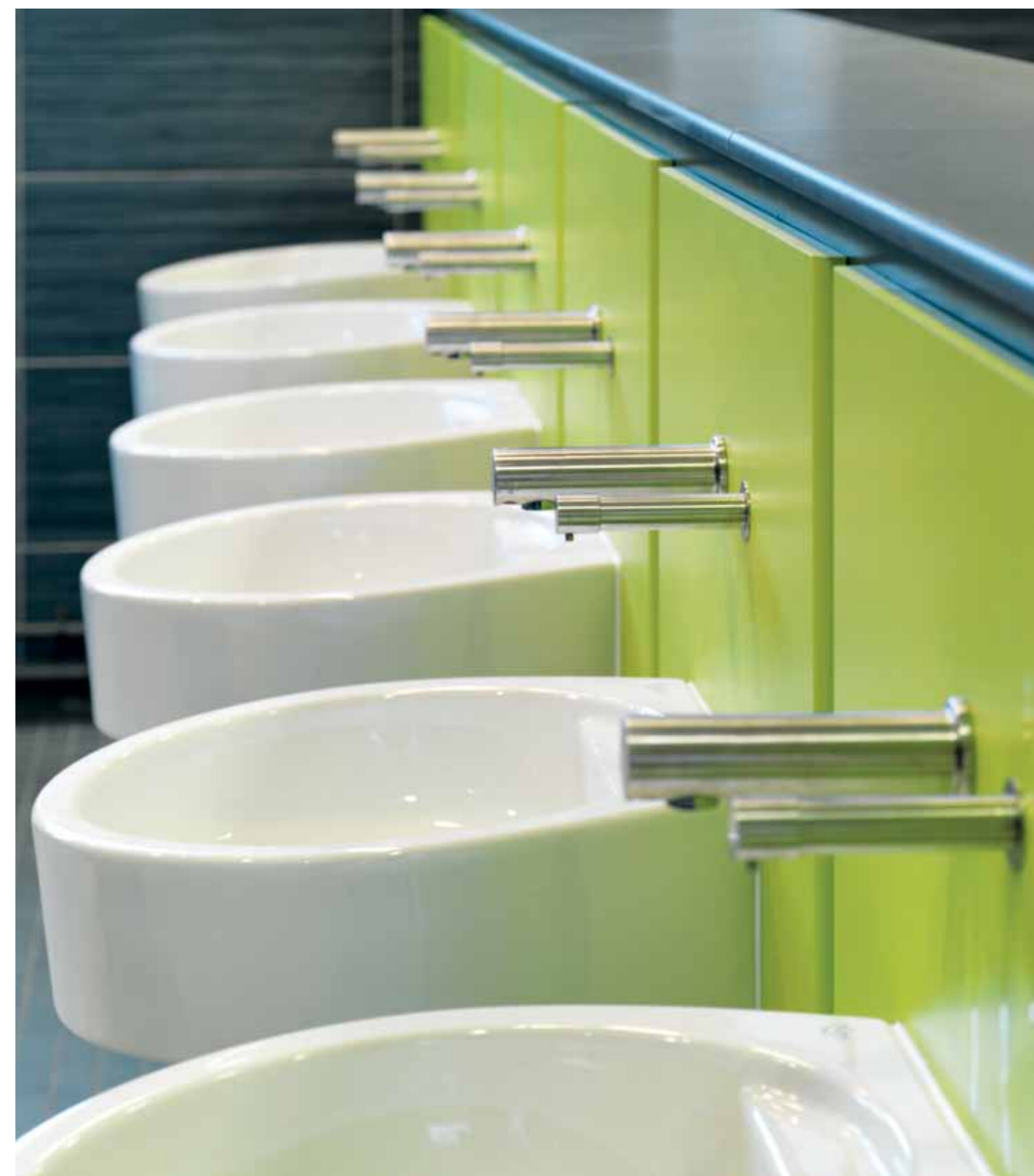

# Frameduct

Frameduct brings you an intelligent, great looking system that's easy to install but with one added extra – you get to choose your own sanitaryware.

Frameduct's superbly crafted, metal-framed panelling has been created to give you quick and easy installation. Its clever click-fix mechanism is simplicity itself. Not only that, Frameduct gives you the opportunity to choose your own sanitaryware.

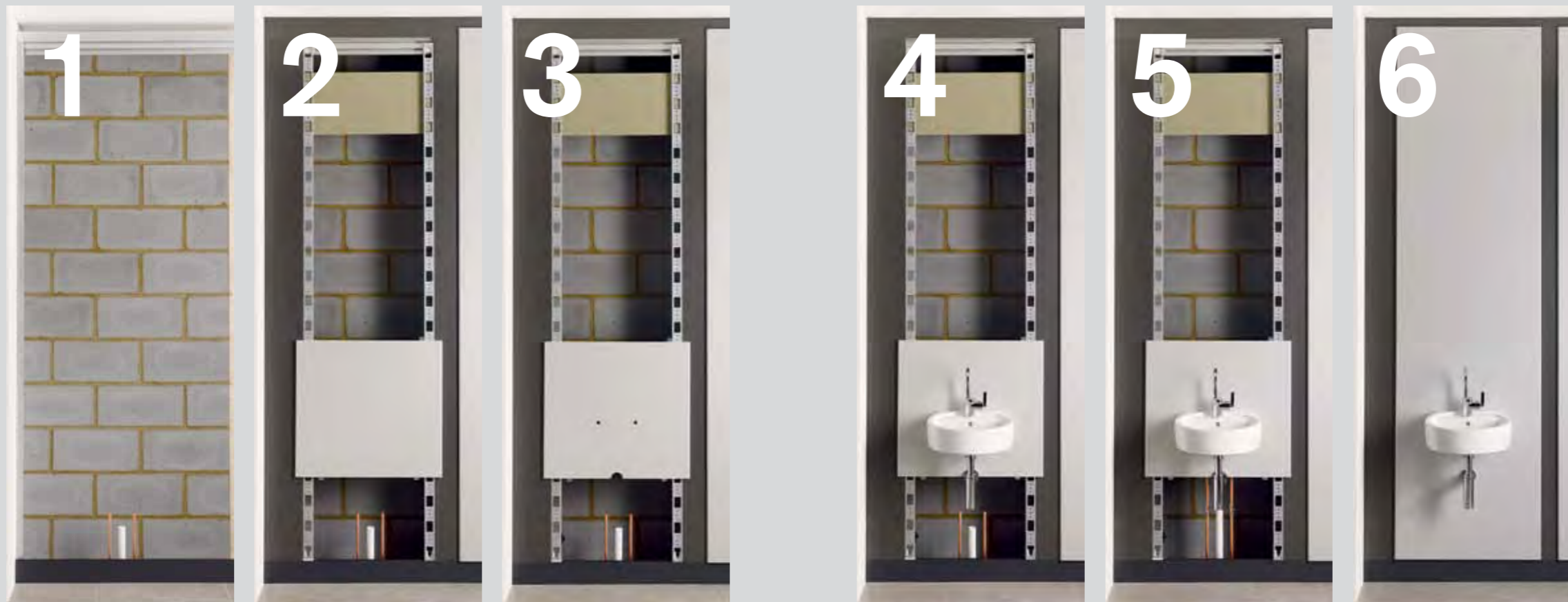

**01** Once the site has been prepared, fix the aluminium site frame to the wall, ceiling and floor.

**02** Click-fix the first IPS unit onto the frame and slide into position. Attach a vertical flashgap to the frame, on either side of the unit, screw-fixing to the frame from the face. Fix tie back to the wall. Repeat until all units are in place.

**03** Drill or cut out for sanitaryware.

**04** Mount sanitaryware and brassware.

**05** Once all the units are in position, connect the plumbing and services.

**06** Simply attach the top and bottom panels to the units. Installation complete.

Unskilled labour required

Part-skilled labour required

Part-skilled labour required

Part-skilled labour required

Part-skilled labour required

Part-skilled labour required

20 minute installation

30 minute installation

10 minute installation

20 minute installation

10 minute installation\*

5 minute installation

The comparisons given between IPS, Frameduct and Rapiduct are a guide and are designed to help you choose the right product for your project.  
\* Dependent on brassware.

# Rapiduct

Simple, functional and highly cost-effective, this timber-framed panelling system is flexible enough to suit any washroom and is designed for your own installation. You can specify Rapiduct with any Venesta cubicle or vanity system.

The best value for function, finish and easy installation. Once delivered, Rapiduct's clever construction means it can be put together in the shortest time.



**01** Install timber frame (supplied by others).

Part-skilled labour required

30 minute installation



**02** Fit base flashgaps to the site frame followed by vertical, horizontal and top flashgaps.

Part-skilled labour required

20 minute installation



**03** Attach fixing clips to the inside edge of the vertical flashgaps, repeat process on back face of panels.

Part-skilled labour required

30 minute installation



**04** Drill or cut out for sanitaryware.

Part-skilled labour required

10 minute installation



**05** Mount combined panel, sanitaryware and brassware onto flashgaps before completing pipework.

Part-skilled labour required

20 minute installation

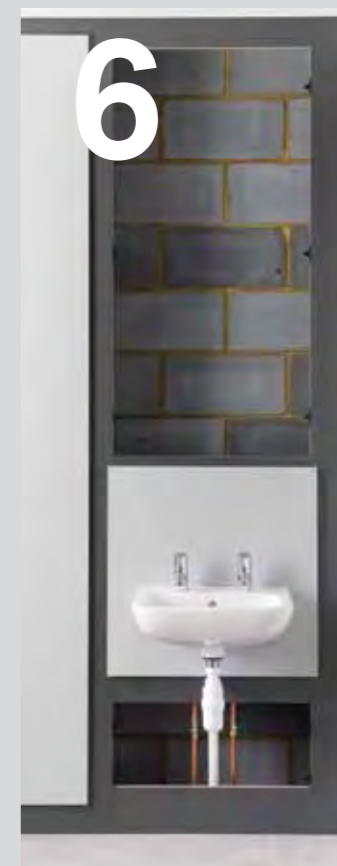

**06** Once all the units are in position, connect the plumbing and services.

Part-skilled labour required

10 minute installation\*



**07** Simply attach the top and bottom panels to the units. Installation complete.

Part-skilled labour required

5 minute installation

The comparisons given between IPS, Frameduct and Rapiduct are a guide and are designed to help you choose the right product for your project.  
\* Dependent on brassware.

# Technical Specifying IPS

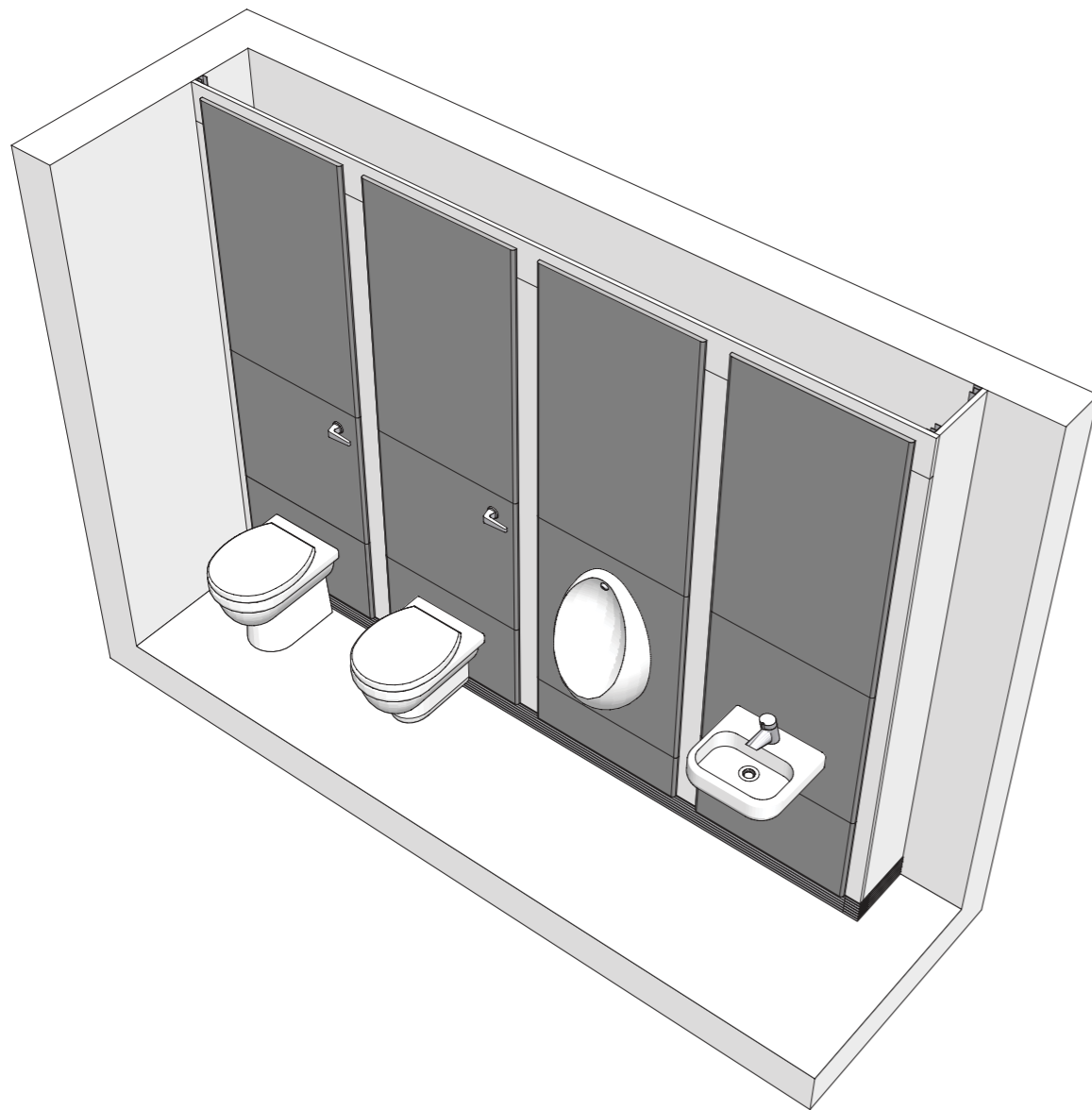

## Dimensions

**Maximum ceiling height**  
3040mm.

**Skirting/baserail height**  
Available in 105mm and 50mm  
(other skirting heights achievable  
by site packing the baserail).

**Top flashgap**  
45mm.

Shelf height option.

Minimum shelf heights and panel widths  
are dependant upon sanitaryware.

## Sanitaryware

**WCs**

**Basins**

**Urinals**

**Showers**

**Washtroughs**

**Drinking fountains**

**Bidets**

**Cleaners sinks**

**Squat pans**

**Baths**

**Healthcare items**

## Performance

Available in 3 material options,  
IPS is suitable for every type of wet  
or dry environment allowing you to  
specify the most appropriate panel  
option to meet the site requirements  
and your budget.

### MFC

For dry environments with low risk  
of vandalism. Panels are manufactured  
from 18mm nominal thickness high  
performance moisture-resistant  
melamine faced chipboard. Edges  
lipped with PVC.

### HPL

For more heavily used washrooms,  
panels are heat, scratch and impact  
resistant. Manufactured from moisture-  
resistant chipboard faced with high  
pressure laminate, panels are 18mm  
nominal thickness. Edges lipped  
with PVC. Post-formed vertical edge  
option available.

### SGL

Solid grade laminate is extremely  
resistant to impact and all surfaces  
are impervious to water. Panels are  
13mm nominal thickness with polished  
black radiused edges.

## Detailing

### Panels

Available in MFC, HPL and SGL.

### Flashgaps

MFC or SGL.

### Colour finish

**MFC, HPL and SGL**  
36 colours.

### Edge treatment

#### MFC

HPL

Vertical edges post-formed or  
matching 1mm PVC lipping.

#### SGL

Polished black radiused edge.

### Flashgaps

Flashgaps have unfinished edges  
except return end flashgaps  
which will be 1mm PVC lipped  
(or polished if solid grade laminate).

### Site frame

Headrail, baserail and corner  
channels manufactured from  
extruded aluminium section.

### Subframes

Manufactured from rolled galvanised  
steel section with chipboard bracing  
board. Subframe installed within  
aluminium site frame by click-fix  
nylon location brackets. Back panels  
fixed to steel section by BZP mild  
steel joggle clips.



## Technical Specifying Frameduct

### Dimensions

**Maximum ceiling height**  
3040mm.

**Skirting/baserail height**

Available in 105mm and 50mm (other skirting heights achievable by site packing the baserail).

**Top flashgap**

45mm.

Shelf height option.

### Performance

Frameduct is available in 3 material options – MFC, HPL and SGL (see p65) suitable for every type of wet or dry environment that is likely to be encountered, allowing you to specify the most appropriate option to meet the site requirements and your budget.

### Detailing

**Panels**

Available in MFC, HPL, SGL ColourCoat and Veneer.

**Flashgaps**

MFC or SGL.

**Colour finish**

**MFC, HPL and SGL**

36 colours.

**Edge treatment**

**MFC**

Matching 1mm PVC lipping.

**HPL**

Vertical edges post-formed or matching 1mm PVC lipping.

**SGL**

Polished black radiused edge.

**Flashgaps**

Flashgaps have unfinished edges except return end flashgaps which will be 1mm PVC lipped (or polished if solid grade laminate).

**Site frame**

Headrail, baserail and corner channels manufactured from extruded aluminium section.

**Subframes**

Manufactured from rolled galvanised steel section with chipboard bracing board. Subframe installed within aluminium site frame by click-fix nylon location brackets. Back panels fixed to steel section by BZP mild steel joggle clips.

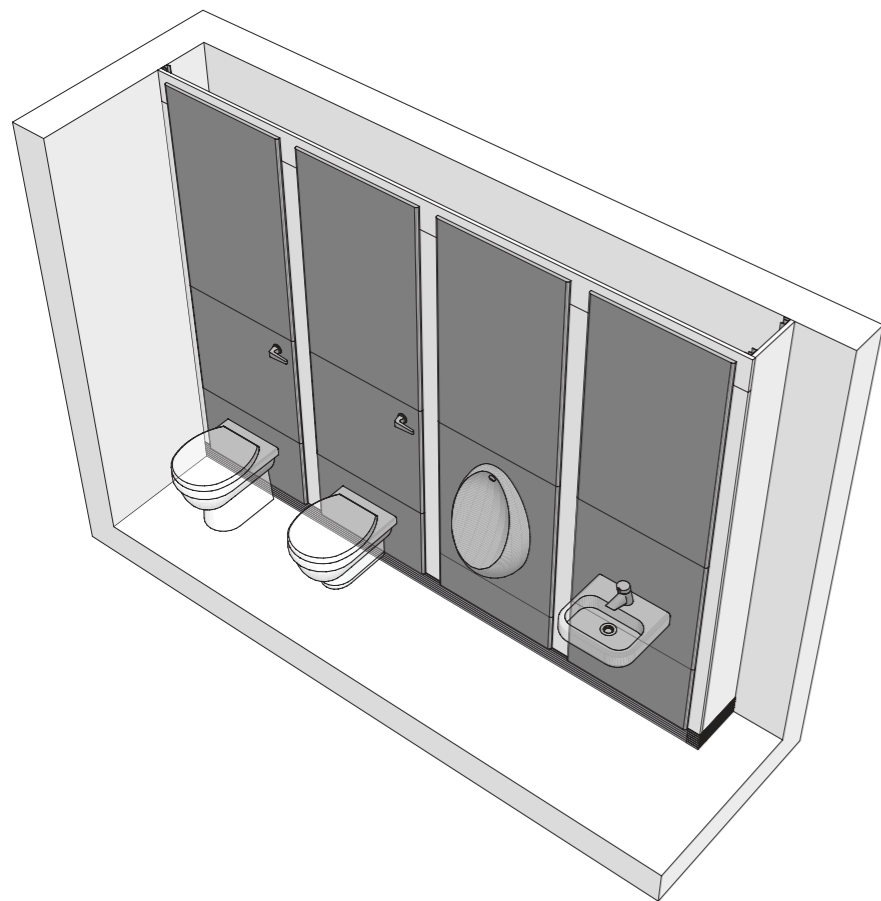

## Technical Specifying Rapiduct

### Dimensions

Bespoke panel sizes available to suit site dimensions.

### Performance

Rapiduct is available in 3 material options – MFC, HPL and SGL (see p65) suitable for every type of wet or dry environment that is likely to be encountered, allowing you to specify the most appropriate option to meet the site requirements and your budget.

### Detailing

**Panels**

Available in MFC, HPL and SGL.

**Flashgaps**

MFC or SGL.

**Colour finish**

**MFC, HPL and SGL**

36 colours.

**Edge treatment**

**MFC**

All edges are lipped with PVC. HPL

Vertical edges post-formed or matching 1mm PVC lipping.

**SGL**

Polished black radiused edge.

**Flashgaps**

Flashgaps have unfinished edges except return end flashgaps which will be 1mm PVC lipped (or polished if solid grade laminate).

**Fixing clips**

Two part black plastic fixing clips for site fixing to panels and flashgap.

**Site frame**

Loose flashgaps only supplied by Venesta. Site frame supplied and fixed by site (softwood or similar).

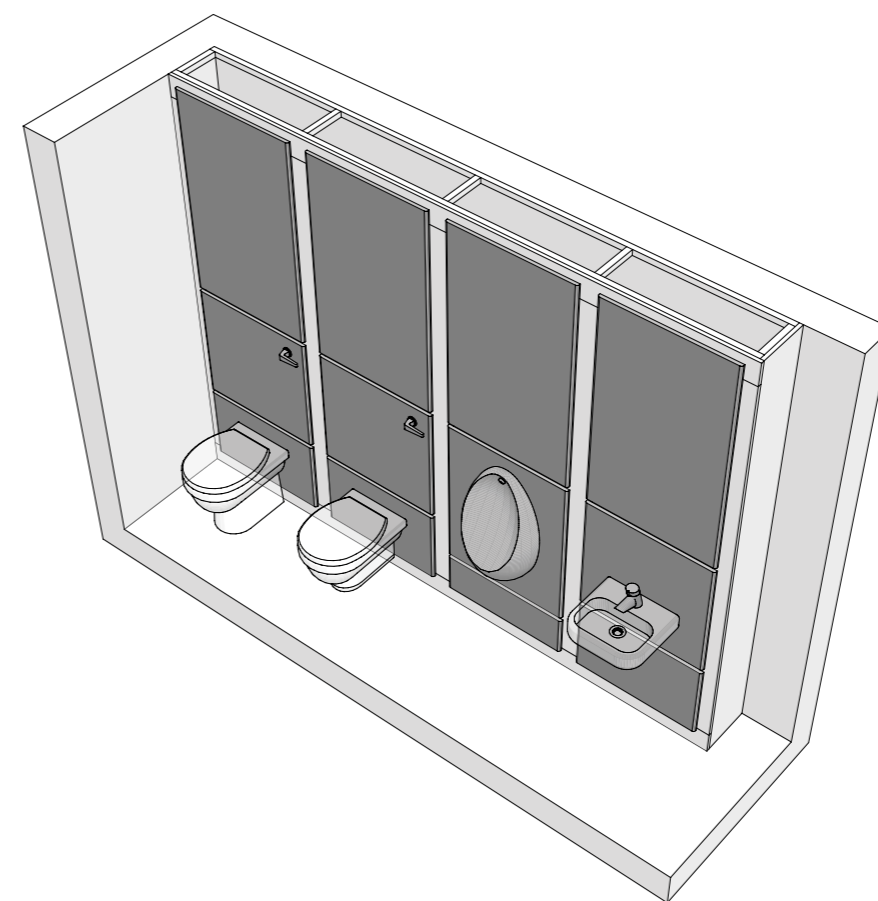

**We know washrooms.**

To meet your demands, our range of vanities, accessories, lockers and benches bring form and function together in one collection.

Complementary

## Vanities Solid Surface

For luxury, strength and a smooth, seamless finish, our Solid Surface solution wins hands down. Its stone appearance offers a visually stunning yet highly practical installation.



## Vanities SGL

The most demanding environments need hard-working solutions to match. This solid grade laminate (SGL) is built to last and is totally impervious to water; plus, it comes in a choice of 36 colours.



**01** Solid Surface wash trough in Vermont with Avon 21 mixer taps

**02** Solid Surface vanity in Krakatoa and Iceberg with integrated basins and Avon 21 mixer taps

**03** SGL vanity in Oxford Blue, Skye and Baby Blue with Concept Sphere semi-recessed basins and Avon 21 mixer taps

**04** SGL vanity in Iceberg, Green Stipple and Eucalyptus with Orbit basins and Avon pillar taps

To view the range of Solid Surface, SGL and HPL vanity profiles please turn to p72.

## Vanities HPL

High pressure laminate (HPL) is highly economical, delivering top marks on design and a superb choice for any dry environment. Ensuring maximum choice, it comes with a selection of vanity profiles and 36 colour options.



**Main image**  
HPL Lollipop vanity in Colours screen print, Jamboree and Baby Blue

**01** HPL Surf vanity unit in Teal, Jive and Monsters screen print with Profile semi-recessed basins and Avon 21 mixer taps

**02** Baby change unit in Iceberg, Green Stipple and Eucalyptus with Orbit basins and Tratto lever monoblock taps

**03** HPL K2 vanity in Jive and Wisteria

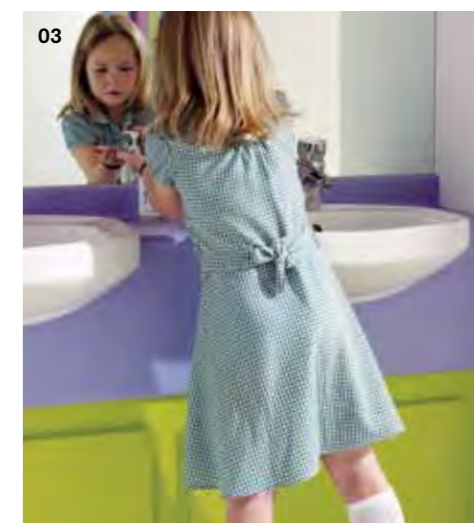

# Technical Specifying Vanities

Reduced vanity bed heights available for children's vanities; Junior 750mm, Infant 675mm and Nursery 600mm.

**Solid Surface** 13.5mm blend of acrylic polymer minerals with integral moulded-in-reinforcements that provide impact and thermal shock resistance. In order to help maintain pristine conditions, Solid Surface Maintenance Care Kits are available from Venesta. Suitable for heavy duty applications.

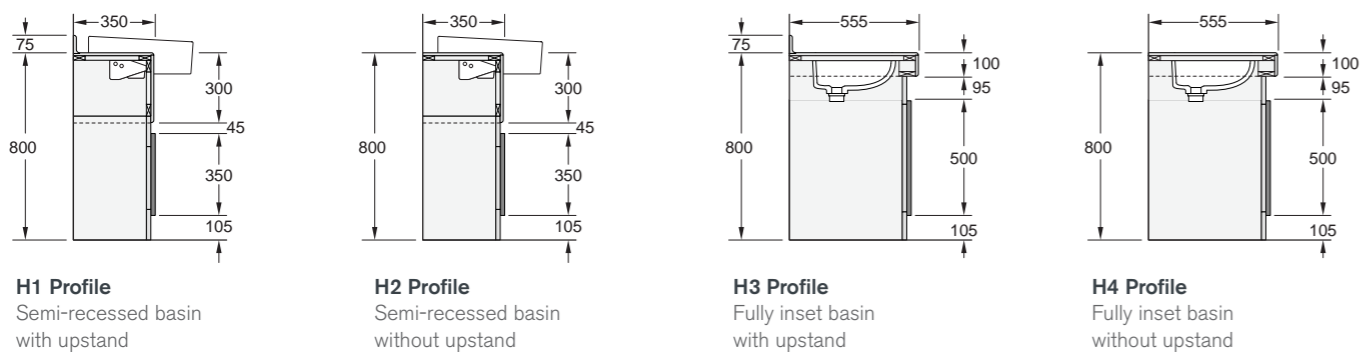

**SGL** Suitable for wet and heavy duty applications. 12.5mm nominal thickness with polished black radiused edges. SGL vanities come with powder coated aluminium extrusions in Light Grey and Dark Grey.

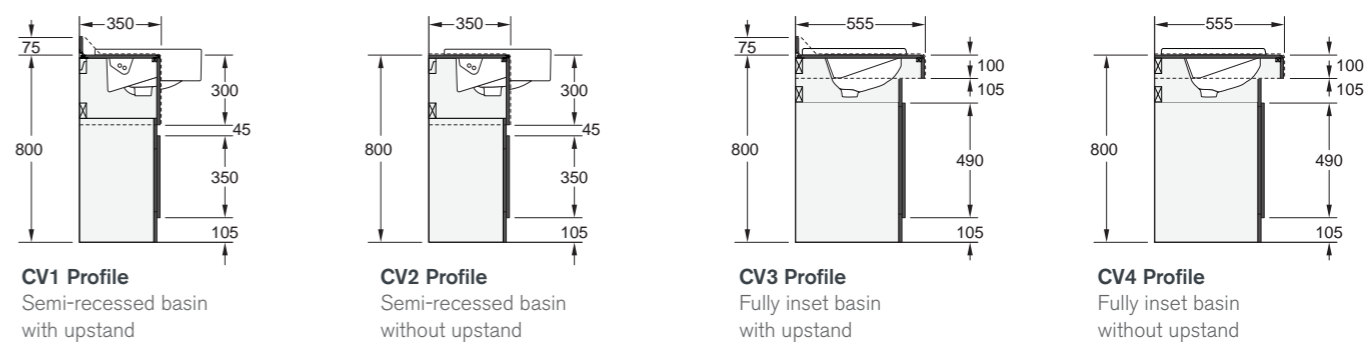
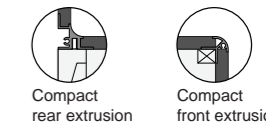

**HPL** For light and medium duty applications. High performance moisture resistant chipboard faced with high pressure laminate with post-forming to horizontal edges of under panels. Vertical edges are lipped with PVC.

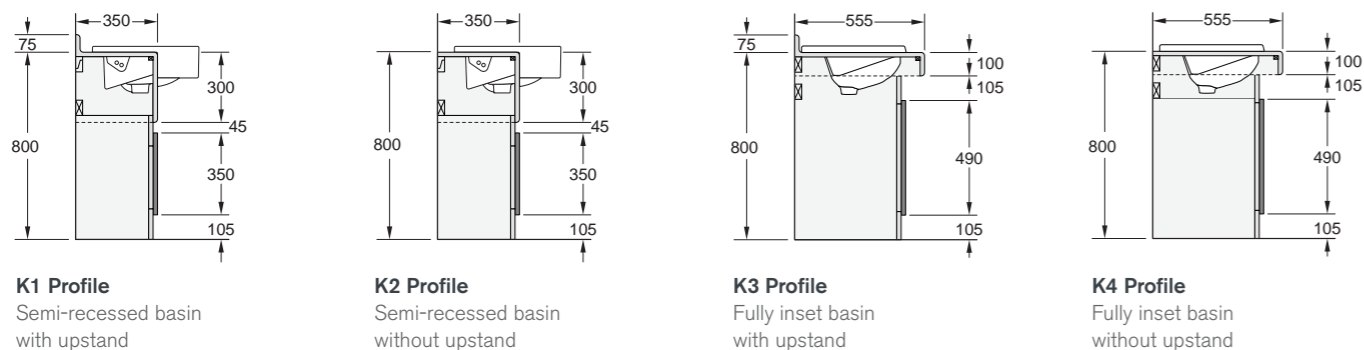

**Light pelmets** All fixing brackets included. Broken line indicates return end detail.

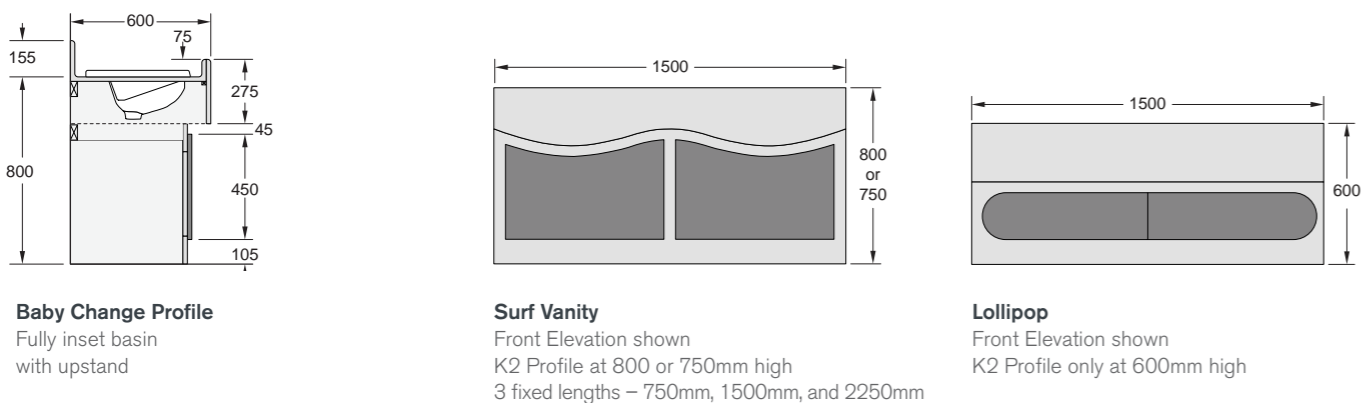
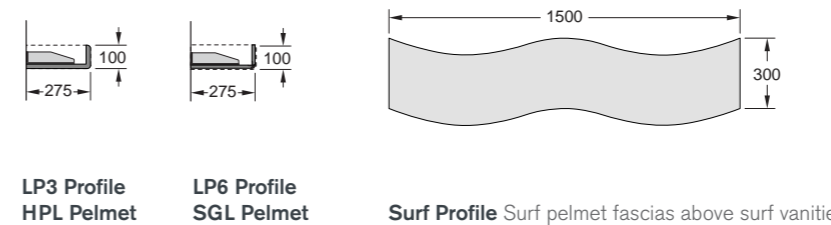

**Solid Surface Washtroughs** 13.5mm blend of acrylic polymer minerals with integral moulded-in-reinforcements that provide impact and thermal shock resistance. In order to help maintain pristine conditions, Solid Surface Maintenance Care Kits are available from Venesta. Suitable for heavy duty applications.

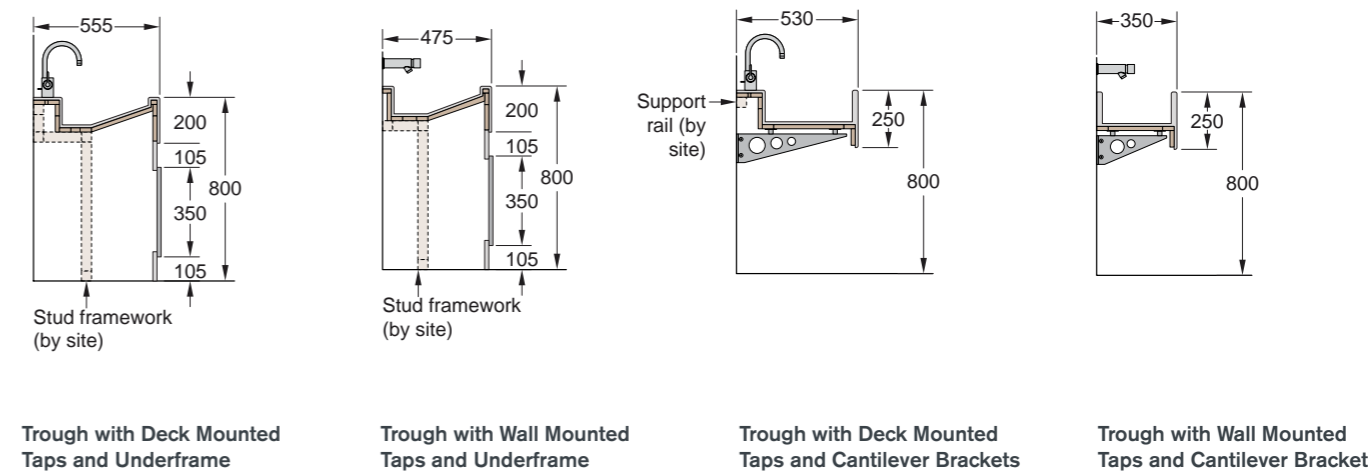

## Lockers and benches

For over 25-years, we've been designing and manufacturing benches and lockers for leisure centres and education environments. So, whatever environment you're working in, you can rely on our stylish and flexible, tried and tested locker and bench solutions to seamlessly fit and perfectly enhance your space.

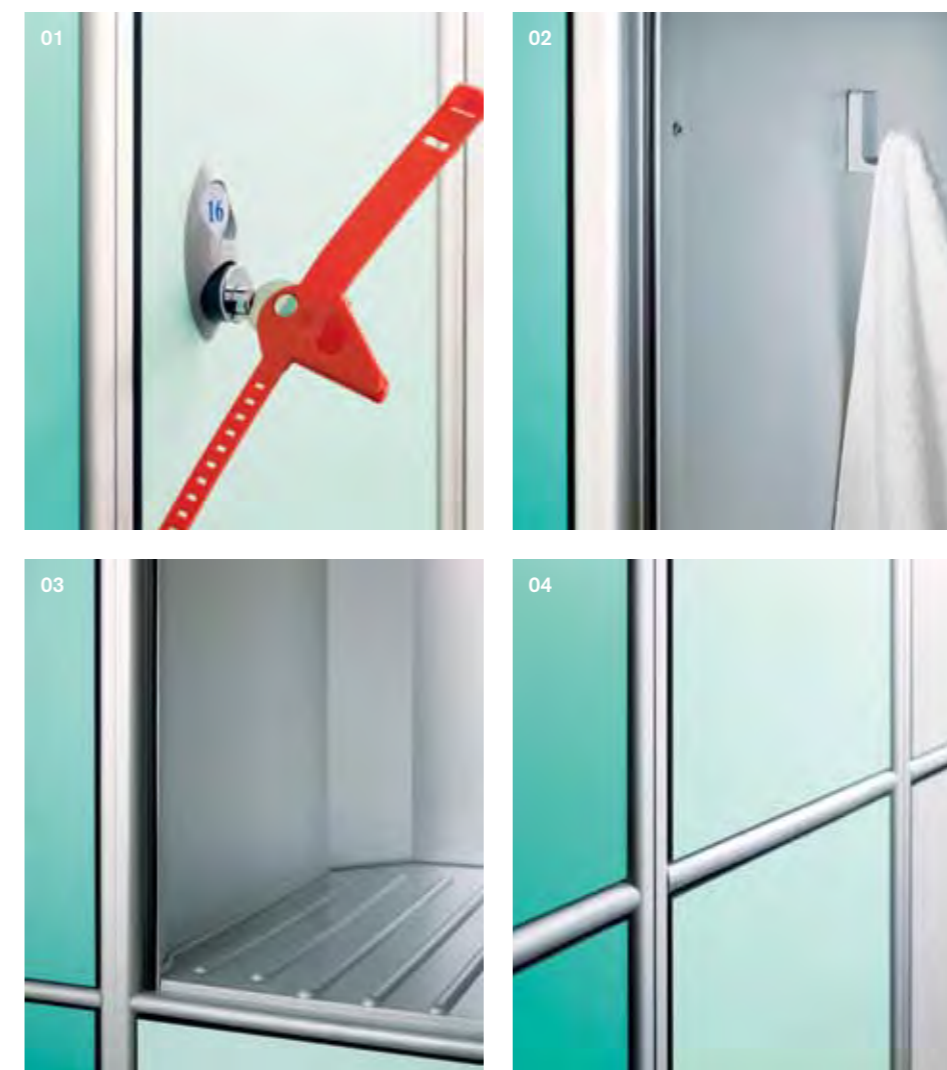

**Main image**  
Active lockers, model 3,  
in Iceberg, Eucalyptus  
and Spearmint and  
perimeter benches

**01** Coin return lock  
with wristband

**02** Internal coat hook

**03** Injection moulded  
locker base

**04** Locker door  
frame detail

**05** Cam lock

**06** Coin return lock

**07** Electronic lock

**08** Coin retain lock

**09** Hasp lock

See p76-77 for  
lockers and benches  
technical specification



# Technical Specifying lockers and benches

## Lockers

### Active locker

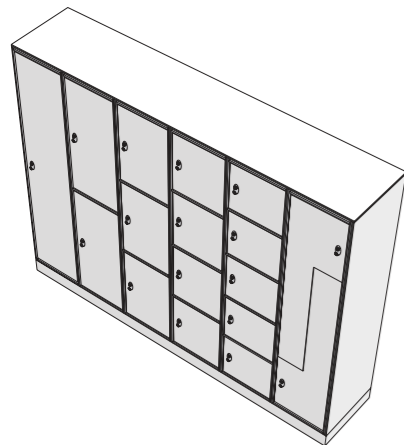

#### Opening sizes

<b>Model 1</b>	1740 x 280mm
<b>Model 2</b>	855 x 280mm
<b>Model 3</b>	560 x 280mm
<b>Model 4</b>	410 x 280mm
<b>Model 5</b>	325 x 280mm
<b>Model Z</b>	1310 x 380mm

### Bench locker

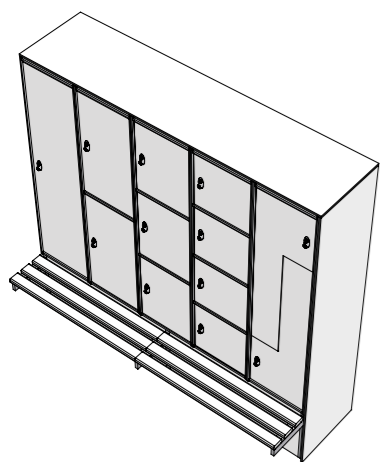

#### Opening sizes

<b>Model 1</b>	1400 x 280mm
<b>Model 2</b>	693 x 280mm
<b>Model 3</b>	456 x 280mm
<b>Model 4</b>	337 x 280mm
<b>Model Z</b>	1055 x 380mm

### Overall height

Active lockers	1800mm
Bench lockers	1460mm from bench level

### Widths

310mm (not applicable to Model Z)  
410mm

### Colour finish

36 colours.

### Locks

- Coin retain.
- Coin return.
- Cylinder/cam lock.
- Electronic.
- Hasp (padlock by others).

### Accessories

- Numbers for locker doors.
- Corresponding wristband colour – red or blue.

### Performance

Aluminium carcass only.  
Solid grade laminate (SGL) doors only.

### Active lockers key features

- Robust and hardwearing.
- Injection moulded tray.
- Satin anodised aluminium carcass.
- Integrated hinge design.
- Available in 310 or 410mm door widths.
- 13mm solid grade doors.
- Choice of locking mechanisms.
- Suitable for wet and dry environments.
- Practical in design and functionality.
- High impact resistant.

### Active doors

13mm thick solid grade laminate that offers a high impact resistance and is impervious to water.

### Hinge

Strong integral sprung aluminium extruded hinge which returns the door to the closed position.

### Body

Silver satin anodised aluminium extruded frame, together with 1mm thick matching aluminium carcass provides a sturdy body assembly.

### Dividers

Hygienic, easy to clean, metallic grey injection moulded horizontal dividers.

### Ventilation

3mm space between the doors and the frame allows air to circulate through the locker.

### Stands

Venesta recommends that the lockers be installed on a raised, concrete base in wet areas. Please contact our sales team for details.

Alternatively, the lockers can be mounted on a powder coated cantilevered bench.

## Benches

Our benches have been designed to provide strength, safety and flexibility. They feature solid beechwood slats, available in five styles each with complementary framework in a Light Grey nylon coated galvanised steel.

These bench systems are ideal for any of our washroom or cubicle systems, in both wet and dry environments.

Please note that bench stats are provided oversized to be cut down onsite.

### Perimeter cantilever

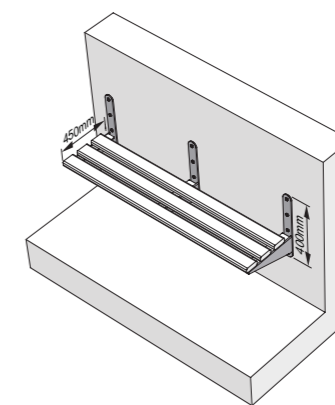

### Cubicle bench

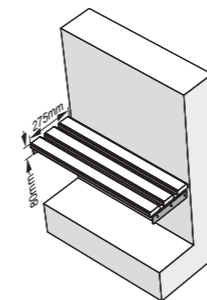

### Perimeter

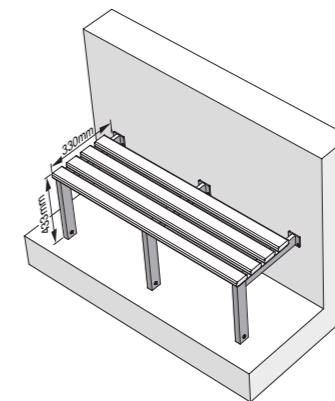

### Free-standing

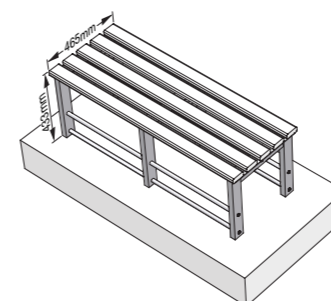

### Island

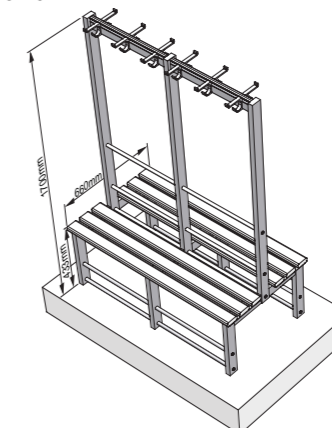

### Benching key features

- Designed for strength, flexibility and safety.
- Double corrosion protected, powder coated frame.
- Hardwearing solid beechwood slats.
- Available in five styles, each with complementary framework.
- Suitable for wet and dry environments.
- Designed for high level use.

### Profiles

- Perimeter.
- Perimeter cantilever.
- Cubicle benching.
- Island with integral coat hooks.
- Free-standing.
- Locker benching.

### Dimensions

Standard bench height 435mm.

### Performance

Solid beechwood slats only.  
Nylon coated galvanised steel – Light Grey only.

### Wall mounted coat hooks

Light Grey aluminium only.  
Quantity and position to suit customers' individual requirements.

### Wall mounted coat hook

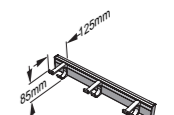

# Accessories

Contemporary designs that do the job perfectly – that's our accessory range. To make your life easier, we have everything from soap dispensers to bins, from door signs to coat hooks. It's all here ready for your selection.



**Liquid soap dispenser**  
White plastic  
Wall mounted dispenser for liquid soap with white ABS case and 900ml refillable reservoir.  
H250 x W115 x D115mm  
Code: 0302540



**Liquid soap/foam dispenser**  
Light Grey plastic  
Wall mounted dispenser for liquid soap/foam. Light Grey ABS case and stainless steel cover with 900ml refillable reservoir.  
H255 x W130 x D120mm  
Code: 0302513/0302514



**Liquid soap dispenser**  
Stainless steel  
Wall mounted stainless steel liquid soap dispenser with brushed satin finish, key lock and 900ml refillable reservoir.  
H265 x W100 x D95mm  
Code: 0302525



**Liquid soap dispenser**  
White metal  
Wall mounted white metal liquid soap dispenser with key lock and 900ml refillable reservoir.  
H265 x W100 x D95mm  
Code: 0302521



**Paper towel dispenser**  
White plastic  
Wall mounted white ABS towel dispenser for C-fold or interfold paper towels.  
H425 x W290 x D145mm  
Code: 0302537



**Paper towel dispenser**  
Light Grey plastic  
Wall mounted towel dispenser for C-fold or interfold paper towels made from Light Grey ABS with stainless steel cover.  
H325 x W325 x D150mm  
Code: 0302519



**Paper towel dispenser**  
Stainless steel  
Wall mounted stainless steel paper towel dispenser for C-fold or interfold towels with brushed satin finish and key lock.  
H372 x W255 x D124mm  
Code: 0302526



**Paper towel 30L waste bin**  
Stainless steel  
Stainless steel paper towel waste bin with brushed satin finish, bag holder and wall fixings.  
H552 x W355 x D163mm  
Code: 0302528



**Paper towel dispenser**  
White metal  
Wall mounted white metal paper towel dispenser for C-fold or interfold towels with key lock.  
H372 x W255 x D124mm  
Code: 0302522



**Paper towel 30L waste bin**  
White metal  
White powder coated metal paper towel waste bin with bag holder and wall fixings.  
H552 x W355 x D163mm  
Code: 0302524



**Midi-jumbo toilet roll dispenser**  
White plastic  
Wall mounted white ABS jumbo toilet roll dispenser.  
H325 x W280 x D145mm  
Code: 0302538



**Midi-jumbo toilet roll dispenser**  
Light Grey plastic  
Wall mounted dispenser for jumbo toilet roll paper with Light Grey ABS case and stainless steel cover plus spare stub roll.  
H350 x W260 x D140mm  
Code: 0302518



**Jumbo toilet roll dispenser**  
Stainless steel  
Stainless steel jumbo toilet roll dispenser with brushed satin finish, key lock and viewing slot.  
Ø298 x H308 x D114mm  
Code: 0302527



**Jumbo toilet roll dispenser**  
White metal  
White powder coated metal jumbo toilet roll dispenser with key lock and viewing slot.  
Ø298 x H308 x D114mm  
Code: 0302523



**Toilet tissue dispenser**  
White plastic  
Wall mounted white ABS toilet tissue dispenser.  
H275 x W150 x D130mm  
Code: 0302539

# Accessories



**Toilet tissue dispenser**  
Light Grey plastic  
Wall mounted dispenser for toilet tissue paper with Light Grey ABS case and stainless steel cover.  
H310 x W180 x D125mm  
**Code: 0302517**



**Toilet roll holder**  
White plastic  
White nylon single toilet roll holder with concealed wall fixings (lockable version also available).  
H130 x W155 x D25mm  
**Code: 0300301**



**Toilet roll holder**  
Light Grey plastic  
Light Grey nylon single toilet roll holder with concealed wall fixings (lockable version also available).  
H130 x W155 x D25mm  
**Code: 0300303**



**Toilet roll holder**  
Dark Grey plastic  
Dark Grey nylon single toilet roll holder with concealed wall fixings (lockable version also available).  
H130 x W155 x D25mm  
**Code: 0300146**



**Toilet roll holder**  
Light Grey aluminium  
Cast aluminium toilet roll holder with lockable single core in Light Grey powder coat finish.  
H50 x W174 x D88mm  
**Code: 0380071**



**Toilet roll holder**  
Satin chrome aluminium  
Cast aluminium toilet roll holder with lockable single core in satin chrome finish.  
H50 x W174 x D88mm  
**Code: 0380070**



**Toilet roll holder**  
Dark Grey aluminium  
Cast aluminium toilet roll holder with lockable single core in Dark Grey powder coat finish.  
H50 x W174 x D88mm  
**Code: 0380072**



**Male WC door sign**  
Stainless steel  
Stainless steel, self adhesive male WC door sign.  
Ø76mm  
**Code: 0302503**



**Female WC door sign**  
Stainless steel  
Stainless steel, self adhesive female WC door sign.  
Ø76mm  
**Code: 0302504**



**Disabled WC door sign**  
Stainless steel  
Stainless steel, self adhesive disabled WC door sign.  
Ø76mm  
**Code: 0302505**



**Cubicle door handles**  
Dark Grey aluminium  
Dark Grey powder coated aluminium C-profile cubicle door pull handles (pair).  
H175 x W150 x D80mm  
**Code: 0500101**



**Cubicle door handles**  
Polished aluminium  
Polished anodised aluminium C-profile cubicle door pull handles (pair).  
H175 x W150 x D80mm  
**Code: 0500102**



**Cubicle door handles**  
Light Grey aluminium  
Light Grey powder coated aluminium C-profile cubicle door pull handles (pair).  
H175 x W150 x D80mm  
**Code: 0500103**



**Grab rail**  
White aluminium  
Aluminium grab rail 600mm long with white polyester coated finish and concealed fixings.  
W600 x D95 x Ø35mm  
**Code: S6454AC**



**Grab rail**  
Satin chrome aluminium  
Aluminium grab rail 600mm long with brushed satin stainless steel coated finish and black concealed fixing flanges.  
W600 x D95 x Ø35mm  
**Code: S6454MY**



**Coat hook**  
White plastic  
White nylon light weight coat hook with concealed fixings.  
H50 x W20 x D38mm  
**Code: 0300201**



**Coat hook**  
Light Grey plastic  
Light Grey nylon light weight coat hook with concealed fixings.  
H50 x W20 x D38mm  
**Code: 0300139**



**Coat hook**  
Dark Grey plastic  
Dark Grey nylon light weight coat hook with concealed fixings.  
H50 x W20 x D38mm  
**Code: 0300137**



**Automatic warm air hand dryer**  
Stainless steel  
Surface mounted automatic warm air hand dryer with brushed stain stainless steel case.  
H277 x W274 x D135mm  
**Code: 0302019**



**Automatic warm air hand dryer**  
White metal  
Surface mounted automatic warm air hand dryer with white painted cast aluminium case.  
H269 x W336 x D191mm  
**Code: 0302005**



**Automatic high speed hand dryer**  
Metallic Silver  
Compact high speed hand dryer with low energy consumption, touch-free start/stop sensor and metallic silver cast aluminium cover.  
H300 x W280 x D175mm  
**Code: 0302535**



**Automatic high speed hand dryer**  
White metal  
Compact high speed hand dryer with low energy consumption, touch-free start/stop sensor and white cast aluminium cover.  
H300 x W280 x D175mm  
**Code: 0302533**



**Automatic hand wash station**  
Brushed satin stainless steel  
Recessed mounted hand wash station with auto hand rinse, soap and warm air dryer. Brushed satin stainless steel case.  
H815 x W422 x D175mm  
**Code: 0302024**



# We know good service.

## The quality of our products is only half the story. We know that excellent service can make all the difference to your satisfaction.

### Our 6-stage service plan

Whether it's a simple vanity unit or an extensive refit, you'll always find we go the extra mile to ensure you're happy. Here's our 6-stage service plan.

#### Stage 1 Specification

Our friendly and knowledgeable team of specification managers will help you choose the most suitable products for your project, visiting you onsite and surveying your area before quoting if needed. If you need help specifying, our NBS specification writing service is available free of charge to guide you through all the detail. Remember, whenever you need advice of any kind, just call our helpful sales team, who can also provide you with product literature and samples. And during the specification process, our dedicated technical helpline offers you all the technical support you need.

#### Stage 2 Estimating

Our estimating service levels have never been stronger; it's our aim to never deliver a late quotation. And, because we pride ourselves on our attention to detail, our comprehensive quotations always give the most detailed breakdowns of materials and prices. Don't forget, our dedicated technical helpline is here to give you technical support on all our products at any stage of the estimating and ordering process.

#### Stage 3 CAD

Once your order is placed, our highly skilled CAD technicians will prepare layout drawings. At this stage, you'll be given a dedicated CAD technician to work with you throughout your project. Everything from dimensions, colours and drawings can be sent for your approval prior to manufacture.

#### Stage 4 Manufacture and delivery

We're committed to delivering your order as soon as we possibly can, wherever you are in the country. With that in mind, we've invested £5m in state of the art machinery – allowing us to streamline our manufacturing process to make it more efficient than ever before. 100% on time, in full with no errors is our aim and we monitor our performance closely to ensure we can deliver on this.

#### Stage 5 Installation

Our highly responsive technical helpline is here to give you technical support throughout the installation process. It's worth remembering that although we're a supply only company, if you need fitting too, there are accredited installers we can recommend who have vast experience installing our products. Accredited installers undergo rigorous training and an approval process so you can be assured of a top quality job.

#### Stage 6

##### After sales support and spares

Once your products have been delivered, we'll give you your own dedicated point of contact to efficiently deal with all your after sales needs. Attentive and highly empathetic to your needs, they'll ensure you're completely happy at all times with our service. However, if you're not satisfied, for whatever reason, rest assured we offer replacements within 48-hours. Our friendly and helpful customer service team will be in touch with you 48-hours after delivery to ensure everything is in order.

One final thing, at Venesta, we appreciate customer feedback; it helps us to ensure we can continue to improve what we do in line with your needs. So, if you have any comments on our products or service, we want to hear them. You can call us on 01474 353333.



01

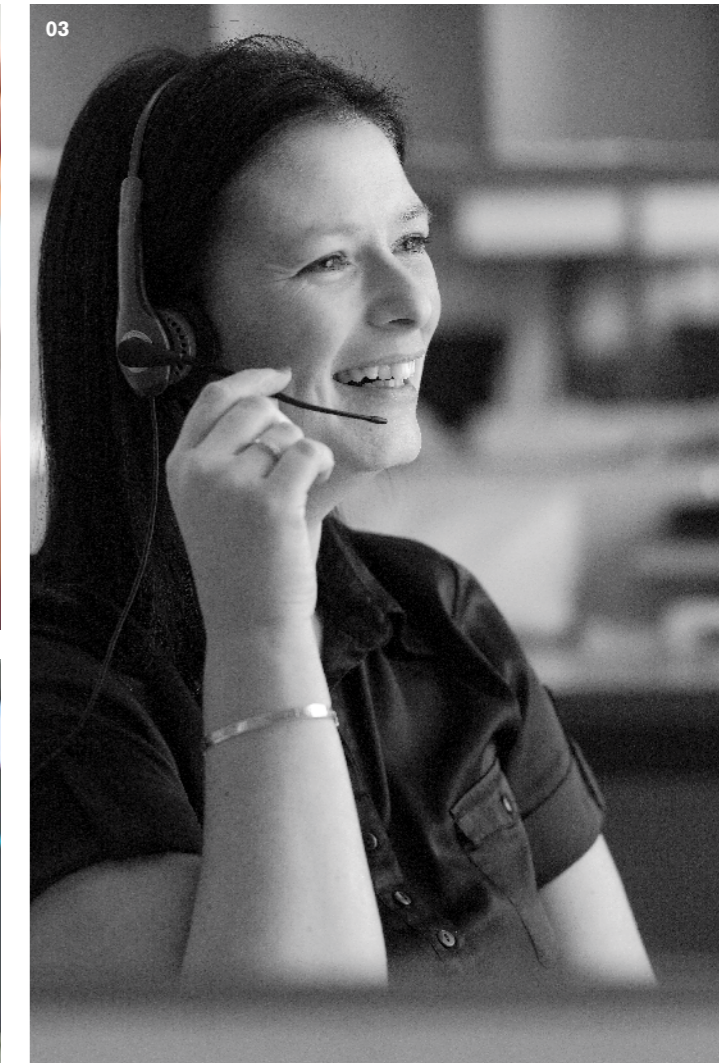

03

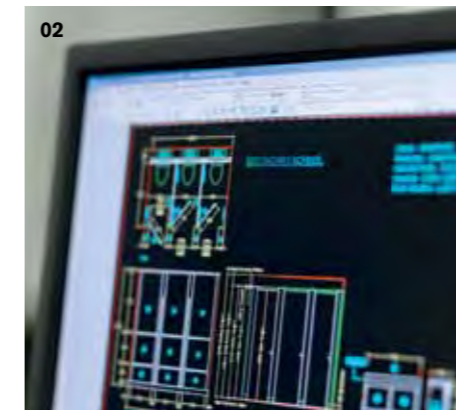

02



04

#### 01 Sample service

Our helpful sales team can provide you with product literature and samples

#### 02 Technical drawings

Everything from dimensions, colours and drawings can be sent for your approval prior to manufacture

#### 03 Dedicated technical helpline

When you're ready to specify, our dedicated technical helpline offers you all the technical support you need

#### 04 Design team

A specification manager will meet you face-to-face to help you choose the most suitable products for your project

# We know washrooms. Your partner, every step of the way.

Venesta people are passionate about ensuring you get the very best product and service, whatever the size of the project. That's why, from your first enquiry through to installation and beyond, you'll have a team of talented and committed experts working tirelessly to ensure you're happy and satisfied.

At Venesta, we believe it's our people that make the real difference to our business success. Everyone is an expert in their field, from our highly creative CAD team to our efficient and responsive project managers and our dedicated manufacturing team. Their experience and professionalism is what underpins the quality of our customer relationships.

