

# I MEADRAIN PG

DRAINAGE SYSTEM  
FOR MULTI-STOREY CAR PARKS



## **MULTI-STOREY CAR PARK CHANNEL MEADRAIN PG**

DRAINAGE SOLUTIONS FOR UNDERGROUND AND MULTI-STOREY CAR PARKS

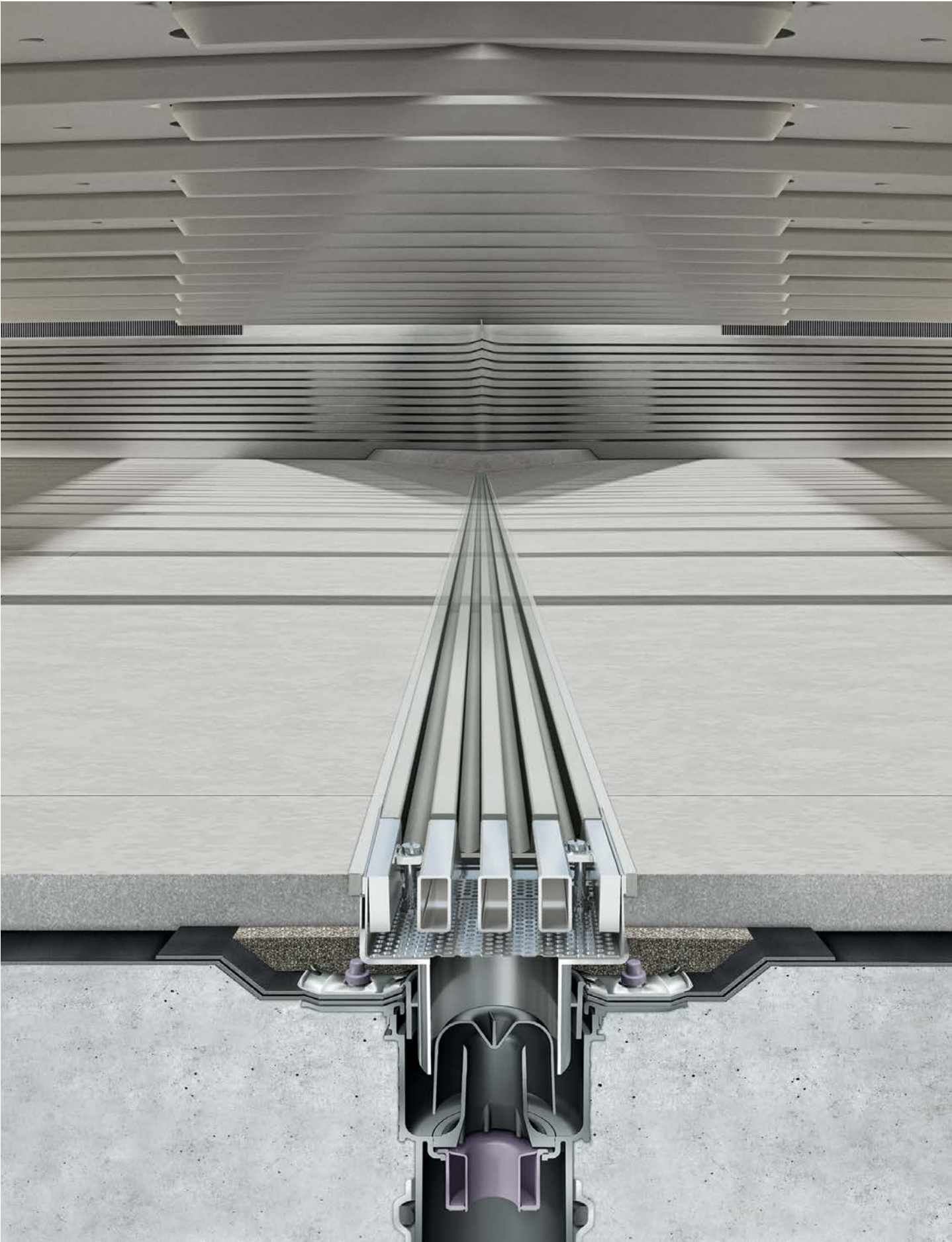



# MEADRAIN PG

PROFESSIONAL, INTELLIGENT, SAFE

#### **ADVANTAGES**

- > Barrier-free
- > Quiet when crossed by vehicles
- > Easy to clean
- > Easy to install
- > Extremely robust
- > Corrosion-free
- > Sealable
- > End-to-end system solution

# MEADRAIN PG SYSTEM OVERVIEW



**MEADRAIN PG 1000**

Clear width: 100 mm  
Height: 50 mm  
Length: 1000 mm

- > Flat channel made of polymer concrete with comb profile
- > With integrated sealing fold
- > Loading class A 15 to C 250



**MEADRAIN PG 1500**

Clear width: 150 mm  
Height: 50 mm  
Length: 1000 mm

- > Flat channel made of polymer concrete with comb profile
- > With integrated sealing fold
- > Loading class A 15 to C 250



**MEADRAIN PG 3000**

Clear width: 300 mm  
Height: 50 mm  
Length: 1000 mm

- > Flat channel made of polymer concrete with comb profile
- > With integrated sealing fold
- > Loading class A 15 to C 250





## MEADRAIN PG HIGH RESISTANCE FLAT CHANNEL

The MEADRAIN PG drainage channel provides a simple, discreet and efficient solution for multi-storey car park drainage. The low total height of the PG drainage channel enables facilitated installation. The PG is also very easy to clean because there are no cover gratings to be removed. MEADRAIN PG drainage channels are made from MEA polymer concrete. This material is extremely resistant to chemical substances, oils and salt.

### ADVANTAGES

- > 50 mm construction heights
- > No grating or moveable parts
- > Sturdy and weather resistant
- > Loading Class C 250
- > Sealable according to DIN EN 1433
- > Smooth surface

# MEADRAIN PG ADVANTAGES

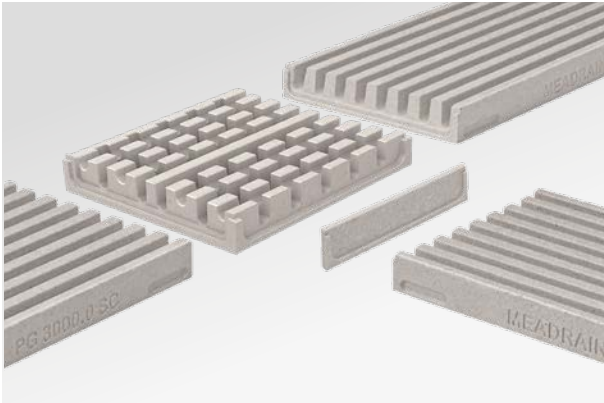

## End-to-end system solution

- > Architecturally striking drainage solution for multi-storey and underground car parks.
- > Suitable clear widths for different amounts of water (CW 100, 150 and 300 mm).
- > Wide range of accessories available: from cross/corner elements, end caps and outlet systems to corresponding sealants.

## Sealable

- > Norm-compliant (EN 1433) due to the easily accessible and inspectable sealing groove.
- > Easy to seal, as the sealing groove is fully accessible from the top, even after the installation.

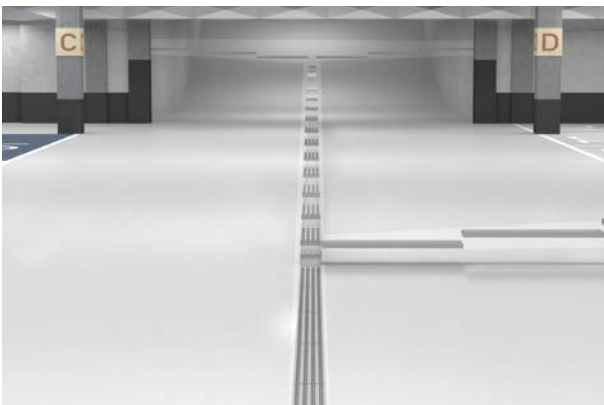
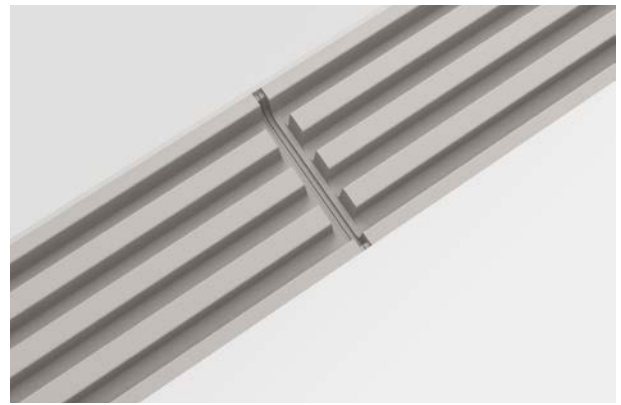

## Easy to install

- > Thanks to the low profile, it is possible to carry out lower storey ceiling thicknesses.
- > The system is also suitable for renovations. Due to its flat design, it can be applied regardless of the previously used system.

## Sturdy and secure

- > Extremely robust, as it is designed for highest loads.
- > Sustainable, thanks to the long-lasting polymer concrete material.
- > Vandal-proof and theft proof, due to the monolithic construction with no moving parts.



**Corrosion-free**

- > Resistant to salt\*, oil and fuel.
- > As the channel body is completely monolithic and from polymer concrete, there are no metal parts that are vulnerable to corrosion.
- > Thanks to the robust and rust-free material, it has a long-lasting appealing look.

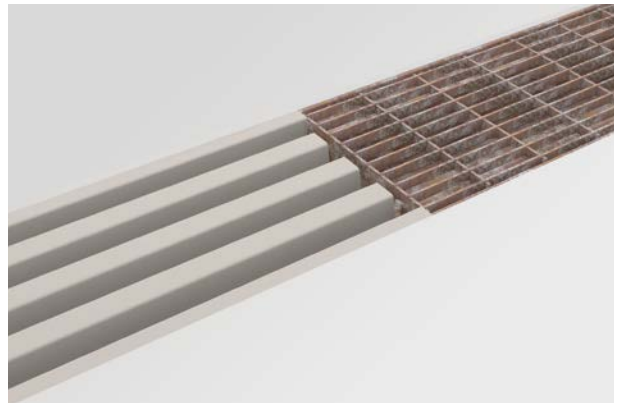
**Quiet**

- > Quiet, as the entire MEADRAIN PG system does not contain any moving parts.
- > No complaints about rattling gratings when crossed by vehicles.

**Barrier-free**

- > Wheelchair-accessible thanks to a maximum slot width of 16 mm.
- > No height difference between channel and adjacent surface.

**Easy to clean**

- > Can be visually checked for soiling, with no grating that needs to be removed in advance.
- > Thanks to its free cross-section, without gratings or crossbars, the channel can easily be cleaned with the corresponding cleaning shovel.
- > Easily accessible from the top.

\*Salt is highly aggressive to concrete. Especially in winter, de-icing salt transported by meltwater destroys slowly but surely the concrete reinforcement. The drainage system MEADRAIN PG from polymer concrete contributes to the long lifetime of your parking facility.

# MEADRAIN PG INSTALLATION

## MEADRAIN PG CAR PARK DRAINAGE CHANNEL – Installation in base plates with mastic asphalt 1-layer (40 mm)

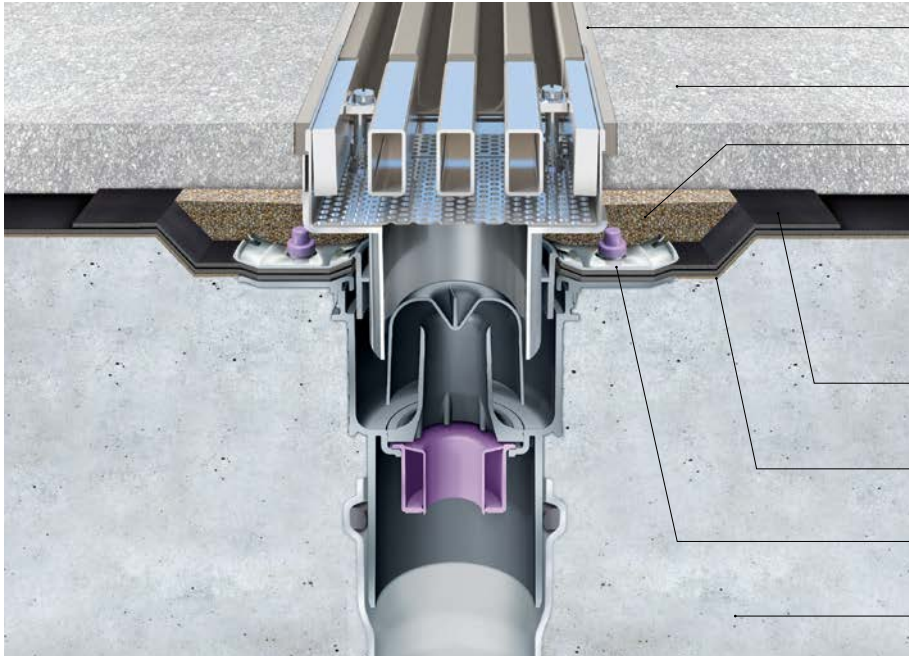

- Joint sealant
- Asphalt-Screed
- Gluing gutters and drains with PCC mortar \* (Flexural strength  $\geq 8 \text{ N / mm}^2$ )  
In dynamically loaded Areas epoxy resin mortar is to be used (Flexural strength  $\geq 30 \text{ N / mm}^2$ )
- Polymer bitumen sheeting with overlying reinforcement, in the area of the channel 2-layer
- Primer/sealing
- Pipe penetration with clamping flange
- Concrete ceiling

## MEADRAIN PG CAR PARK DRAINAGE CHANNEL – Installation in base plates with OS-floor coating

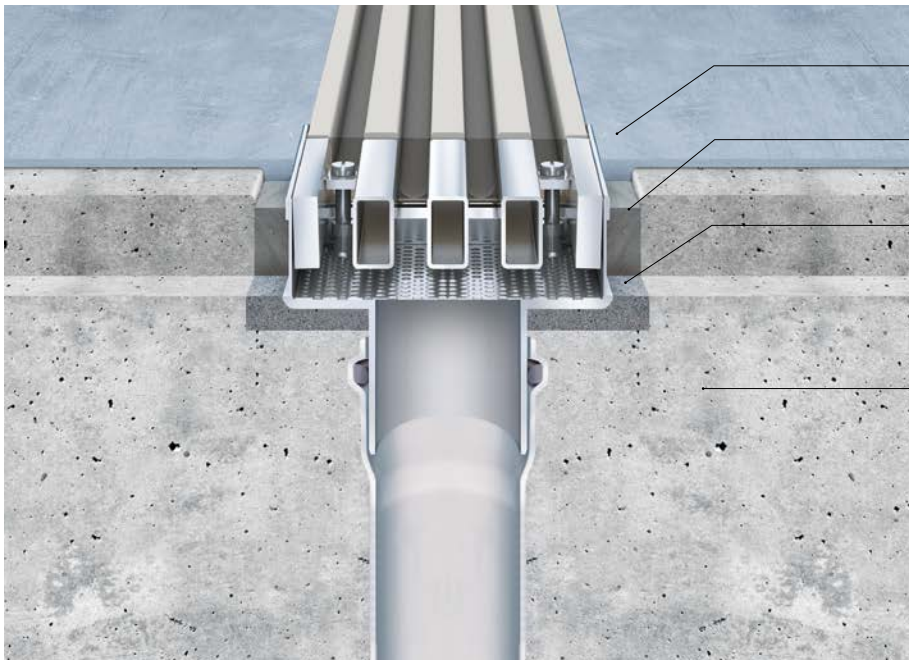

- OS Coating
- Non-shrink grouting mortar based on epoxy resin
- Gluing gutters and drains with PCC mortar with sanded Epoxy resin primer  
Drain/channel underside and Floor recess
- Concrete ceiling

For floors we recommend a installation with 2nd sealing level

\*Epoxy resin mortar (flexural strength  $\geq 30 \text{ N / mm}^2$ ) must be used in areas subject to dynamic loads and traffic. There is no need to prime the underside of the drain/channel.



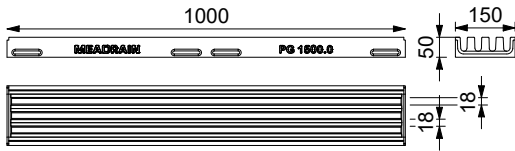

010155595

**Drainage channel body without slope without installation parts made of metal.** Loading classes A 15 to C 250 according to EN 1433

Product description	Length (mm)	Height (mm)	EDP Nr.	kg/unit
MEADRAIN PG 1000.0	1000	50	010155602	7,24
MEADRAIN PG 1500.0	1000	50	010155595	10,87
MEADRAIN PG 3000.0	1000	50	010155694	22,85

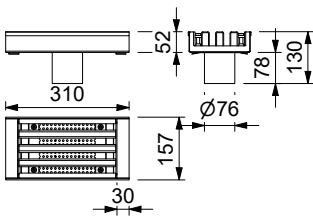

010155590

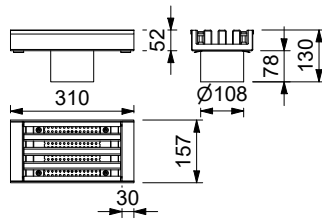

010155616

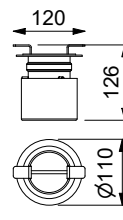

010141812

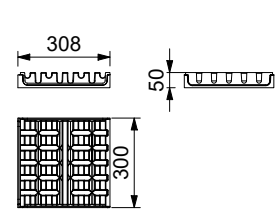

010155695

**MEADRAIN PG drain element V2A**

Product description	Length (mm)	Height (mm)	EDP Nr.	kg/unit
MEADRAIN PG 1000.EK made of V2A including cover and dirt filter, with pipe connection possibility $\varnothing$ 75mm	310	52/112	010155582	4,05
MEADRAIN PG 1500.EK made of V2A including cover and dirt filter, with pipe connection possibility $\varnothing$ 110mm	310	52/112	010155616	5,58
MEADRAIN PG 1500.EK made of V2A including cover and dirt filter, with pipe connection possibility $\varnothing$ 75 mm	310	52/112	010155590	5,27
MEADRAIN PG 3000.EK made of V2A including cover and dirt filter, with pipe connection possibility $\varnothing$ 110 mm	310	52 /112	010155618	8,98
MEADRAIN PG 3000.EK made of V2A including cover and dirt filter, with pipe connection possibility $\varnothing$ 75 mm	310	52/112	010155592	7,20
MEADRAIN PG 3000.K crossing element	300	50	010155695	6,51

**MEADRAIN PG Odour trap V2A**

Product description	Material	EDP Nr.	kg/unit
MEADRAIN PG Odour trap V2A, for PG 1500.EK V2A with pipe connection possibility $\varnothing$ 110 mm	Stainless steel	010141812	0,58

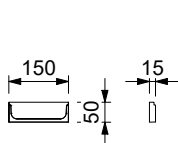

010155599

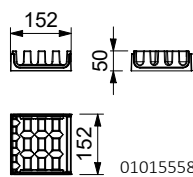

010155580

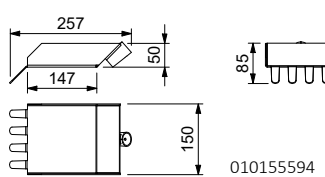

010155594

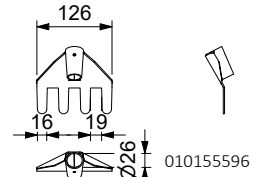

010155596

**MEADRAIN PG accessories**

Product description	Material	EDP Nr.	kg/unit
MEADRAIN PG 1000.SE end cap for channel start/end	Polymer concrete	010155606	0,15
MEADRAIN PG 1000.EK end cap for V2A drain element	Stainless steel	010155584	0,17
MEADRAIN PG 1500.SE end cap for channel start/end	Polymer concrete	010155599	0,20
MEADRAIN PG 1500.EK end cap for V2A drain element	Stainless steel	010155586	0,13
MEADRAIN PG 1500.K crossing element, ductile iron	Ductile iron	010155580	4,90
MEADRAIN PG 3000.SE end cap for channel start/end	Polymer concrete	010155696	0,38
MEADRAIN PG 3000.EK end cap V2A drain element	Stainless steel	010155588	0,26
MEADRAIN PG for cleaner of inverts <sup>1)</sup>	Stainless steel	010155596	0,21
MEADRAIN PG shovel for cleaning of surfaces <sup>1)</sup>	Stainless steel	010155594	0,87

<sup>1)</sup>not suitable for PG 1000



MULTI-STOREY CAR PARKS



CAR DEALERSHIPS

# MEADRAIN PG

## APPLICATION AREAS



PARKING DECKS



UNDERGROUND CAR PARKS



COVERED PARKING

# THE ADDITIONAL PRODUCT PORTFOLIO OF MEA WATER MANAGEMENT



**MEARIN PG EVO**

Drainage solution for multi-storey car parks



**MEATEC**

Professional drainage system for facades and terraces



**MEARIN**

Professional lightweight drainage system made of GRP



**MEADRAIN TRAFFIC**

Professional drainage systems for streets and motorways



**BUILDING SUCCESS**

MEA Bautechnik GmbH ■ Sudetenstraße 1 ■ D-86551 Aichach ■ [www.mea-group.com](http://www.mea-group.com)  
Business unit MEA Water Management